

Screw and Knob Adjust - 3/16" Internal Hex.

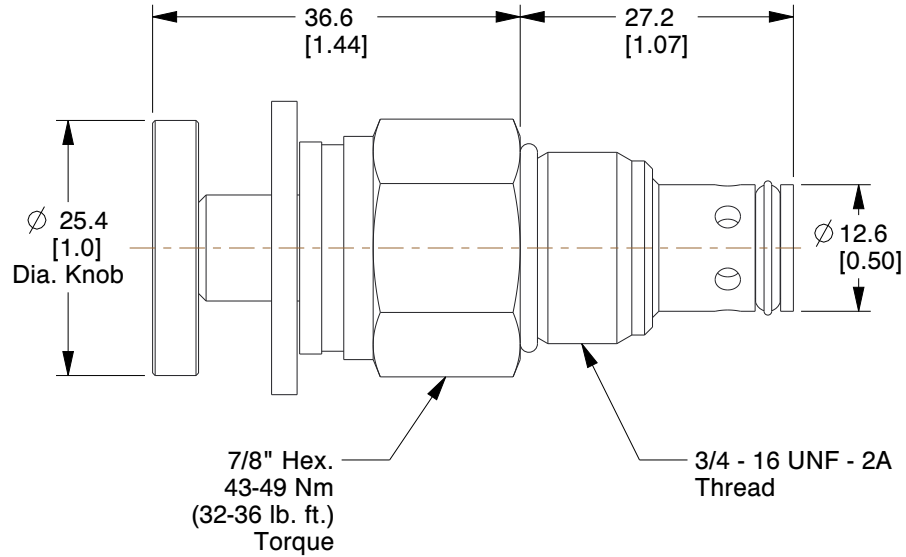

NOTES:

- ITEM: Cartridge Valve
- VALVE CAVITY SIZE: C08-2
- CARTRIDGE VALVE ITEM: Cartridge Valve
- MAX. FLOW - HYDRAULIC VALVES: 20.0 gpm
- MAX. PRESSURE - HYDRAULIC VALVES: 5000 psi
- CARTRIDGE VALVE TYPE: Pilot-Operated Relief
- APPLICATION: Used to Limit the Maximum Pressure in a System

COMPONENT		Hydraulic Cartridge Valves	
<h1>4DML8</h1>		UNIT	MM (INCH)
		SHEET	1 of 1
Cartridge Valve, PO Relief, 20 GPM			



100 Grainger Parkway, Lake Forest, Illinois 60045-5201
 1-(800) GRAINGER, 1-(800) 472-4643, (847) 535-1000
 www.grainger.com

This file and any associated information and specifications are provided for reference and evaluation purposes only, and is subject to change without notice. Grainger makes no representations, warranties or guarantees as to the appropriateness, accuracy, completeness, or suitability for any purpose, of the file, information or specifications. You are solely responsible for the use of the file, information or specifications.

This drawing is the property of GRAINGER. It contains confidential, proprietary information that is GRAINGER property. Do not disclose to or duplicate for others except as authorized by GRAINGER.

SCALE 1.33