

| | | | |
|---------------|---------------------|--------------------|----------|
| Item | Hydraulic Gear Pump | Ports (Outlet) | 1/2" NPT |
| Type | Two Stage | Mounting Flange | 4 Bolt |
| Rotation | Clockwise | Nominal Flow (GPM) | 13 |
| Input RPM | 4000 | Max. PSI 1st Stage | 3000 |
| Ports (Inlet) | 1" Tube | Max. PSI 2nd Stage | 900 |

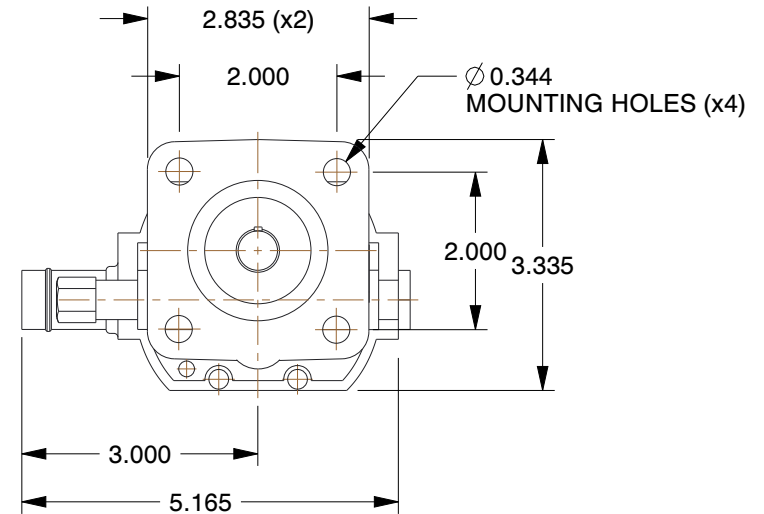
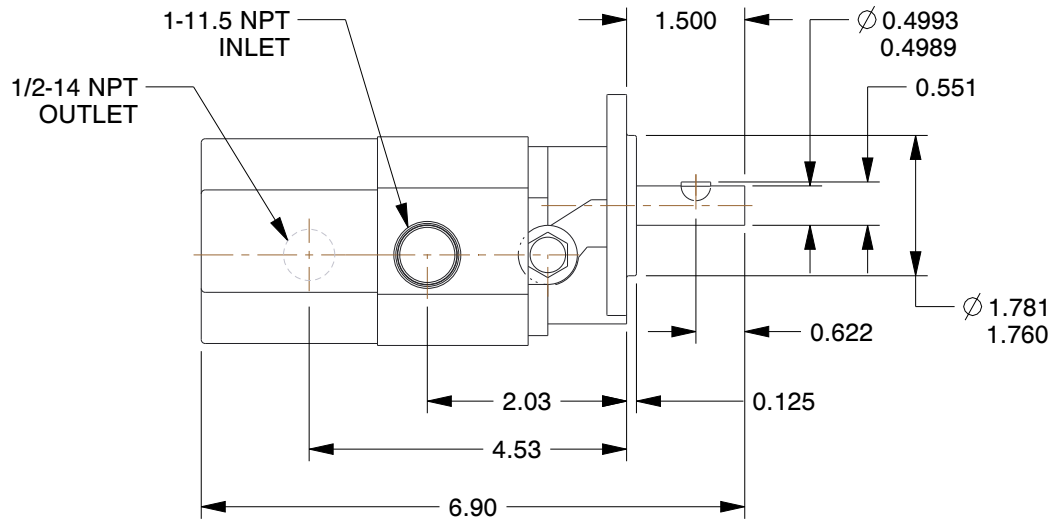

NOTES:

1. DRIVE: External
2. HP REQUIRED: 7
3. DRIVE SHAFT (IN.): 1/2
4. TRANSMISSION: 2 Stage
5. APPLICATION: For Use at Elevated Pressures
6. UNLOADING VALVE PRESET PRESSURE (PSI): 600 to 700
7. DISPLACEMENT @ HIGH PRESSURE (CUBIC INCHES/REV.): 0.219
8. DISPLACEMENT @ LOW PRESSURE (CUBIC INCHES/REV.): 0.537

| | |
|-----------|--------------------------------|
| COMPONENT | Hydraulic Two Stage Gear Pumps |
|-----------|--------------------------------|



100 Grainger Parkway, Lake Forest, Illinois 60045-5201
1-(800) GRAINGER, 1-(800) 472-4643, (847) 535-1000
www.grainger.com

This file and any associated information and specifications are provided for reference and evaluation purposes only, and is subject to change without notice. Grainger makes no representations, warranties or guarantees as to the appropriateness, accuracy, completeness, or suitability for any purpose, of the file, information or specifications. You are solely responsible for the use of the file, information or specifications.

This drawing is the property of GRAINGER. It contains confidential, proprietary information that is GRAINGER property. Do not disclose to or duplicate for others except as authorized by GRAINGER.

SCALE 0.41

46C518

Hydraulic Gear Pump, 13 GPM

UNIT

INCH

SHEET

1 of 1