

# L-SHAPED MOLDED DOCK BUMPER, L-1818-4

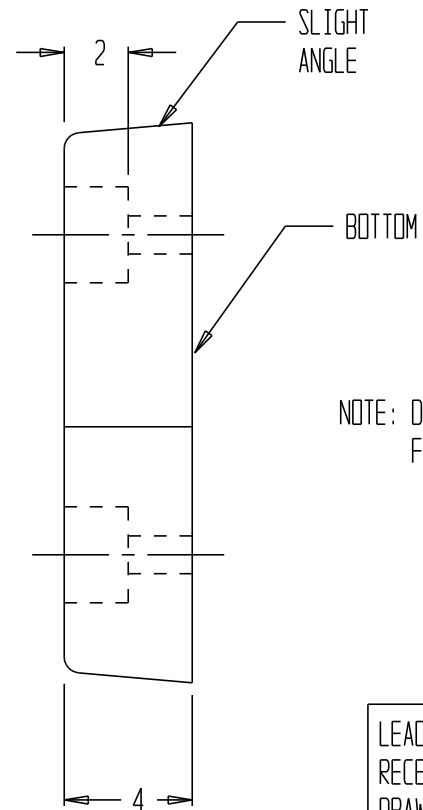
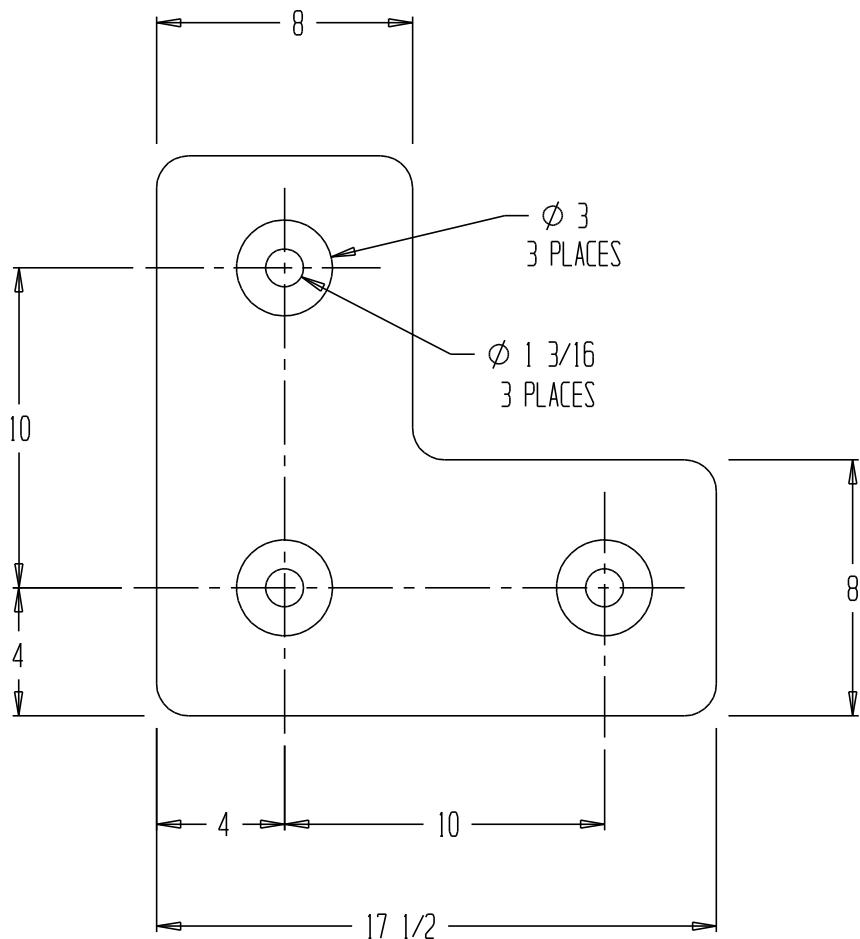

NOTE: DIMENSIONS ARE TAKEN FROM BOTTOM OF BUMPER

LEAD TIME WILL START UPON RECEIPT OF SIGNED APPROVAL DRAWING

## STANDARD FEATURES

MODEL NUMBER: L-1818-4  
 OVERALL LENGTH: 17 1/2"  
 OVERALL WIDTH: 17 1/2"  
 OVERALL PROJECTION: 4"

## SPECIAL FEATURES

NONE

## APPROVAL

I, the undersigned, hereby approve this print  
 As drawn     As marked

This includes my approval of design & dimensions.

Signed: \_\_\_\_\_

Date: \_\_\_\_\_

DISTRIBUTOR'S NAME: <b>VESTIL MANUFACTURING</b>		P.O.#: _
		W.O.#: _
DRAWN BY: SR	DATE: 4-22-05	SALES: _
REFERENCE: -		DRWG./FILE NAME: L-1818-4
		SCALE: 1:6

\*\*SPECIAL UNITS ARE NON-RETURNABLE  
 \*AVAILABLE AT ADDITIONAL COSTS