

CUSTOMER SPECIFICATION DRAWING

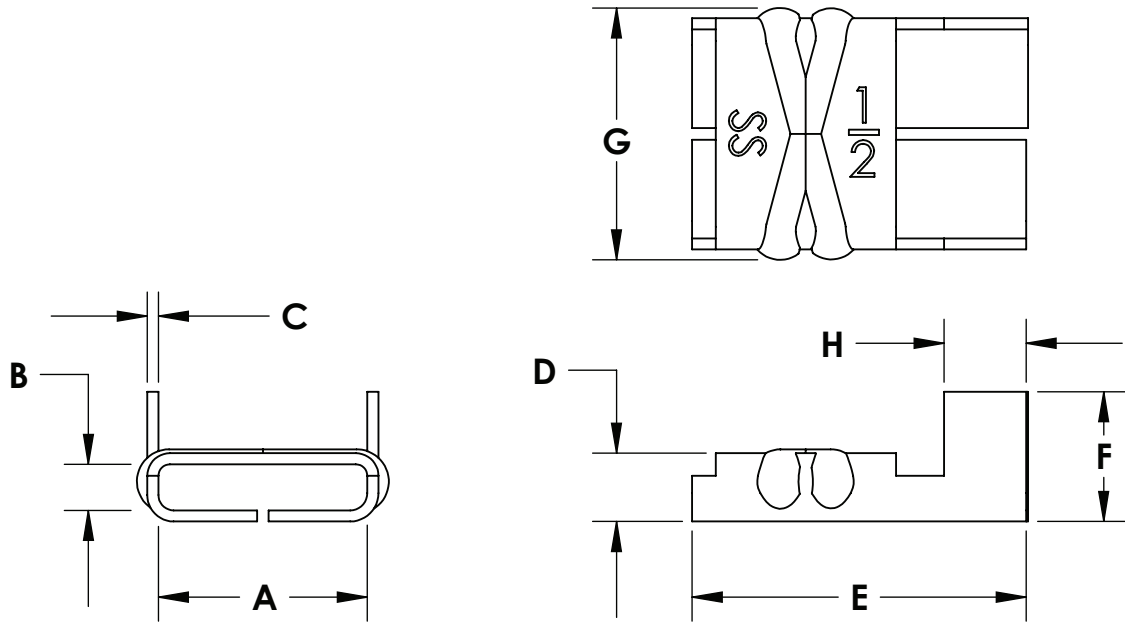

PART NUMBER	A	B	C	D ±.02	E ±.005	F	G ±.02	H ±.02	QTY PER BOX	WEIGHT PER BOX [LBS.]
GRC153	.406/.431	.095/.115	.030±.002	.18	.625	.275/.335	.49	.13	50	.29
GRC154	.540/.565	.110/.130	.030±.002	.19	.875	.371/.411	.63	.22	50	.50
GRC155	.670/.695	.095/.115	.030±.002	.19	.875	.42±.02	.77	.22	50	.59
GRC156	.790/.812	.110/.135	.044±.003	.22	.875	.505/.545	.90	.22	50	1.01

NOTES:

1. MATERIAL: 200/300 STAINLESS STEEL PER BAND-IT SPECIFICATION.
2. GRC154 VALUCLIP SHOWN.
3. DIMENSIONS & TOLERANCES SHOWN ARE IN INCHES.

BAND-IT®

A unit of ~~IDEX~~ Corporation
P.O. Box 16307
Denver, Colorado U.S.A.

PROPRIETARY AND CONFIDENTIAL

THIS DRAWING WITH ALL CONTENTS IS PROPERTY OF BAND-IT-IDEX, INC. REPRODUCTION, DISCLOSURE OR MFG. OF MATTER SHOWN IS PROHIBITED WITHOUT WRITTEN PERMISSION. DO NOT SCALE DRAWING. UNLESS OTHERWISE NOTED, DIMENSIONS ARE IN INCHES AFTER FINISH.

TITLE:

**VALUCLIP, BOXED,
GRAINGER**

DWG. NO.

GRC15

REV A