

Thomas & Betts

***Fewer Parts, Less Installation Time
and Huge Labor Savings!***

Kindorf[®]

Trapnut™ Strut Fastener



Trapnut™ Strut Fastener

Features and Benefits

The unique scissor action of the Trapnut™ Strut Fastener closes at any desired position on the threaded rod. Once closed, precision threads trap the threaded rod for a sturdy hold that can be adjusted up or down for fine-tune positioning. While the versatile Trapnut™ has a locking pin that holds it in the desired position, it can also be removed and reused.

Unlike a Hex Nut, there is no need to thread the Trapnut™ from either end of the rod, saving valuable time on the job. While the Trapnut™ Strut Fastener is a time-saver for new construction, it is invaluable for retro-fit applications. Rather than disassembling an existing trapeze to run additional conduit above it, Trapnut™ can be clamped between the existing trapeze and the beam clamp for a speedy retro-fit solution. It's ideal for applications where the rod ends are not accessible.

Trapnut™ has a sturdy steel construction that is load bearing, so you can be confident of a solid installation. And, Trapnut™ functions as a Hex Nut, square washer and flat washer combined, so there are fewer parts to keep up with on the job.



H 122 3/8 EG Trapnut™ Strut Fastener SilverGalv™

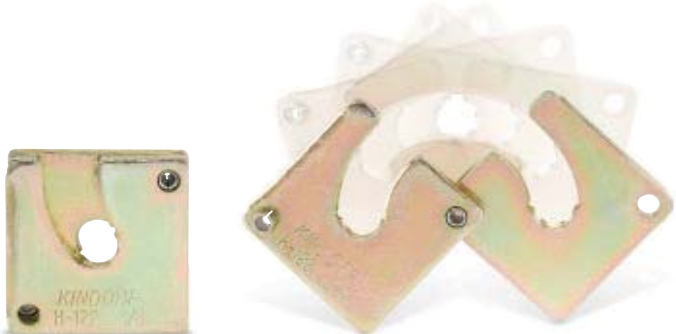

H 122 3/8 Trapnut™ Strut Fastener Galvkrom™

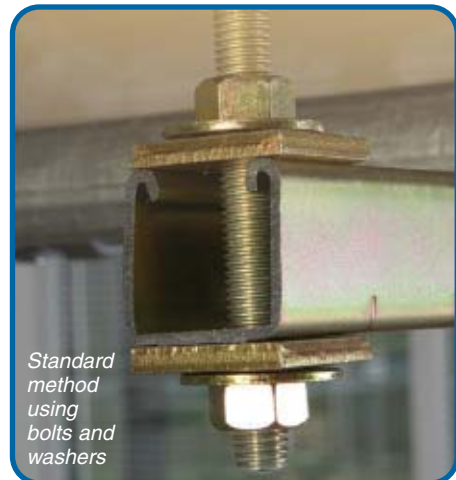

Takes 30% less time on New Work applications, and 43% less time on Retro-Fit applications.*

*See time study results on back page.

Easy to Install

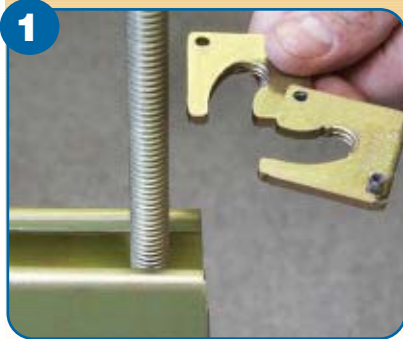

Hold in the open position.

- No need to thread Trapnut™ from either end of the rod — saving valuable time
- Perfect for retro-fit applications where the rod ends are not accessible



Insert the bottom plate on the rod and close the top plate.

- Precision threads trap the threaded rod for a sturdy hold that can be adjusted up or down for fine-tune positioning
- Functions as a hex nut, square washer, and flat washer combined

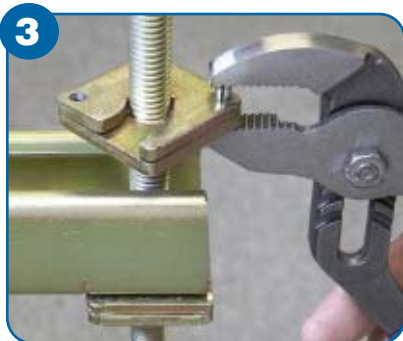

Press the pin with pliers.

- Locking pin holds it in the desired position
- Can be removed and reused

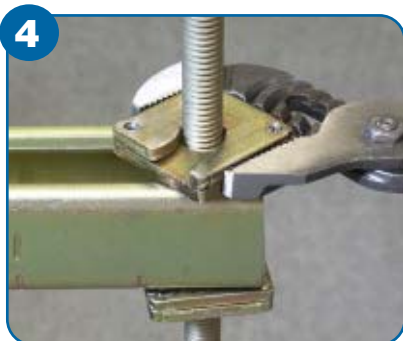

Tighten to the desired position with pliers.

- Can be adjusted up or down for fine-tune positioning
- Sturdy steel construction that is load bearing

Trapnut™ Strut Fastener

Time Study

To demonstrate the labor-savings properties of the NEW Trapnut™ Strut Fastener, Thomas & Betts hired two electricians to run 15 feet of 2-inch Thinwall Conduit/EMT supported by typical trapeze assemblies. First they used standard washers and nuts, and then they used the NEW Trapnut™ Strut Fastener in both new work and retro-fit applications. See the results for yourself... **fewer parts, less installation time and huge labor savings!**



Standard installation requires manual threading of bolt on threaded rod.



The unique scissor action of the Trapnut™ allows it to be positioned anywhere on the threaded rod.

New Work—Typical Trapeze Assembly*

	Using Standard Nuts/Washers	Using the NEW Trapnut™	30% Less Time with Trapnut™!
Material Cost	\$128.17	\$135.45	
Labor Cost***	\$1,658	\$1,160	
Installation Time	16 min., 35 sec.	11 min., 36 sec.	

Based on the Time Study, a job with 100' of EMT and 10 trapeze assemblies would be a saving of **\$2,490 with Trapnut™!**

Standard Nuts/Washers Materials:	Trapnut Materials:
4 Steel City® Beam Clamps (1/2")	4 Steel City® Beam Clamps (1/2")
4 Kindorf® Threaded Rods (1/2" X 3')	4 Kindorf® Threaded Rods (1/2" X 3')
2 Kindorf® Strut (1 1/2" X 2 1/2")	2 Kindorf® Strut (1 1/2" X 2 1/2")
2 Thinwall Conduit/EMT (2" X 15')	2 Thinwall Conduit/EMT (2" X 15')
4 Kindorf® Conduit Clamps (2")	4 Kindorf® Conduit Clamps (2")
8 Kindorf® Hex Nuts (1/2")	4 Kindorf® Trapnut Strut Fasteners (1/2")
4 Kindorf® Square Washers (1/2")	
4 Kindorf® Round Washers (1/2")	

Fewer Parts with Trapnut™!

Retro-Fit—Typical Trapeze Assembly**

	Using Standard Nuts/Washers	Using the NEW Trapnut™	43% Less Time with Trapnut™!
Material Cost	\$87.50	\$94.78	
Labor Cost***	\$2,012	\$1,140	
Installation Time	20 min., 7 sec.	11 min., 24 sec.	

Based on the Time Study, a job with 100' of EMT and 10 trapeze assemblies would be a saving of **\$4,360 with Trapnut™!**

Standard Nuts/Washers Materials:	Trapnut Materials:
2 Kindorf® Strut (1 1/2" X 2 1/2")	2 Kindorf® Strut (1 1/2" X 2 1/2")
2 Thinwall Conduit/EMT (2" X 15')	2 Thinwall Conduit/EMT (2" X 15')
4 Kindorf® Conduit Clamps (2")	4 Kindorf® Conduit Clamps (2")
8 Kindorf® Hex Nuts (1/2")	4 Kindorf® Trapnut Strut Fasteners (1/2")
4 Kindorf® Square Washers (1/2")	
4 Kindorf® Round Washers (1/2")	

Fewer Parts with Trapnut™!

*Running 15' of 2" Thinwall Conduit/EMT, and 2 trapeze assemblies.

**Running 15' of 2" Thinwall Conduit/EMT, and 2 trapeze assemblies above an existing assembly.

***Based on an average labor cost of \$50 per hour for 2 electricians.

Trapnut™ Strut Fasteners

Cat. Number	Description	Size	Design Load Lbs.	UPC Number	Std. Ctn.
H 122 1/4	Trapnut™ Strut Fastener 1/4" Galvkrom	1/4"	150	785991-04423	50
H 122 3/8	Trapnut™ Strut Fastener 3/8" Galvkrom	3/8"	590	785991-04422	50
H 122 1/2	Trapnut™ Strut Fastener 1/2" Galvkrom	1/2"	1,080	785991-04421	50
H 122 1/4 EG	Trapnut™ Strut Fastener 1/4" SilverGalv	1/4"	150	785991-04420	50
H 122 3/8 EG	Trapnut™ Strut Fastener 3/8" SilverGalv	3/8"	590	785991-04419	50
H 122 1/2 EG	Trapnut™ Strut Fastener 1/2" SilverGalv	1/2"	1,080	785991-04418	50
H 122 1/4 SS316	Trapnut™ Strut Fastener 1/4" Type 316 Stainless Steel	1/4"	150	785991-04417	50
H 122 3/8 SS316	Trapnut™ Strut Fastener 3/8" Type 316 Stainless Steel	3/8"	590	785991-04416	50
H 122 1/2 SS316	Trapnut™ Strut Fastener 1/2" Type 316 Stainless Steel	1/2"	1,080	785991-04415	50

www.tnb.com

Thomas & Betts

Please ask your Thomas & Betts sales representative for a complete catalog of quality Thomas & Betts electrical products or visit us at www.tnb.com. For customer service, call 1-800-816-7809. For technical questions, call 1-888-862-3289.

Thomas & Betts Corporation
Electrical Division
8155 T&B Boulevard
Memphis, TN 38125
901-252-5000

Thomas & Betts Ltd.
700 Thomas Avenue
Iberville, Québec J2X 2M9
450-347-5318