

Specified for use with all Storm AXS access control systems this integrated device provides a means of emergency escape through an access controlled (secured) exit door. Breaking the glass panel permanently releases an electrically operated fail-safe door lock .

Includes integral piezo siren and second relay for Alarm Activation, plus spare glass

### Installation

- Fits into a standard USA double gang wall box with mud ring
- Wall box / screws not included – compatible boxes listed on next page.
- Make the electrical connections using a connector block
- Fold down the front of the unit (use the included 2.5mm hex key)
- Secure the case to the wall box with 2 screws
- Power up and test, then fold up the front and secure

| Wiring Connections |         |         |
|--------------------|---------|---------|
| Orange             | Relay 1 | NO      |
| White              |         | + Volts |
| Yellow             |         | NC      |
| Orange             | Relay 2 | NO      |
| White              |         | + Volts |
| Yellow             |         | NC      |
| Red                | Piezo   | + Volts |
| Black              | Siren   | 0 Volts |

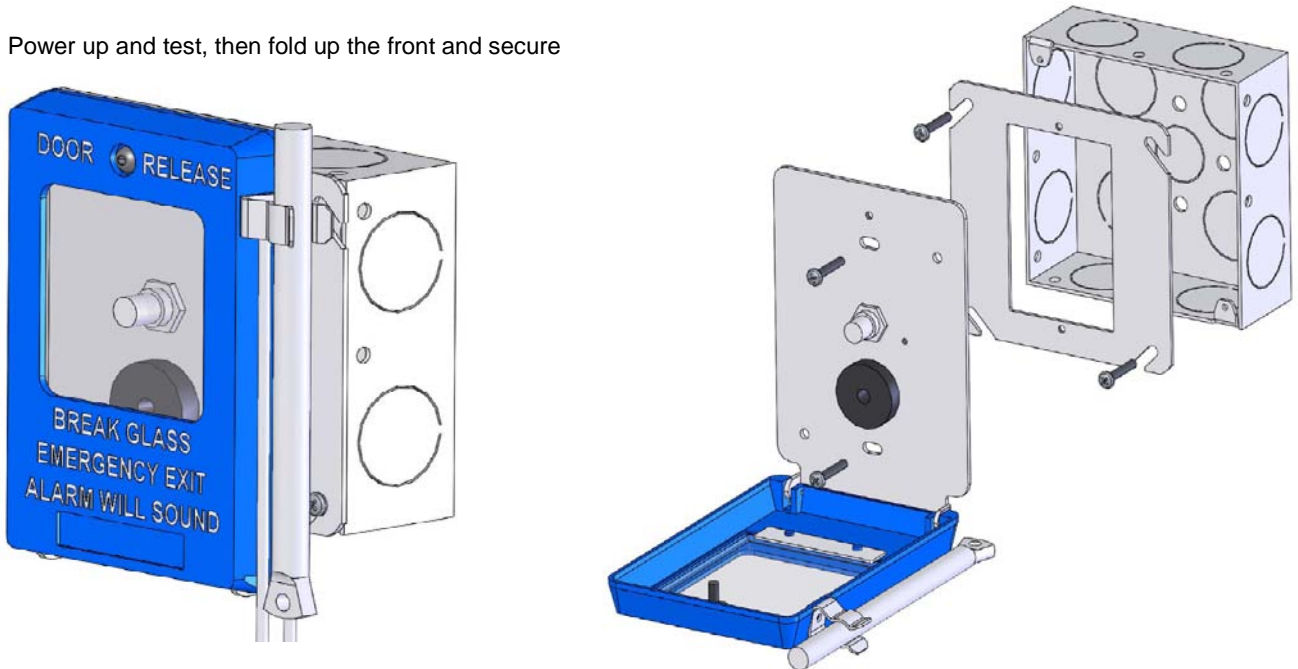

### DEEM010 Request to Exit Switch

Relay Rating **3-28 V DC ,10A (max)**  
 Piezo Sounder Rating **3-28 V DC ,20mA (max)**

Approvals **CE**  
 Packed Size **165 x115 x 60mm, 700g**

### Order Codes for AXS Accessories

#### MAG LOCKS

DEL600 Door Lock 600 lbs with brackets  
 DEL1200 Door Lock 1200 lbs with brackets  
 DEGL1200 Gate Lock 1200 lbs with brackets

#### PSU

DEPSU03 Power Supply in Wall Box, 120V, 6A/12V o/p

#### SWITCHES

DEEX010 Request to Exit Switch (IR)  
 DEEM010 Emergency Override Switch with Siren

Document Ref :

**DE-EM01-08KT**  
 Rev 1 July 2014  
 Page 1 of 2

Whilst every effort is made to ensure details are correct at time of print, specifications are subject to change without notice

Storm Interface products include technology protected by international patents and design registration. All rights reserved.

Storm is a trademark of Keymat Technology Ltd  
 Storm Interface is a trading name of Keymat Technology Ltd



### Wiring Diagram for Door with Siren

- Use Relay 1 for a Normally Closed Door – if you break the glass the door is opened
- Connect the piezo in series – the siren will sound if the glass is broken

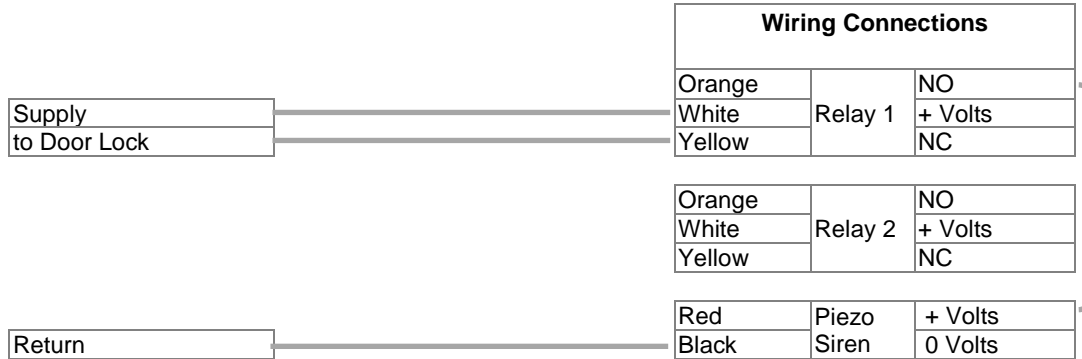

### Wiring Diagram for Door with Additional Alarm Monitoring

- Use Relay 1 for a Normally Closed Door - if you break the glass the door is opened
- Connect the piezo in series – the siren will sound if the glass is broken
- Use Relay 2 to activate separate external Alarm when glass is broken.

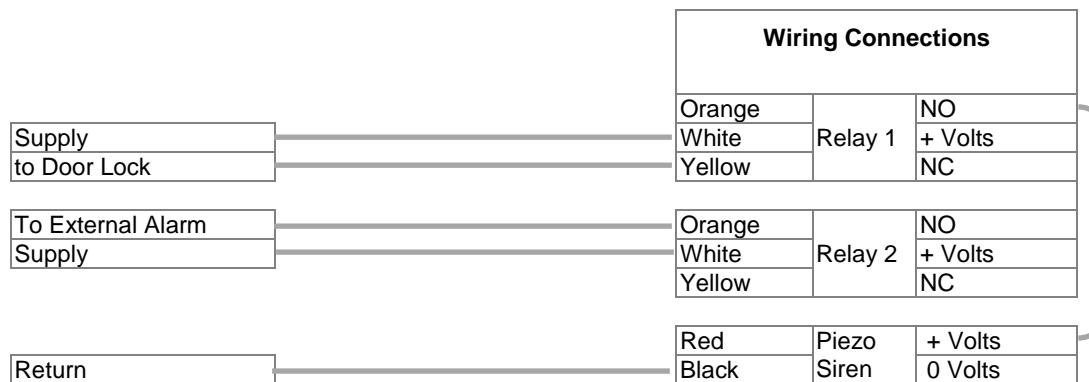

### Wall Boxes

For flush fixing use double wall box either      Raco #190      ( order from Grainger #SA050)  
Raco #192      ( order from Grainger #SA051)

Use 4" mud ring either      Raco #786  
Raco #787

Use 2 off 6-32 UNC x 3/4 " Pan Head Phillips Screw ( Grainger #1MU16 PK100) to fix the case to the mud ring.

For surface fixing use EBG Back Box – details on request.

