

Contact Replacement Kits, Class 9998 Types DRC5 and DRC6 For 50 A and 60 A Definite Purpose Contactors, Class 8910 Type DPA

Retain for future use.

⚠ DANGER

HAZARD OF ELECTRIC SHOCK, EXPLOSION, OR ARC FLASH

Disconnect all power before working on equipment.

Failure to follow these instructions will result in death or serious injury.

⚠ CAUTION

EQUIPMENT DAMAGE

Mount on a vertical surface for proper mounting and assembly. If disassembled, refer to the diagram for proper parts installation, base-to-coil orientation, and screw torques.

Failure to follow these instructions can result in injury or equipment damage.

Table 1: Contact Replacement Kits

Amperage	Class	Type
50 A	9998	DRC5
60 A	9998	DRC6

Each kit contains two (2) stationary contacts, one (1) moveable contact, one (1) contact spring, and two (2) contact screws.

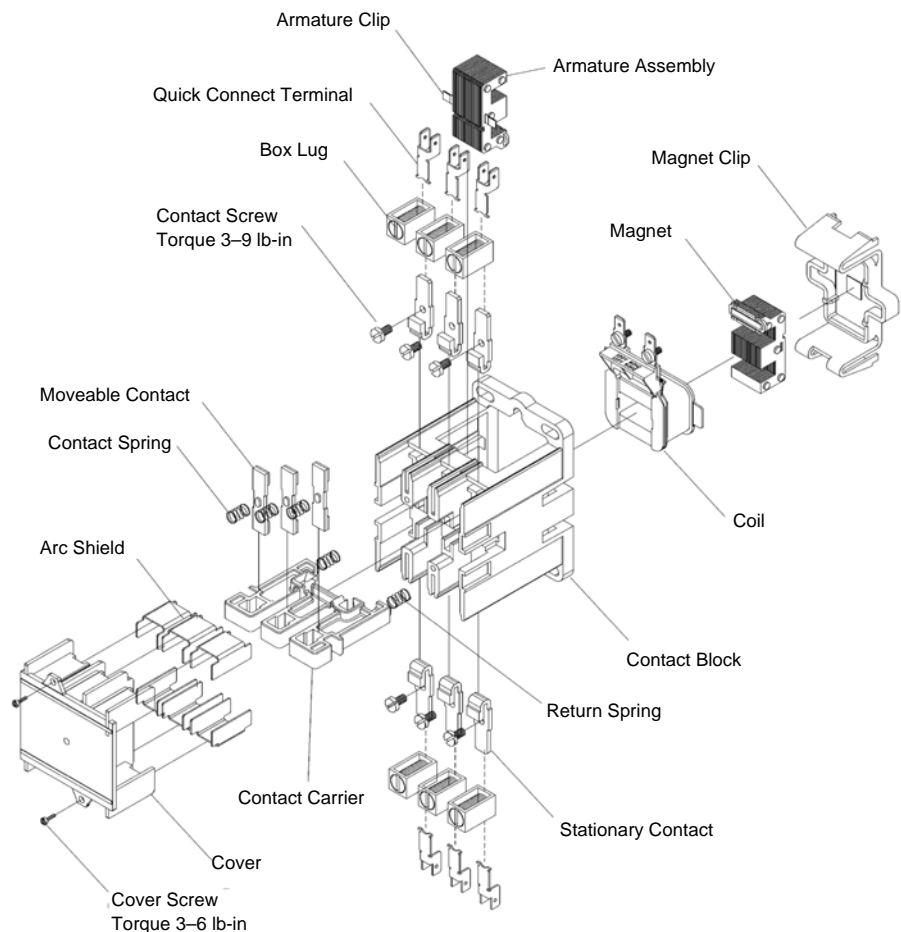

Schneider Electric
8001 Knightdale Blvd.
Knightdale, NC 27545 USA
1-888-SquareD (1-888-778-2733)
www.schneider-electric.us

Electrical equipment should be installed, operated, serviced, and maintained only by qualified personnel. No responsibility is assumed by Schneider Electric for any consequences arising out of the use of this material.

© 2010 Schneider Electric All Rights Reserved