

LDTX Large Diameter Tapcon

SELF-THREADING ANCHOR

Greater Versatility with EnvireX[™] Corrosion Resistant Coating

Applications

- Windows
- Railings – safety and decorative
- Fences – safety and decorative
- Screened porch and pool enclosures

Product Features and Benefits

Fast installation:

- Installs in less than half the time of wedge or adhesive anchors
- Simply drill a pilot hole with a standard bit and drive with a socket or impact wrench (some sizes can be installed by hand in both hollow and grout-filled concrete block)
- Dramatically reduces installation labor

Easily Removed:

- No torching or grinding required to remove anchors
- Easy replacement lowers jobsite costs
- Re-usable (in same hole only)

Finished Head:

- Anti-rotation serrations on the washer prevent backout
- The head of each anchor is stamped with a length identification code for easy inspection
- Provides a clean, finished look and reduces tripping hazards



Corrosion Resistance

- *withstands a minimum of 1,000 hours salt spray per ASTM B117*
- *not susceptible to HISC (Hydrogen induced stress cracking)*
- *approved for use with ACQ and MCQ lumber**

LDTX vs. 410 Stainless Steel (SS)

	LDTX	410 SS LDT
Hours passed of Salt Spray	1,000	104
Cost Savings	Over 50% less cost than 410 SS	Higher cost than LDTX

*Excessive content of copper in the ACQ and MCQ lumber may affect the anchor finish.

LDTX Large Diameter Tapcon

SELF-THREADING ANCHOR



Product Specifications

Diameter: 3/8" and 1/2"
 Thread Form: Hi-Lo®
 Material: Case Hardened AISI 1022 carbon steel
 Head Style: Finished hex washer head

New RED HEAD **EnvireX**™ coating!

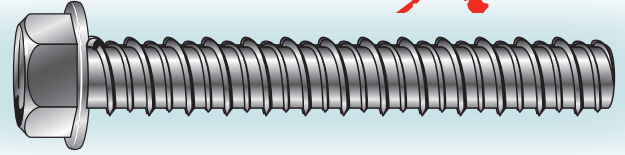

Easy two-step installation

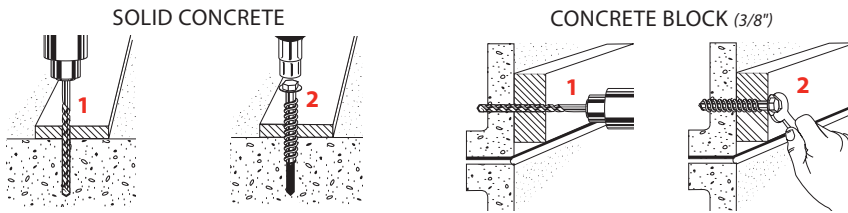

Length Indication Code*

CODE	LENGTH OF ANCHOR	
	in.	(mm)
D	3 < 3-1/2	(76.2 < 88.9)
F	4 < 4-1/2	(101.6 < 114.3)
H	5 < 5-1/2	(127.0 < 139.7)

*Located on top of anchor for easy inspection.

Performance Table

Normal Weight Concrete

Ultimate† Shear and Tension Values (Lbs/kN)

ANCHOR DIAMETER	EMBEDMENT DEPTH	2000 PSI (13.8 MPa)		4000 PSI (27.6 MPa)		6000 PSI (41.4 MPa)	
		TENSION	SHEAR	TENSION	SHEAR	TENSION	SHEAR
in. (mm)	in. (mm)	lbs. (kN)	lbs. (kN)	lbs. (kN)	lbs. (kN)	lbs. (kN)	lbs. (kN)
3/8 (9.5)	1-1/2 (38.1)	1,336 (5.9)	2,108 (9.4)	1,968 (8.8)	3,416 (15.2)	--	--
	2 (50.8)	1,492 (6.6)	3,036 (13.5)	2,552 (11.3)	3,420 (15.2)	--	--
	2-1/2 (63.5)	3,732 (16.6)	3,312 (14.7)	3,760 (16.7)	3,424 (15.2)	5,960 (26.5)	--
	3-1/2 (88.9)	5,396 (24.0)	3,312 (14.7)	7,852 (34.9)	3,428 (15.2)	--	--
1/2 (12.7)	2 (50.8)	3,580 (15.9)	5,644 (25.1)	4,236 (18.8)	7,380 (32.8)	--	--
	3-1/2 (88.9)	7,252 (32.3)	6,436 (28.6)	8,836 (39.3)	8,140 (36.2)	14,127 (62.8)	--
	4-1/2 (114.3)	10,176 (45.3)	7,384 (32.8)	10,488 (46.7)	8,552 (38.0)	--	--

†Allowable load should not exceed 25% of ultimate load values.



Selection Chart

LDT Carbon Steel with Envirex coating

PART NUMBER	ANCHOR DIAMETER		SOCKET SIZE	DRILL BIT DIAMETER		EFFECTIVE LENGTH	MAX. THICKNESS OF MATERIAL TO BE FASTENED		QTY/WT PER BOX	QTY/WT PER MASTER CARTON
	in.	(mm)		in.	(mm)		in.	(mm)		
LDT-3830X	3/8	(9.5)	9/16	5/16	(7.9)	3	1-1/2	(38.1)	50 / 5.0	400 / 40.0
LDT-3840X	3/8	(9.5)		5/16	(7.9)	4	2-1/2	(63.5)	50 / 6.5	400 / 52.0
LDT-3850X	3/8	(9.5)		5/16	(7.9)	5	3-1/2	(89.0)	40 / 7.5	320 / 60.0
LDT-1230X	1/2	(12.7)	3/4	7/16	(11.1)	3	1/2	(12.7)	25 / 4.5	150 / 27.0
LDT-1240X	1/2	(12.7)		7/16	(11.1)	4	1-1/2	(38.1)	25 / 6.0	150 / 36.6
LDT-1250X	1/2	(12.7)		7/16	(11.1)	5	2-1/2	(63.5)	25 / 7.6	150 / 45.6



X denotes the corrosion resistant LDTX



© 2010 Illinois Tool Works.
 Red Head is a registered trademark of Illinois Tool Works Inc.
 RH012 10/08

Because applications vary, ITW Red Head cannot guarantee the performance of this product. Each customer assumes all responsibility and risk for the use of this product. The safe handling and the suitability of this product for use is the sole responsibility of the customer. Specific job site conditions should be considered when selecting the proper product. Should you have any questions, please call the Technical Assistance Department at 800-899-7890.

ITW Red Head
 800-899-7890
 www.itwredhead.com
 2171 Executive Drive, Suite 100
 Addison, IL 60101