

PANDUIT® Hinged Cover Wiring Duct

PANDUIT innovative dual-sided hinged wiring duct delivers improved wire management and aesthetics for electrical control panel and communication applications. The unique push-on hinged cover is easier to install and remove than traditional wiring duct covers and once installed can be opened from either side of the duct. Hinged cover wiring duct provides faster access to wiring, prevents cover loss, reduces maintenance costs and promotes safety.

Type HN hinged cover wiring duct features a narrow slot design for high-density applications.

Type H hinged cover wiring duct features a wide slot design for general purpose use.

Type HS solid wall raceway contains cables and cord sets for surface mount routing applications.

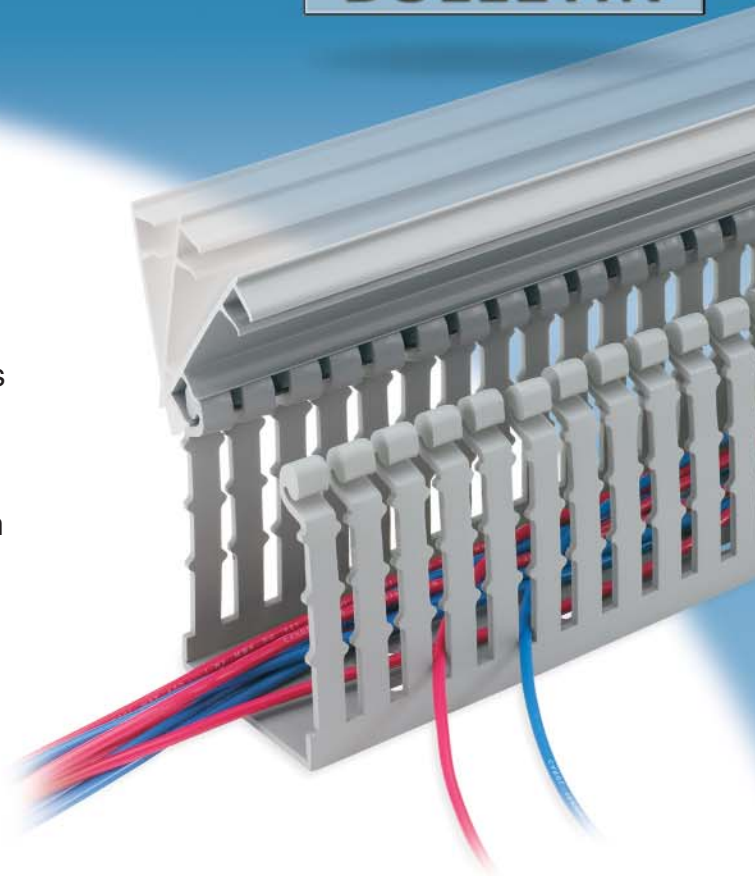

Type HN Narrow Slot Wiring Duct



Key Features

Benefits

Type HN narrow slots and fingers

Delivers optimal alignment between slots and termination points in high density electrical applications; multiple slot restrictors hold wiring at the device termination point to reduce installation time and improve wire label identification

Type H wide slots and fingers

Provides flexibility by allowing use with a variety of wire sizes in electrical and communication applications

Type HS solid wall raceway

Fully encloses cables and cord sets for maximum protection in on-machine applications that do not require frequent breakouts

Integrated hinged cover design

Retains cover during maintenance for **up to 20% faster** wiring changes and reduced labor costs; prevents lost covers for a neater panel appearance

Dual-sided hinge

Cover hinges open **up to 100°** from either sidewall of duct for easier wire access during maintenance, to reduce labor costs

Cover retention flange

Saves time with simple **push-on cover installation**; full engagement between cover and base results in **cover retention up to 2 times greater** than conventional wiring ducts; prevents cover slip when exposed to vibration

Cover removal tab

Provides gripping surface to ease cover opening or removal to reduce labor costs during wire installation or maintenance

Control Panel Application

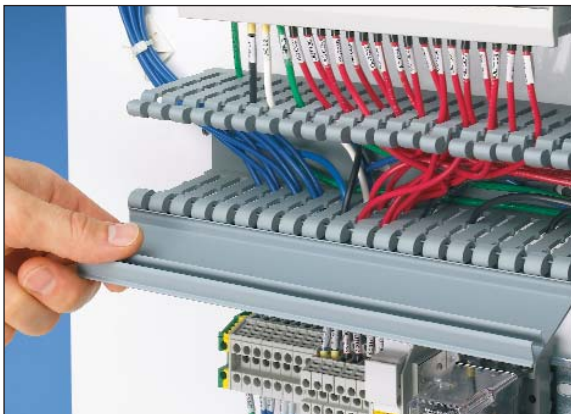

- Frequent moves, adds, changes or equipment upgrades require repeated, easy, and quick access to duct channel

Communication Application



- High visibility and high traffic areas require a neat appearance

Labor Savings

- By eliminating the time involved in removing and replacing covers with hinged cover wiring duct, simple wiring changes can be made up to 20% faster compared to conventional wiring duct installations*

Prevent Cover Replacement Costs

- Covers represent 20% of the cost of the wiring duct purchase
- Misplaced covers are a common occurrence after years of use
- Hinged cover wiring duct eliminates lost covers

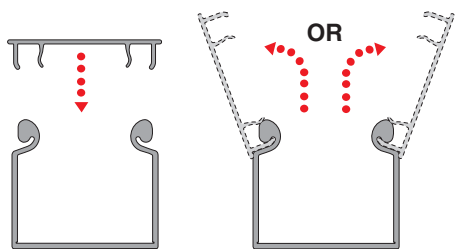
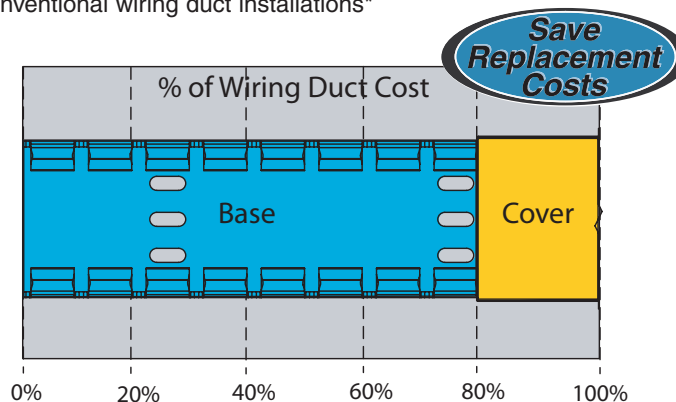

Ease of Installation and Access

- Cover retention flanges guide duct fingers into cover for simple **push-on cover installation**
- Cover hinges open to 100° from either sidewall to allow full channel access

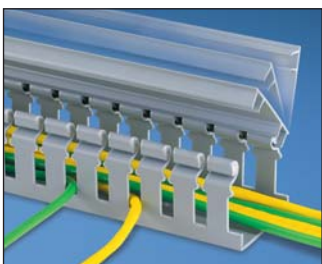

Durability and Performance

- Cover fully engages fingers limiting sidewall flex for greater rigidity and durability*
- **Cover retention is up to 2 times greater** than conventional wiring ducts**

*Based on mock panel installations of Type H Hinged Cover Wiring Duct and other commonly available wiring ducts adding a single component with four wires.

**Based on test and measurements comparing Type H Hinged Cover Wiring Duct to other commonly available wiring ducts.

Ordering Information

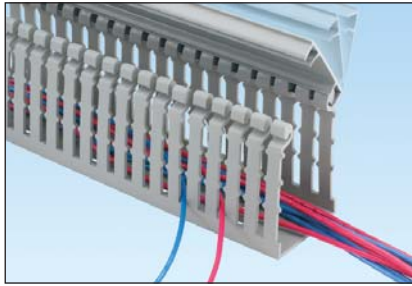

Type HN: Narrow Slot

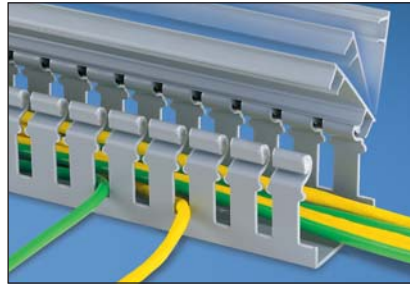

Type H: Wide Slot

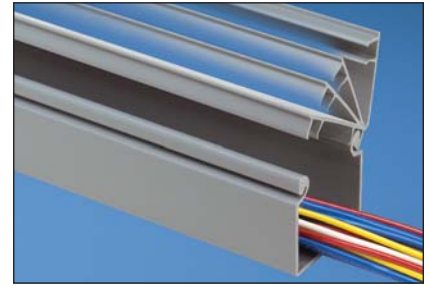

Type HS: Solid Wall

Type HN Duct Part Numbers	Type H Duct Part Numbers	Type HS Duct Part Numbers	Duct Nominal Size		Cover Part Numbers	Standard Carton Quantity	
			W X H (inches)	W X H (mm)		Duct (Ft.)	Cover (Ft.)
HN1.5X2LG6	H1.5X2LG6	HS1.5X2LG6NM	1.5 x 2.0	37 x 50	HC1.5LG6	120	120
HN1.5X3LG6	H1.5X3LG6	HS1.5X3LG6NM	1.5 x 3.0	37 x 75	HC1.5LG6	120	120
HN2X2LG6	H2X2LG6	HS2X2LG6NM	2.0 x 2.0	50 x 50	HC2LG6	120	120
HN2X3LG6	H2X3LG6	HS2X3LG6NM	2.0 x 3.0	50 x 75	HC2LG6	60	120
HN2X4LG6	H2X4LG6	HS2X4LG6NM	2.0 x 4.0	50 x 100	HC2LG6	60	120
HN3X3LG6	H3X3LG6	HS3X3LG6NM	3.0 x 3.0	75 x 75	HC3LG6	60	120
HN3X4LG6	H3X4LG6	HS3X4LG6NM	3.0 x 4.0	75 x 100	HC3LG6	60	120
HN4X4LG6	H4X4LG6	HS4X4LG6NM	4.0 x 4.0	100 x 100	HC4LG6	60	60

Note: Base and cover are sold separately.
Product shown in LG (Light Gray). Type HN also available in WH (White), Type H and Type HS also available in BL (Black) and WH (White)

Technical Information

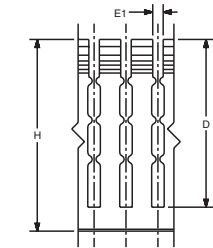
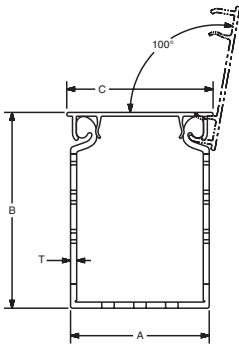

Type HN: Multiple slot restrictors present with 3" and greater duct wall height.

Type HN 2", 3" and 4" wide duct.

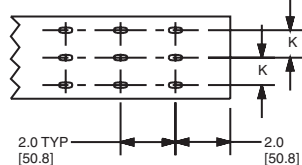

Duct Size (W x H)	Dimensions – Inches (mm)										
	A	B	C	D	E1	F1	E2	F2	H	K	T
1.5 x 2 (38.1) x (50.8)	1.75 (44.5)	1.98 (50.3)	1.88 (47.8)	1.63 (41.4)	0.20 (5.0)	0.50 (12.7)	0.31 (7.9)	.80 (20.3)	1.92 (48.8)	On CL	.08 (2.0)
1.5 x 3 (38.1) x (76.2)	1.75 (44.5)	3.06 (77.7)	1.88 (47.8)	2.63 (66.8)	0.20 (5.0)	0.50 (12.7)	0.31 (7.9)	1.00 (25.4)	3.00 (76.2)		.10 (2.5)
2 x 2 (50.8) x (50.8)	2.17 (55.1)	1.98 (50.3)	2.29 (58.2)	1.57 (39.9)	0.20 (5.0)	0.50 (12.7)	0.31 (7.9)	.80 (20.3)	1.92 (48.8)	.50 (12.7)	.08 (2.0)
2 x 3 (50.8) x (76.2)	2.17 (55.1)	3.06 (77.7)	2.29 (58.2)	2.63 (66.8)	0.20 (5.0)	0.50 (12.7)	0.31 (7.9)	1.00 (25.4)	3.00 (76.2)	.50 (12.7)	.10 (2.5)
2 x 4 (50.8) x (101.6)	2.17 (55.1)	4.1 (104.1)	4.38 (111.3)	3.63 (92.2)	0.20 (5.0)	0.50 (12.7)	0.31 (7.9)	1.00 (25.4)	4.00 (101.6)	.50 (12.7)	.10 (2.7)
3 x 3 (76.2) x (76.2)	3.25 (82.6)	3.06 (77.7)	3.38 (85.9)	2.63 (66.8)	0.20 (5.0)	0.50 (12.7)	0.31 (7.9)	1.00 (25.4)	3.00 (76.2)	1.00 (25.4)	.10 (2.5)
3 x 4 (76.2) x (101.6)	3.25 (82.6)	4.1 (104.1)	3.38 (85.9)	3.63 (92.2)	0.20 (5.0)	0.50 (12.7)	0.31 (7.9)	1.00 (25.4)	4.00 (101.6)	1.00 (25.4)	.11 (2.8)
4 x 4 (101.6) x (101.6)	4.25 (108.0)	4.1 (104.1)	4.38 (111.3)	3.63 (92.2)	0.20 (5.0)	0.50 (12.7)	0.31 (7.9)	1.00 (25.4)	4.00 (101.6)	1.50 (38.1)	.11 (2.8)

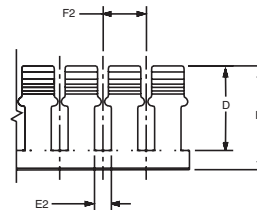
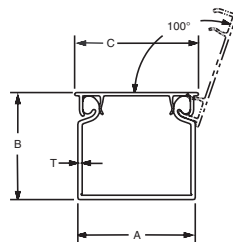

Type H

Type H 2", 3", and 4" wide duct.

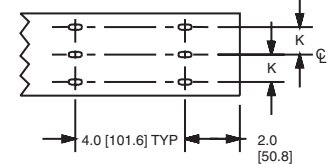

Wire Fill Capacity

Nominal Duct Size (W x H) In.	Nominal Area In. ²	Electrical															Communication							
		8 AWG			10 AWG			12 AWG			14 AWG			16 AWG			18 AWG			22 AWG	23 AWG	23/24 AWG	24 AWG	Fiber Cable
		.216	.164	.130	.141	.152	.111	.124	.133	.096	.111	.118	.084	.100	.106	.085	.330	.250	.190	.118				
		THHN	THHN	THHN	MTW	MTW	THHN	MTW	MTW	TFFN	MTW	MTW	TFFN	MTW	MTW	MTW	Cat. 6A	Cat. 6	Cat. 5e	3.0 mm				
1.50 x 2.00	3.000	34	60	95	81	70	131	105	91	175	131	116	229	162	144	224	14	25	44	116				
1.50 x 3.00	4.500	52	90	143	122	105	197	158	137	263	197	174	344	243	216	336	22	38	67	174				
2.00 x 2.00	4.000	46	80	127	108	93	175	140	122	234	175	155	306	216	192	299	19	34	59	154				
2.00 x 3.00	6.000	69	120	191	163	140	263	210	183	351	263	232	459	324	288	448	29	51	89	232				
2.00 x 4.00	8.000	92	160	255	217	187	350	281	244	469	350	310	612	432	384	598	39	69	119	309				
3.00 x 3.00	9.000	104	180	287	244	210	394	316	275	527	394	349	689	486	432	673	44	77	134	348				
3.00 x 4.00	12.000	139	241	383	326	280	526	421	366	703	526	465	919	648	577	897	59	103	179	464				
4.00 x 4.00	16.000	185	321	511	435	374	701	562	488	938	701	621	1225	864	769	1197	79	138	239	619				

Table shows maximum wire fill based on 50% of duct internal cross sectional area. Formula = nominal area/1.85 x D². See EG Catalog SA-ELCB04 page C1.48 for wiring duct color and size availability. AWG dimensions represent typical outer cable diameter in inches.

Material Specifications

Properties	PVC Material	Test Method
General		
Specific Gravity	1.47 g/cc	ASTM D 792
Rockwell Hardness	111 "R"	ASTM D 785
Mechanical		
Tensile Strength at Yield	5,600 psi	ASTM D 638
Tensile Modulus	330,000 psi	ASTM D 638
Flexural Strength at Yield	9,100 psi	ASTM D 790
Flexural Modulus	412,000 psi	ASTM D 790
Notched Izod Impact Strength at 23°C (73°F)	2.6 ft.-lbs./in.	ASTM D 256
Heat Deflection Temperature at 264 psi	169°F	ASTM D 648

Properties	PVC Material	Test Method
Flammability		
Limited Oxygen Index (LOI)	35	ASTM D 2863
Smoke Density (Flaming) at 4 min.	538	ASTM E 662
Flammability Class	V-0	UL94
Agency Approvals		
UL Recognized file E147128 CSA Certified file 016446-0-00		
CE Information	ENC50085 cable trunking system and cable ducting systems for electrical installations: <ul style="list-style-type: none"> • CDS (cable ducting system) for impact 2 J • Minimum storage and transport temperature -5°C • Minimum installation and application temperature -5°C • Maximum application temperature 60°C • Non-flame propagating • Without electrical continuity • Cover removable without a tool 	

Installation Tools



DFCT - Duct Finger Cutting Tool

- Easily removes duct fingers in tight places



DCT - Duct Cutting Tool

- Provides a smooth burr-free cut on both wiring duct and cover



TNR - Nylon Rivet Installation Tool

- Hand held tool for easy rivet installation



DNT-100 - Duct Notching Tool

- Notches duct sidewalls to bottom scoreline for tees and corners