



JOBSITE EQUIPMENT

REPLACEMENT PARTS

**MONSTER BOX™
MODELS 1000**

FOR REPLACEMENT PARTS GO TO WWW.KNAACK.COM

***NOTE, WELDING BY A CERTIFIED WELDER REQUIRED ON SOME REPLACEMENT PARTS.** The parts noted require welding by a certified welder and some touchup paint over newly welded areas. Knaack LLC assumes no legal responsibility for any welding done outside its factory. All warranties will be voided.

**For Customer Service
call toll free:
1-800-456-7865**

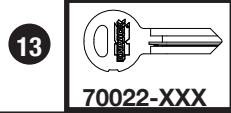

**REGISTER YOUR KEY CODE ONLINE at
www.knaack.com or at 1-866-KNAACK1.**
MONSTER BOX™ is a maximum security product. If all keys are lost, without a record of your key code it is possible to lock yourself out of your MONSTER BOX™.

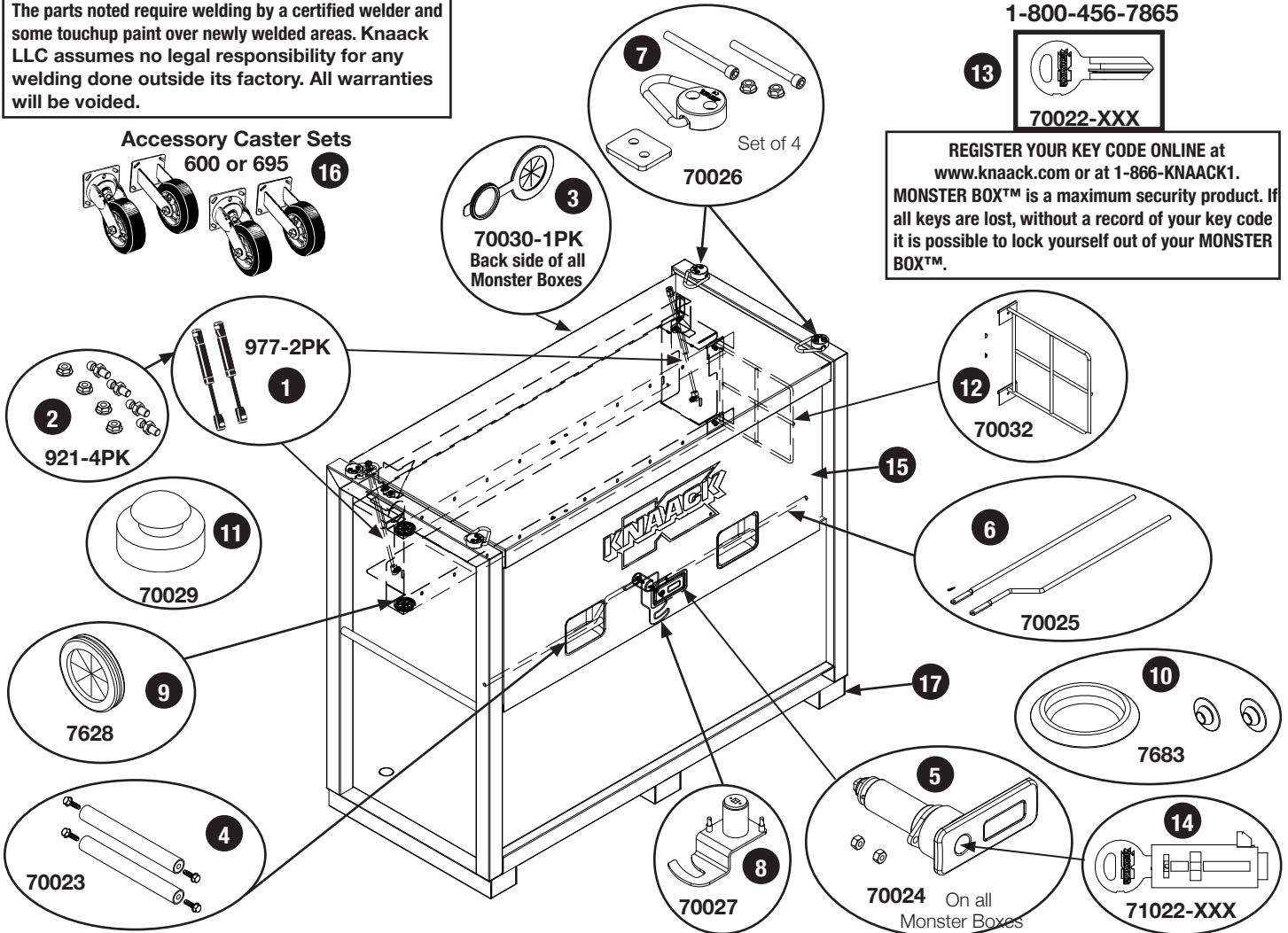

ITEM	PART No.	DESCRIPTION	FITS MODEL #
1	977-2PK	Gas Springs, 2 pack	1000
2	921-4PK	Ball Studs, 4 pack	For Gas Springs on Model 1000
3	70030-1PK	POWER PASS™ Grommet, 1 °	1000, 1010, 1020
4	70023	Handle Kit, 2 handles with screws	1000, 1020
5	70024	Latch Handle	1000, 1010, 1020
6	70025	Latch Rod	1000, 1010
7	70026	Lift Rings, set of 4	1000, 1010, 1020
8	70027	Catch	1000, 1020
9	7628	Shelf Grommet, 1	1000
10	7683	Caps & Plugs Kit	1000, 1010, 1020 as well as other products. Partial contents needed.
11	70029	Stem Bumpers	1000
12	70032	Storage Grid	1000
13	70022-XXX	Keys, set of 4	1000, 1010, 1020
14	71022-XXX	Lock Cylinder	1000, 1010, 1020
15	70061	Cover	*NOTE, WELDING REQUIRED 1000
16	600	Accessory Casters - set of 4	Load Rating 3280 Lbs. Fits 1000, 1010, 1020
16	695	Accessory Casters - set of 4	Load Rating 2600 Lbs. Fits 1000, 1010, 1020
17	7014	Skid	*NOTE, WELDING REQUIRED 1000, 1010, 1020
18	953-1CN	Aerosol Paint (not shown)	Genuine KNAACK® Tan trademarked color