

School Zone™ FINE FISSURED™

Square Lay-In, Tegular
medium texture

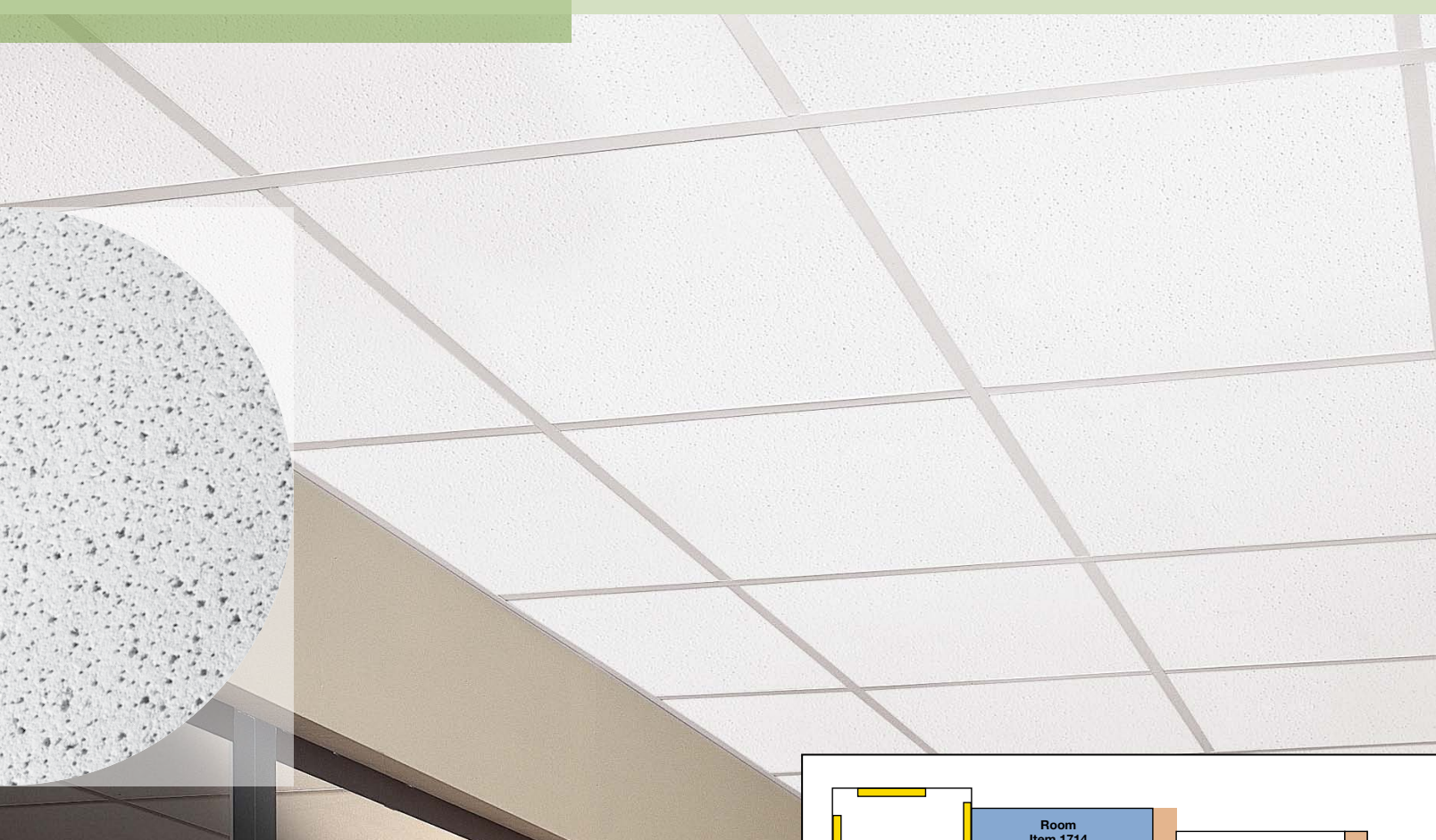

School Zone Fine Fissured with Prelude® 15/16" Exposed Tee grid (Pg. 215)

Key Selection Attributes

- Excellent sound absorption. Products help comply with ANSI S12.60 Classroom Guidelines
- Economical
- Non-directional visual reduces installation time and scrap
- 30-Year Limited System Warranty against visible sag, mold/mildew, and bacterial growth

Typical Applications

- Classrooms
- Administrative offices
- Corridors
- Lobbies
- Music/band rooms
- Cafeterias
- Auditoriums
- Libraries

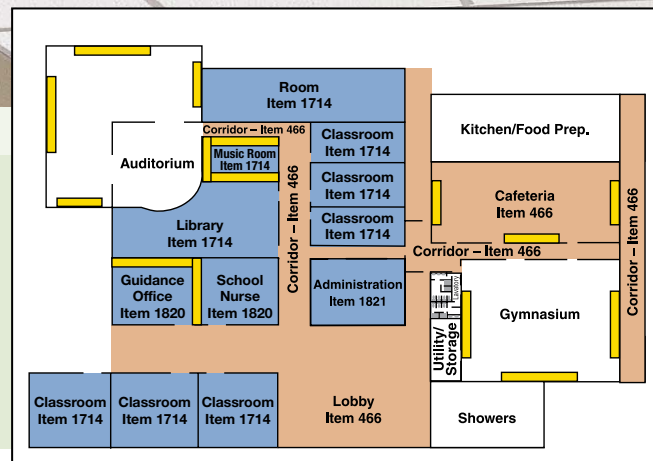

Color



White (WH)

Detail (Other Suspension Systems compatible. Refer to listing on page 178.)

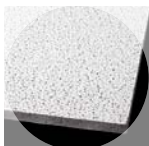

Fine Fissured Square Lay-in

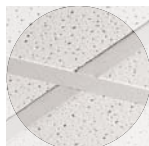

Fine Fissured Square Lay-in with Prelude 15/16" Exposed Tee grid

School Zone™ FINE FISSURED™

Square Lay-In, Tegular

medium texture

Recycled Content: **Up to 52%**

armstrong.com/greengenie

LEED® Credits

Energy	Waste Mgmt	Recycled Content	Local Materials	Renewable Materials	Daylight & Views
✓	✓	✓	✓	✓	✓
Location Dependent					

LEED for Schools

Acoustics	Low Emitting or CHPS
✓	✓

\$\$\$\$

Visual Selection

Performance Selection

Dots represent highest level of performance.

Edge Profile	Grid Drawings Cat. pgs. 226-228 or armstrong.com/catdwg	Item No.	Dimensions	UL Classified Acoustics		Fire Rating	Light Reflect	Sag Resist	Anti-Microbial	Durable	Recycle Program	
				NRC	CAC							
High Durability												
15/16" Square Lay-in		1	465 2' x 2' x 5/8"	□	0.55	35	Class A	0.85	HumiGuard+	BioBlock+	Impact	Yes
			465M 600 x 600 x 15mm									
15/16" Square Lay-in		1	466 2' x 4' x 5/8"	□	0.55	35	Class A	0.85				
			466M 600 x 1200 x 15mm									
High Acoustics												
9/16" Beveled Tegular		31	1719 2' x 2' x 3/4"	□	0.70	40	Class A	0.85			Standard	
			1821 600 x 600 x 19mm									
9/16" Beveled Tegular		31	1821 2' x 2' x 3/4"	□	0.70	35	Class A	0.85			Standard	
			1821M 600 x 600 x 19mm									
15/16" Angled Tegular		7	1717 2' x 2' x 3/4"	□	0.70	40	Class A	0.85			Standard	
			1820 600 x 600 x 19mm									
15/16" Angled Tegular		7	1820 2' x 2' x 3/4"	□	0.70	35	Fire Guard	0.85			Standard	
			1820M 600 x 600 x 19mm									
15/16" Angled Tegular		7	1824 2' x 4' x 3/4"	□	0.70	35	Fire Guard	0.85			Standard	
			1824M 600 x 1200 x 15mm									
15/16" Square Lay-in		1	1810 2' x 2' x 3/4"	□	0.70	35	Fire Guard	0.85			Standard	
			1810M 600 x 600 x 19mm									
15/16" Square Lay-in		1	1713 2' x 2' x 3/4"	□	0.70	35	Class A	0.85			Standard	
			1713M 600 x 600 x 19mm									
15/16" Square Lay-in		1	1811 2' x 4' x 3/4"	□	0.70	40	Fire Guard	0.85			Standard	
			1811M 600 x 1200 x 19mm									
15/16" Square Lay-in		1	1714 2' x 4' x 3/4"	□	0.70	40	Class A	0.85			Standard	
			1714M 600 x 1200 x 15mm									

Suspension Systems

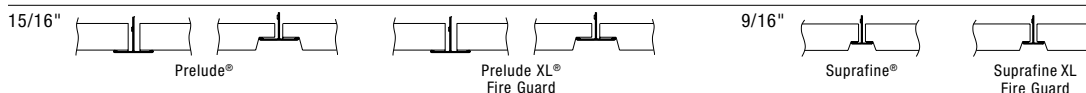

Physical Data

Material
Wet-formed mineral fiber

Surface Finish
Factory-applied latex paint

Fire Performance
ASTM E84 and CAN/ULC S102 surface burning characteristics. Flame Spread Index 25 or less. Smoke Developed Index 50 or less. (UL labeled) Fire Guard™: A fire resistive ceiling when used in applicable UL assemblies

ASTM E1264 Classification
Type III, Form 2, Pattern C E
Fire Class A

Sag Resistance
HumiGuard® Plus – superior resistance to sagging in high humidity conditions up to, but not including, standing water and outdoor applications.

VOC/Formaldehyde Emissions
Meets CA Dept. of Health Services Standard Practice for the testing of VOC Emissions and is listed on CHPS High Performance Products Database for Low-Emitting Materials.

Anti Mold/Mildew & Bacteria
BioBlock® Plus contains an anti-microbial treatment and provides guaranteed resistance against growth of mold/mildew and Gram-positive and Gram-negative odor/stain-causing bacteria for 30 years.

Insulation Value
R Factor – 1.5 (BTU units)
R Factor – 0.26 (Watts units)

30-Year Performance Guarantee & Warranty Information
Details in back of catalog or at armstrong.com/warranty

Weight; Square Feet/Carton
465 – 1.05 lbs/SF; 64 SF/ctn
466 – 1.06 lbs/SF; 64 SF/ctn
1824 – 1.20 lbs/SF; 64 SF/ctn
1717, 1719 – 1.25 lbs/SF; 48 SF/ctn
1713, 1810, 1820, 1821 – 1.31 lbs/SF; 48 SF/ctn
1714, 1811 – 1.38 lbs/SF; 64 SF/ctn