



6TFE1

Tubeaxial Fan Vane Sections

Vane sections straighten air flow to increase the pressure and efficiency of tubeaxial fans.

- Steel construction and charcoal baked enamel coating with UV inhibitors
- Mounting flanges at both ends
- Predrilled mounting holes match tube fan housing
- Attaches to ductwork with companion flanges.

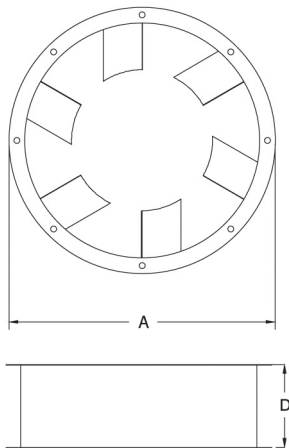

DIMENSIONS IN INCHES

SKU NO.	A - DIAMETER	D - DEPTH	FOR USE WITH FAN SIZE	FOR USE WITH FAN SIZE
Tubeaxial Fan Vane Sections				
6TFE1	27	6 ¹⁵ / ₃₂	24	3C411B, 4TM85, 6TFD8
6TFE2	33 ⁵ / ₈	8 ²¹ / ₃₂	30	3C412B, 2XZH2, 6TFD9
6TFE3	51 ³ / ₄	12 ³¹ / ₃₂	48	3C416D, 6TFEC0



3DNY3

Tubeaxial Inlet or Outlet Guards

For bolting to the intake or exhaust end of the tubeaxial.

Inlet or Outlet Guard Optional Construction

- 16 gauge galvanized steel

DIMENSIONS IN INCHES

SKU NO.	HOLE DIAMETER	FOR USE WITH FAN SIZE
16 GAUGE GALVANIZED INLET OR OUTLET GUARDS		
3DNX8	⁵ / ₁₆	12
3DNX9	⁵ / ₁₆	16
3DNY1	⁵ / ₁₆	18
3DNY2	⁷ / ₁₆	21
3DNY3	⁷ / ₁₆	24
3DNY4	⁷ / ₁₆	30
3FHV3	⁷ / ₁₆	34
3DNY5	⁷ / ₁₆	36
3DNY6	⁹ / ₁₆	42
3DNY7	⁹ / ₁₆	48
5JKF6	⁹ / ₁₆	50
5JKF7	⁹ / ₁₆	60

4YM54A
Tubexial Fan
Discharge Cap
Curb Cap



4YM46

Tubexial Fan Discharge Caps and Curb Caps

These accessories can be used to convert a tubexial fan into an upblast roof ventilator. Not recommended for Smoke Exhaust Tubexial Fans.

Discharge Cap Features

- Heavy-duty, galvanized steel wind band
- Removable panels for easy access to the damper
- Dampers are constructed of aluminum for easy opening at low velocities

Curb Cap Features

- Heavy-gauge steel and charcoal baked enamel coating with UV inhibitors

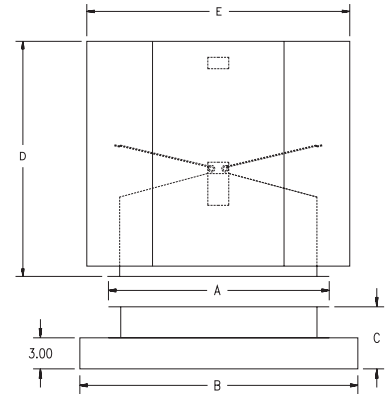

SKU NO.		DIMENSIONS IN INCHES					
DISCHARGE CAP	CURB CAP	FOR USE WITH FAN SIZE	A	B	C	D	E
TUBEAXIAL FAN DISCHARGE CAPS AND CURB CAPS							
4YM54A	4YM46	16	18 3/4	26	6	21 3/32	24
4YM55A	4YM47	18	21 1/8	30	6	23 3/32	26
5JKF5	5JKF4	21	23 7/8	31	6	26	29
4YM56A	4YM48	24	27	34	6	29 3/32	32
4YM57	4YM49	30	33 5/8	42	6	32 3/32	38
4YM58	4YM50	34	37 3/4	42	6	36 13/32	42 13/64
4YM59	4YM51	36	39 3/4	46	6	38 13/32	44 13/64
4YM50	4YM52	42	45 3/4	57	6	44 13/32	50 13/64
4YM61	4YM53	48	51 3/4	57	6	50 13/32	56 13/64
5JKF2	5JKF0	54	57	64	6	59	62
5JKF3	5JKF1	60	63	70	6	65	68

Tubexial Fan Companion Flanges

Companion flanges are used to attach tubexial fans to ductwork.

Companion Flange Features

- Sold in pairs
- Mounting flanges at both ends
- Pre-drilled mounting holes match tubexial fan housing as well as vane sections configured with tubexials

Companion Flange Optional Construction

- 304 stainless steel or
- Steel construction and charcoal baked enamel coating with UV inhibitors

Companion Flange Benefits

- Allows the tubexial fans to be mounted to ductwork in any position

DIMENSIONS IN INCHES		
SKU NO.	HOLE DIAMETER	FOR USE WITH SIZE
GALVANIZED COMPANION FLANGE		
4C716	5/16	12
4C717	5/16	16
4C718	5/16	18
1LWN9	7/16	21
3C436	7/16	24
3C440	7/16	30
3C441	7/16	34
3C442	7/16	36
3C443	9/16	42
3C444	9/16	48
5JKE6	9/16	54
5JKE7	9/16	60
STAINLESS STEEL COMPANION FLANGE		
4ETF9	7/16	24
4ETG1	9/16	30
4ETG2	9/16	48



4C716

Call or visit your local branch or go to grainger.com/dayton for complete product line information.



Find it at Grainger.