

Dayton Centrifugal Pump Heads



PUMPS technical data sheet

Centrifugal pumps are designed for fluid transfer, chemical processing, cooling and circulating applications. These pumps are typically used in industrial applications and are designed to operate continuously. These centrifugal pumps are not submersible and are manually operated.



1/3HP through 3HP 304 Stainless Steel End Suction Centrifugal Pump Heads

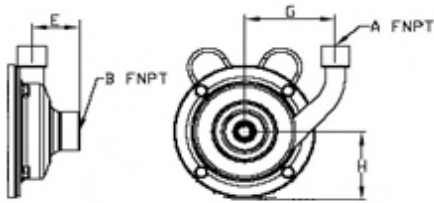

Design Frequency (Hz)	60
Design RPM	3450
Design Motor Type	NEMA 56J - ODP or TEFC
Max. Suction Lift	25 feet (7.6m)
Max. Case Pressure	150 psi
Volute Material	304 Stainless Steel
Impeller Type	Enclosed
Impeller Material	304 Stainless Steel
Diffuser Material	304 Stainless Steel
Hardware Material	304 Stainless Steel
O-rings	Viton
Seal Type	Type 21 Single Mechanical
Seal Materials	Carbon/Ceramic/Viton
Max. Water Temperature	40-200°F (4-93°C)
Max. Ambient Temperature	104°F (40°C)
Designed Fluid Environment	Liquid Transfer, Cooling, Circulating

Material Number	4JMY1	4JMY2	4JMY3	4JMY4	4JMY5	4JMY6	4JMY7
Required HP	1/3	1/2	3/4	1	1-1/2	2	3
Dimension A (FNPT)	1/2 Inch	3/4 Inch	3/4 Inch	1-1/4 Inch	1-1/4 Inch	1-1/2 Inch	1-1/2 Inch
Dimension B (FNPT)	3/4 Inch	3/4 Inch	1-1/4 Inch	1-1/2 Inch	1-1/2 Inch	2 Inch	2 Inch
Dimension E (Inch)	2.09	2.09	2.09	1.80	1.80	1.73	1.73
Dimension G (Inch)	4.13	4.13	4.13	4.33	4.36	4.60	4.60
Dimension H (Inch)	3.50	3.50	3.50	3.50	3.48	3.48	3.48

Performance Data

Head	1/3 HP	Shut off 48 ft. / 14.6 m	Feet	10	20	30	40	50	65	70
Flow Rate		Max. Flow 20 gpm / 76 lpm	GPM	20	15	4	1	0	-	-
Head	1/2 HP	Shut off 50 ft. / 15.2 m	Feet	10	20	30	40	50	65	70
Flow Rate		Max. Flow 34 gpm / 129 lpm	GPM	34	29	20	5	0	-	-
Head	3/4 HP	Shut off 62 ft. / 18.9 m	Feet	10	20	30	40	50	65	70
Flow Rate		Max. Flow 52 gpm / 197 lpm	GPM	52	47	38	29	18	-	-
Head	1 HP	Shut off 65 ft. / 19.8 m	Feet	10	20	30	40	50	65	70
Flow Rate		Max. Flow 84 gpm / 318 lpm	GPM	84	77	57	48	24	0	-
Head	1-1/2 HP	Shut off 65 ft. / 19.8 m	Feet	10	20	30	40	50	65	70
Flow Rate		Max. Flow 108 gpm / 409 lpm	GPM	108	100	81	70	44	0	-
Head	2 HP	Shut off 68 ft. / 20.7 m	Feet	10	20	30	40	50	65	70
Flow Rate		Max. Flow 114 gpm / 432 lpm	GPM	114	109	92	85	55	8	-
Head	3 HP	Shut off 81 ft. / 19.8 m	Feet	10	20	30	40	50	65	70
Flow Rate		Max. Flow 144 gpm / 545 lpm	GPM	144	131	116	105	85	50	38

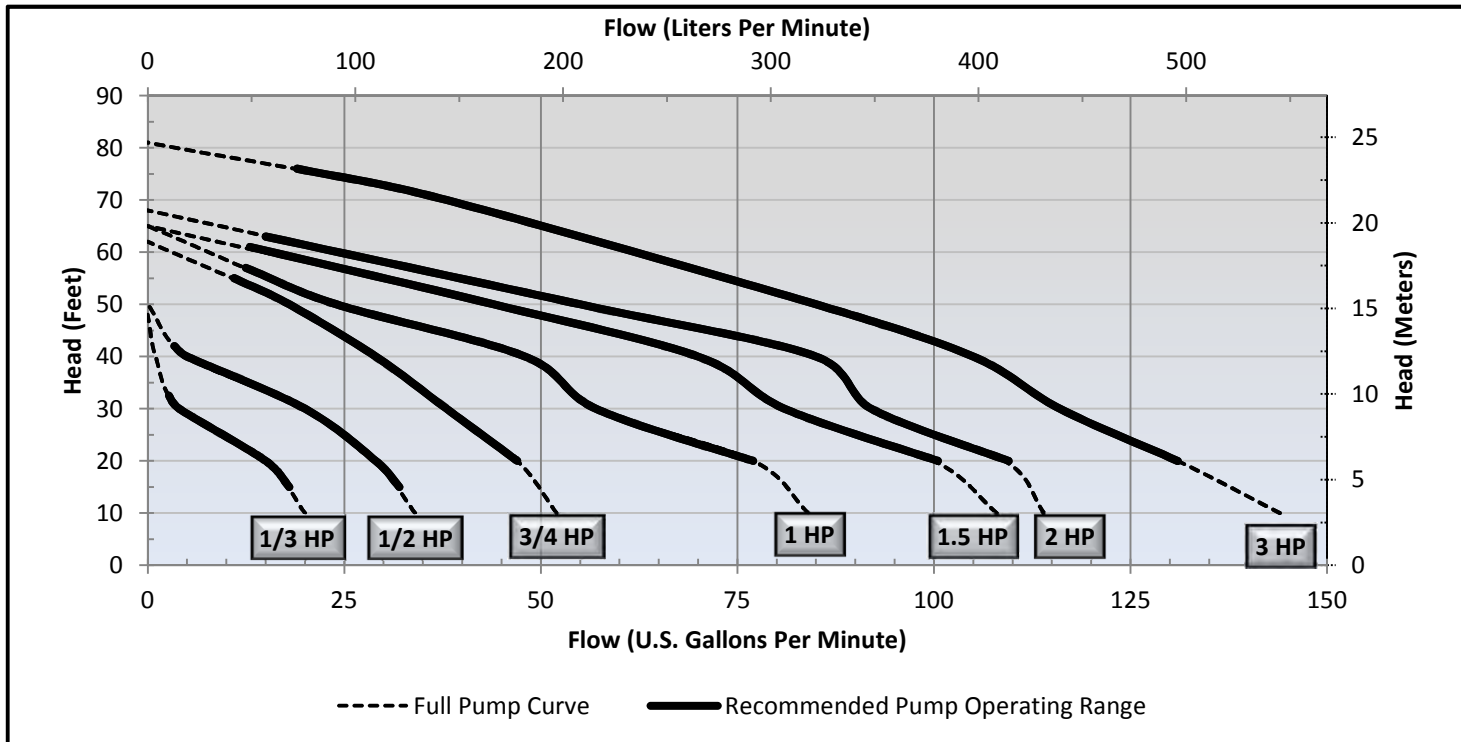

WARNING: Use only with nonflammable liquids compatible with pump component materials and in nonflammable/non-explosive atmospheres.

Call or visit your local branch or go to grainger.com/dayton
for complete product line information



Exclusively from Grainger.