

CUSTOMER SPECIFICATION DRAWING

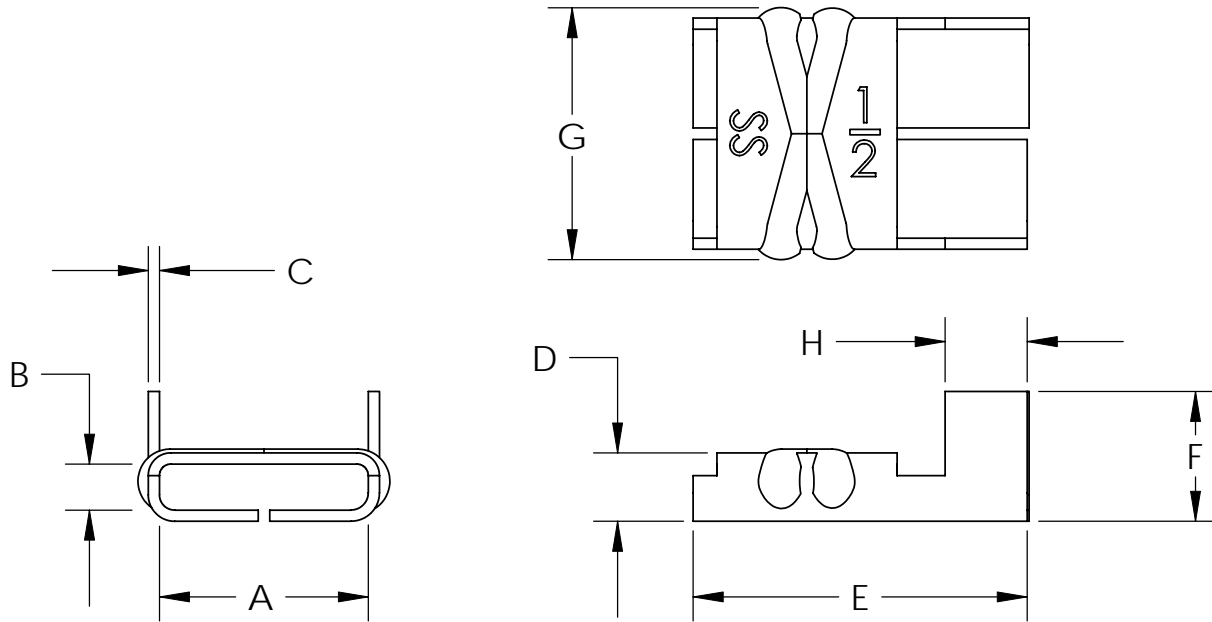

PART NUMBER	A	B	C	D	E	F	G	H	QTY PER BOX	WEIGHT PER BOX [LBS.]
GRC154	.540-.565	.110-.130	.030 ± .002	.19	.875	.371-.411	.63	.22	50	0.50
GRC156	.790-.812	.110-.135	.044 ± .003	.22	.875	.505-.545	.90	.22	50	1.01

NOTES:

1. MATERIAL: 200/300 STAINLESS STEEL PER BAND-IT SPECIFICATION.
2. GRC154 VALUCLIP SHOWN.

ABOVE SPECIFICATION CERTIFIED BY: _____ DATE: _____

TITLE: _____

UNLESS OTHERWISE NOTED:
DIMENSIONS ARE IN INCHES
AFTER FINISH

TOLERANCES:

X ±0.100
 .XX ±0.020
 .XXX ±0.005
 .XXXX ±0.001
 ANGLES ±0.5°

BAND-IT®

A unit of ~~IDEX~~ Corporation
 P.O. Box 16307
 Denver, Colorado U.S.A.

PROPRIETARY AND CONFIDENTIAL

THIS DRAWING WITH ALL
 CONTENTS IS PROPERTY OF
 BAND-IT-IDEX, INC.
 REPRODUCTION, DISCLOSURE OR
 MFG. OF MATTER SHOWN IS
 PROHIBITED WITHOUT WRITTEN
 PERMISSION.
 DO NOT SCALE DRAWING

TITLE:

**VALUCLIP, BOXED,
 GRAINGER**

DWG. NO.

GRC153

REV -

SHEET 2 OF 2