

SF-2100/SF-2150
SF-2200/SF-2250

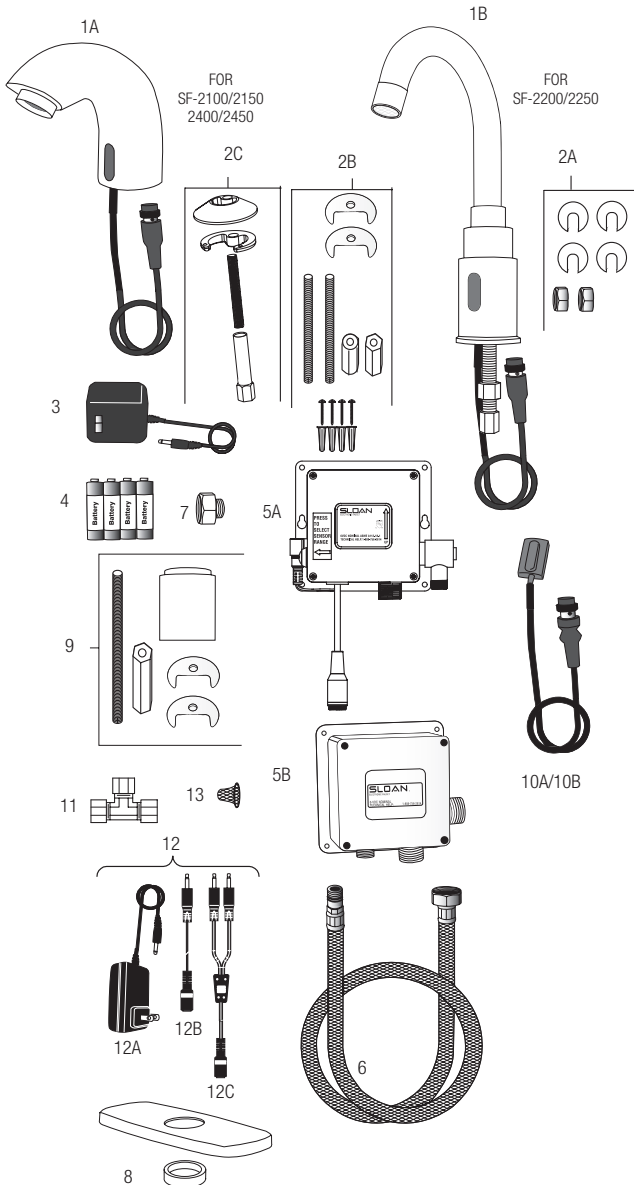

PARTS LIST—SF-2100/SF-2150/SF-2200/SF-2250

Item No.	Code No.	Part No.	Description
1A.	—	—	Pedestal Faucet Assembly w/Outlet (Models SF-2100 and SF-2150)
1B.	—	—	Gooseneck Faucet Assembly w/Outlet (Models SF-2200 and SF-2250)
	0362005	SFP-5	Mounting Hardware Kit, Screws and Anchors for Control Module (all models)
2A.	—	SFP-1004	Mounting Hardware Kit, Pedestal Faucet (Models SF-2200/SF-2250)
2B.	0362004	SFP-4	Mounting Hardware Kit, Pedestal Faucet (Models SF-2100/SF-2150) (Pre 3/2010)
2C.		SFP-44	Mounting Hardware Kit for SF-2100/2150 (Post 3/2010)
3.	0362006	SFP-6	110 VAC/6 VDC Plug-In Adapter (US) (Models SF-2100 and SF-2200)
4.	—	—	Batteries, 4 AA-size (all models)
5A.	0362040	SFP-40-A	Control module w/ adjustable button (6 pin connector)
5B.	0362008	SFP-8	Control module (Prior 8/2008-4 pin connector)*
6.	0362010	SFP-10	Flex Hose, Control Module to Spout (all models)
7.	0362045	SFP-45-A	Inlet adapter – 1/2" NPSM to 3/8" compression connection (not supplied with most international models)
8.	0362011	SFP-11	4" Trim Plate with Spacer (all models)
9.	0362030	SFP-30A	Faucet Extension Kit (Models SF-2100/2150)
10A.	0362041	SFP-41-A	Sensor Assembly (6 pin connector)
10B.	0362034	SFP-34	Sensor Assembly (Prior 8/2008-4 pin connector)*
11.	3365461	ETF-617-A	3/8" Bak-Chek® Tee Compression Fitting

* IMPORTANT: Sloan added the range adjustment feature in August 2008 for faucets made prior to August 2008 use the following replacement parts: SFP-34 and SFP-8

NOT SHOWN SEPARATELY

—	0335029	EAF-51	0.35 gpm (1.3 Lpm) spray head (Models SF-2100/2150)
—	0335012	EAF-15	0.5 gpm (1.9 Lpm) vandal resistant spray head (Models SF-2100/2150)
—	3362000	SFP-1000	0.35 gpm (1.3 Lpm) vandal resistant spray head (Models SF-2100/2150)
—	0362012	SFP-12	Gooseneck Spout w/Outlet (Models SF-2200/2250)
—	0362013	SFP-13	0.5 gpm (1.9 Lpm) spray head (Models SF-2100/2150)
—	0362014	SFP-14	Spray head for Gooseneck Faucet (Models SF-2200/2250)
—	0362023	SFP-23	2.2 gpm (8.3 Lpm) Aerator (Models SF-2100/2150)
—	0362024	SFP-24	2.2 gpm (8.3 Lpm) vandal resistant aerator (Models: SF-2100/2150)
—	0362020	SFP-26	220 VAC/6 VDC Plug-In Adapter (ASIA)
—	0362025	SFP-25	220 VAC/6 VDC Plug-In Adapter (EURO)
—	0362026	SFP-20	220 VAC/6 VDC Plug-In Adapter (UK)
—	3362022	SFP-22-A	8" Trim Plate

ACCESSORIES

12.	0362035	SFP-35-A	100-240 VAC/6 VDC Gang Adapter Kit, includes 12A, 12B and 12C
12A.	0362016	SFP-36-A	100-240 VAC/6 VDC Plug-In Adapter
12B.	0362018	SFP-38	Cable Splitter, 51" (1300 mm) – 5 included in kit
12C.	0362017	SFP-37	Cable Extension, 51" (1300 mm)

REPAIR PARTS

13.	0362015	SFP-15	Strainer (located in water inlet of control module)
-----	----------------	--------	---

— in Item No. column = Not shown in illustration
— in Code No. and Part No. column = Not sold separately

SF-2100/SF-2150**SF-2200/SF-2250**

TROUBLESHOOTING GUIDE

1. Faucet delivers water in an uncontrolled manner.

A. Faucet is not working properly. Contact Sloan Technical Support.

2. Faucet DOES NOT deliver any water when sensor is activated.

INDICATOR: Solenoid valve produces an audible “CLICK.”

A. Water supply stop(s) closed. Open water supply stop(s).

B. Water strainer in control module is clogged. Close supply stops and remove water inlet line at control module. Remove, clean and reinstall strainer and water inlet line. Replace strainer if required.

INDICATOR: Solenoid valve DOES NOT produce an audible “CLICK.”

A. Batteries low (battery powered models). Replace batteries.

B. Power failure (adapter powered models). Check power supply.

3. Faucet delivers only a slow flow or dribble when sensor is activated.

A. Water supply stop(s) are partially closed. Completely open water supply stop(s).

B. Water strainer in control module is clogged. Close supply stops and remove water inlet line at control module. Remove, clean and reinstall strainer and water inlet line. Replace strainer if required.

C. Aerator is clogged. Remove, clean, and reinstall aerator. Replace aerator if required.

D. Faucet is not working properly. Contact Sloan Technical Support.

4. Faucet DOES NOT stop delivering water or continues to drip after user is no longer detected.

A. Faucet is not working properly. Contact Sloan Technical Support.

5. The water temperature is too hot or too cold on a Faucet connected to hot and cold supply lines.

A. Supply stops are not adjusted properly. Adjust supply stops.

CARE AND CLEANING

DO NOT USE abrasive or chemical cleaners (including chlorine bleach) to clean faucet that may dull the luster and attack the chrome or special decorative finishes. Use **ONLY** mild soap and water, then wipe dry with clean cloth or towel. While cleaning the bathroom tile, protect the faucet from any splattering of cleaner. Acids and cleaning fluids will discolor or remove chrome plating.

When assistance is required, please contact Sloan Technical Support at: 1-888-SLOAN-14 (1-888-756-2614).