



# 1207MAX Series

Air Ratchets



# Taking productivity to the MAX

As a member of the Ingersoll Rand family of MAX tools, the 1207MAX Series air ratchet combines best-in-class performance and a full complement of premium features to give professional technicians MAX Power, MAX Control, and MAX Comfort. It's another in the long line of tools designed to help make your job easier — and you more productive.

**Improved ratchet mechanism** resists anvil slippage and provides increased durability.

**Heat-treated ratchet housing** offers improved strength to resist head spreading and increase durability.

**Nickel-plated housing** provides enhanced corrosion resistance.

**65 ft-lb max torque** delivers best-in-class power for stubborn fasteners.

**Patent-pending forward/reverse collar** provides unrestricted access to easily change the direction of the tool, which is critical in tight spaces where traditional tools get jammed.

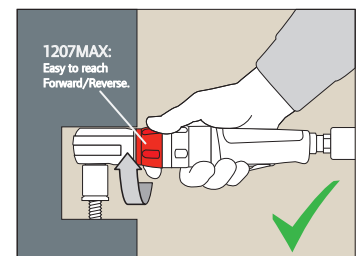
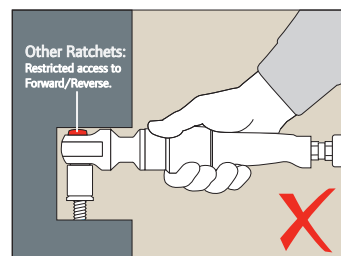

Model	Drive Size	Max Torque ft-lb (Nm)	Avg. Free Speed rpm	Weight lb (kg)	Length in (mm)	Free Speed Air Cons. cfm (L/min)	Free Speed Sound Level dBA	Air Inlet	Minimum Hose Size
<b>1207MAX SERIES</b>									
1207MAX-D3	3/8"	65 (88)	200	3.14 (1.42)	10.83	23 (651)	85	1/4"	3/8"
1207MAX-D4	1/2"	65 (88)	200	3.19 (1.45)	10.83	23 (651)	85	1/4"	3/8"

# 1207MAX

**Variable-speed regulator** is hand-operable and gives technicians the ability to easily control performance — perfect for use on a variety of fastener sizes.



**360-degree swivel air inlet** prevents twisted air hoses.

**Composite handle** insulates operator's hands from the cold.

**Fully variable, feather-touch trigger** gives operators access to all of the performance that lies between Off and On.

**Integrated muffler** helps maintain operator comfort by reducing sound without sacrificing power.

**360-degree adjustable deflector** allows users to choose direction of exhaust.



## MAX Power

**65 ft-lb of maximum torque** ensures enough power for tough applications.

## MAX Control

**Innovative forward/reverse collar**, variable-speed power regulator, adjustable exhaust, and feather-touch trigger combine to offer unprecedented control.

## MAX Comfort

**Ergonomic composite handle** is comfortable for extended use.

[ingersollrandproducts.com](http://ingersollrandproducts.com)



**Socket sets**

SK3H7U – 3/8" drive 7-pc SAE universal socket set  
 SK4H13 – 1/2" drive 13-pc SAE standard socket set  
 SK34C86 – 3/8" and 1/2" drive 86-pc combo standard and deep socket set

**Service kits**

1207-D3-TRK1  
 1207-D4-TRK1

**Lubrication**

67 1 LB  
 70 1 LB  
 10Z4

**Ingersoll Rand provides total solutions** for getting the job done right. When you need genuine replacement parts, count on us to deliver.



Ingersoll Rand Industrial Technologies provides products, services and solutions that enhance our customers' energy efficiency, productivity and operations. Our diverse and innovative products range from complete compressed air systems, tools and pumps to material and fluid handling systems and environmentally friendly microturbines. We also enhance productivity through solutions created by Club Car®, the global leader in golf and utility vehicles for businesses and individuals.

(800) 866-5457 • [ingersollrandproducts.com](http://ingersollrandproducts.com)

Distributed by:

