

Tempest Post with Fillable Plastic Base

Parts List:

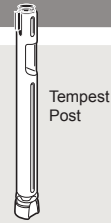

PLEASE READ AND UNDERSTAND INSTRUCTIONS THOROUGHLY BEFORE ASSEMBLY

Assembly:

1. To ensure a weight of 15 lbs., fill the base with water until it reaches the filler hole. In extreme temperature conditions, add salt or non-toxic antifreeze. Sand may also be used as filler to ensure 15 lb. weight. (Illustration A)
2. Secure the plug. (Illustration B)
3. Pull 1–2 feet of belt out of the mechanism and pinch against post to halt retraction. (Illustration C)
4. Prop base on its side and pass belt-end through center of base from the bottom, then push post through. Align post so belt is facing away from handle of base. (Illustration D)
5. Stand post upright on the base.
6. Step on base and pull post upward until you feel a positive "snap" as it locks in place. (Illustration E)

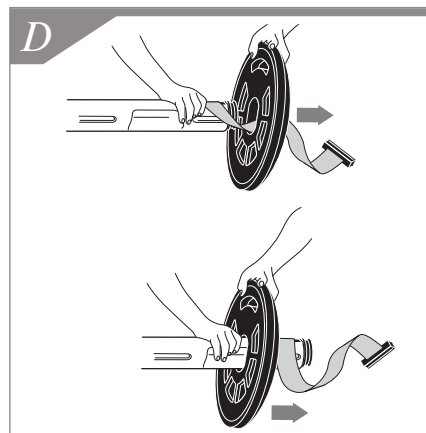
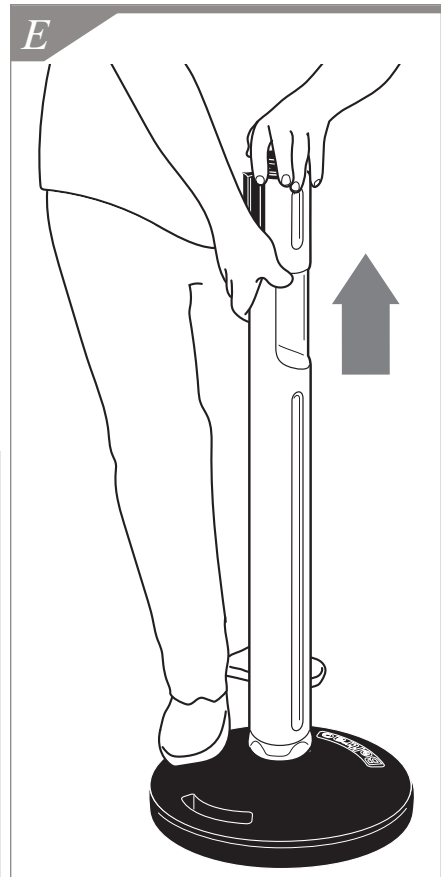
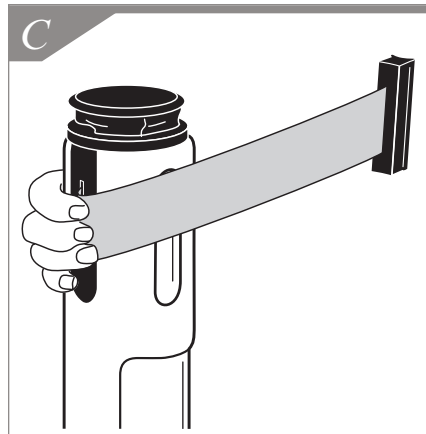
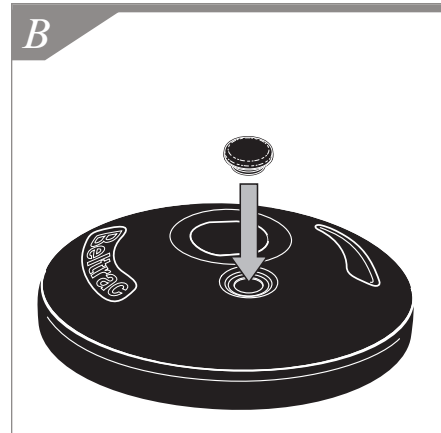
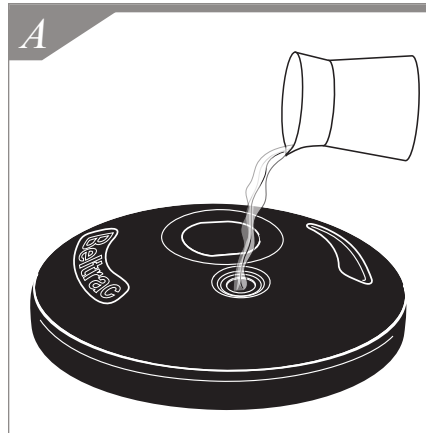

Special Note:

The fillable-base Tempest Post is not intended for disassembly. *IF NECESSARY*, take precautions to ensure water and/or debris do not enter the mechanism while draining the base.