



Core & Coil (71A) MH 175W - 450W

CORE & COIL HID MH BAL 200W M136 QUAD KIT

The basic ballast is the open core and coil which is most often used as a component within a lighting luminaire. The core and coil also forms the nucleus of Philips Advance's five other ballast configurations.

Product data

General Information		Input Frequency	
ANSI Code	M136	Input Frequency	60 Hz
Lamp Type	200W MH	Inp. Current (Open Circuit)	2/1.2/1/0.85 A
Number of Lamps	1 piece/unit	Input Current (Starting)	0.75/0.4/0.35/0.3 A
Circuit Type	SUPER-CWA	Input Current (Short Circuit)	0.45-0.7/0.25-0.4/0.22-0.35/0.2-0.3 A
Ballast Type	Magnetic HID	Secondary Short Circuit Current	1.9-2.3 A
Base Model	71A5692	Constant Wattage Deviation	10%
Core Size	3 X 4 (2 coil)	Ballast Factor (Nom)	1
Suitable For Outdoor Use	Yes	Power Factor (Nom)	0.90
Ignitor Catalog Number	LI533-H4	Nominal Open Circuit Voltage	240 V
Ignitor Temperature Rating	105°C	Input Current (Operating) (Nom)	2/1.2/1/0.85 A A
Capacitor Value	15 MFD	Input Power (Nom)	232 W
Capacitor Catalog Number	7C150M33	Rated Lamp Watts	200 W
Capacitor Requirements	330V	Wiring	
Capacitor Temperature Rating	105°C	Wire Striplength	0.5 mm
Capacitor Diameter/Oval Dimensions	1.65 in	Wire Length by Color	12"
Capacitor Height	3.75 in	Wire Type	Stranded
Automatic Restart	No	Remote Wiring Configuration Allowed	Yes
Operating and Electrical		Max Ballast-Lamp Distance Remote	2'
Input Voltage	120/208/240/277 V	Wiring	

Core & Coil (71A) MH 175W - 450W

Recommended Fuse Value	6/4/3/3 A
Approval and Application	
Open Circuit Voltage Test (Volts)	215-265 V
Approbation Marks	ULR CSA certificate RoHS Compliant
Temperature Marking	A/B/A/A
UL Recognized	Yes
Hipot Test (1 Minute)	2000 V
Hipot Test (2 Seconds)	2500 V
UL Insulation Class	H(180°C)
UL Temperature Code	1029B

Product Data	
Order product name	CORE & COIL HID MH BAL 200W M136 QUAD KIT
EAN/UPC - Product	781087093474
Order code	71A5692001D
Numerator - Quantity Per Pack	1
Numerator - Packs per outer box	1
Material Nr. (12NC)	913700534409
Net Weight (Piece)	3.870 kg

Dimensional drawing

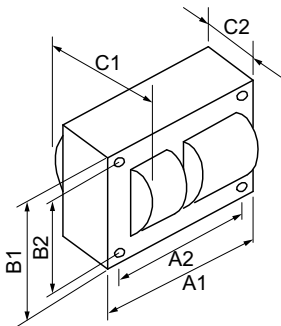

MH BAL 200W M136 QUAD KI

Product	C1	C2	A1	A2	B1	B2
CORE & COIL HID MH BAL 200W M136 QUAD KIT	3.6 in	2.45 in	3.9 in	3.5 in	2.8 in	2.4 in

