

# Series M195 Exit Device Trim

Specifications	
<b>Levers:</b>	Solid cast Zamac, with 1/2" return (except 395 & 495)
<b>Roses:</b>	Thru-bolted, 3-7/16" spring loaded Roses
<b>Door Thickness:</b>	1-5/8" – 1-7/8"
<b>Clutch:</b>	Standard
<b>Chassis:</b>	Aluminum
<b>Cylinder:</b>	MARKS "C" keyway, 6 pin w/ 2 keys IC Core model - Core not included
<i>Lifetime Mechanical Warranty</i>	

OPTIONS	CODE
Yale Conventional	F7
Sargent conventional cylinder	F8
Corbin conventional cylinder	F9
Corbin 6 pin IC core	F12
Corbin 7 pin IC core	F13
Yale 6 pin IC core	F14
Yale 7 pin IC core	F15
Schlage 6 pin IC core	F19
Sargent IC core	F20
Medeco IC core large format	F21
Less Cylinder	G3

MARKS #	Trim
M195S/295/395/495	MLHL650S
M195F/295/395/495	MLHL650F
M195N/295/395/495	MLHL650N
M195DT/295/395/495	MLHL650DT

## M195 Series Leverset

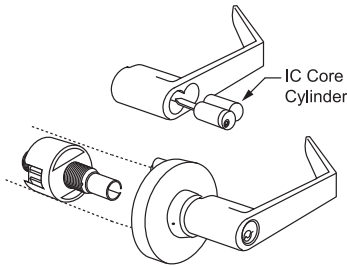

## M295 Series Leversetw

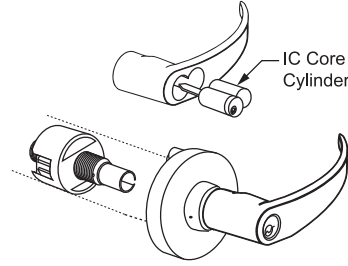

## M395 Series Leverset

NOTE: 395 Series  
*IS NOT* Available  
with IC Core

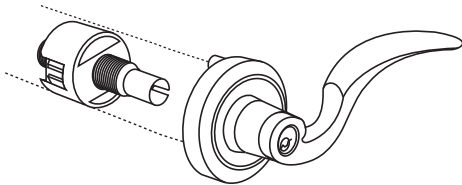

## M495 Series Leverset

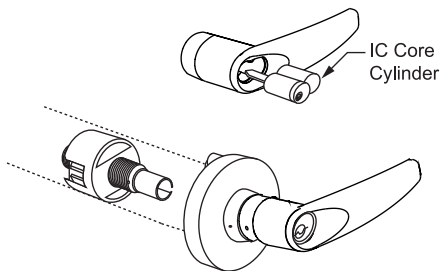

★ **Standard & HI-SECURITY™ IC Core Models:** Interchangeable Core models for 6 or 7 pin cores (not included). **Accepts:** Marks, Marks HI-SECURITY™, Medeco®, KeyMark™, Falcon, Schlage® small format & Best®. **IC Core Tailpieces ARE Included.**

