

[®]
WESTWARD



Truck Drain

Model 48UJ80 and 48UJ81

®
WESTWARD

**PLEASE READ AND SAVE
THESE INSTRUCTIONS.**

**READ CAREFULLY
BEFORE ATTEMPTING
TO ASSEMBLE, INSTALL,
OPERATE OR MAINTAIN THE
PRODUCT DESCRIBED.**

**PROTECT YOURSELF AND
OTHERS BY OBSERVING ALL
SAFETY INFORMATION. FAILURE
TO COMPLY WITH INSTRUCTIONS
COULD RESULT IN PERSONAL
INJURY AND/OR PROPERTY DAMAGE!
RETAIN INSTRUCTIONS FOR FUTURE
REFERENCE.**

**PLEASE REFER TO BACK COVER
FOR INFORMATION REGARDING
WESTWARD'S WARRANTY AND OTHER
IMPORTANT INFORMATION.**

Model #: _____

Serial #: _____

Purch. Date: _____

Printed in India

Version 03/ 2016

© 2015 W.W. Grainger, Inc.

All Rights Reserved

BEFORE YOU BEGIN



Tools needed:

- Spanner (14mm)
- Allen key (4mm)

Protection equipment (PPE) requirements:

- Goggles, Safety Gloves, Safety Helmet, and Safety Boots

UNPACKING

Steps:

1. Wear cotton gloves before unpacking.
2. Use small knife or scissor to cut tapes on the carton for opening/ unpacking. Be careful of any sharp carton edges.
3. Check to ensure all components are present.



Contents:

- 1 Drain Tank with Wheels
- 1 Discharge Hose
- 1 Steel Handle
- 1 Anti-splash Screen
- 1 Spout
- 1 Feeder Hose (Only in 48UJ81)
- 1 Rotary Pump (Only in 48UJ81)
- 2 13mm bolts
- 4 Hose Clamps (Only in 48UJ81)
- 2 Hose Clamps (Only in 48UJ80)



- See General Safety Instructions on page 2, and Cautions and Warnings as shown.



GENERAL SAFETY INSTRUCTIONS

⚠ WARNING

Do not use the truck drain without the anti splash tray to separate solid particles from the used oil.



⚠ WARNING

Connections of the hose must be secured tightly to avoid any oil leakage.



SPECIFICATIONS

Description	48UJ80	48UJ81
Truck Drain Height	7 -3/4"	7 -3/4"
Discharge Hose 80"	Yes	Yes
Feeder Hose of 15"	No	Yes
Rotary Pump Discharge	-	1 litre / 5 strokes
Steel Spout	Yes	Yes

ASSEMBLY INSTRUCTIONS FOR 48UJ80 (REFER “PARTS ILLUSTRATION” ON PAGE 6)

Steps	Image
1 Assemble the handle (4) with the base plate (5) with the help of two 13mm bolts.	
2 Connect discharge hose (1) to the tank outlet (8) which can be found beneath the tank.	
3 Connect the spout (13) with other end of discharge hose (1) using clamp.	
4 Place the hose over hose hanger (14) when not in use.	

ASSEMBLY INSTRUCTIONS FOR 48UJ81

Steps	Image
1 Remove one of the Castor (7) from the rear of the drain tank (6).	
2 Pull out the base plate (5).	



ASSEMBLY INSTRUCTIONS (CONTINUED)

- 3 Mount the rotary pump (2) assembly on to the base plate (5) using 4mm allen key.

"Please note that pump must be positioned in the same way as shown in the picture."

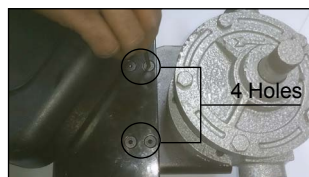

- 4 Push the Base plate (5) back and reassemble the castor (7) onto the drain tank.



- 5 Assemble the Handle (4) with the base plate (5) with the help of two 13mm bolts (included in the pack).



- 6 Take the feeder hose (9) and connect one end with the tank outlet (8) and the other end with the rotary pump (2) inlet using clamps.



- 7 Take the discharge hose (1) and connect one end with the pump outlet using clamp.



ASSEMBLY INSTRUCTIONS (CONTINUED)

- 8 Place the anti splash screen (11) on the drain tank (6).

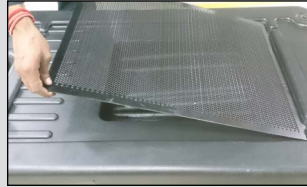

- 9 Push the pump handle onto the spindle ensuring that the adjustment knob aligns with the spindle hole.

Spindle
Hole



Adjustment
Knob

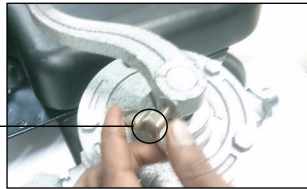

- 10 Connect the spout (13) with other end of discharge hose (1).
- 11 Place the hose over hose hanger when not in use.



TROUBLESHOOTING

Symptom	Possible Cause(s)	Corrective Action
Pump does not dispense fluid	1. Pump not able to create adequate suction	1. Prime the pump by pouring 1 to 2 oz. of any oil into the delivery port. Operate the handle till it starts dispensing
	2. Pump is drawing in air instead of fluid	2. Tighten all connections of suction tube with the drain tank & of the suction tube with pump inlet
	3. Crank is not properly connected to crank shaft	3. Loosen the grub screw on the crank. Now align it with the depression on the crank shaft & then tighten
Leakage of media from the pump shaft	Damaged seal due to use with media not suitable for use with pump	Seal needs to be replaced. Send to distributor for service repair
Leakage of media from between the cover plate & pump body	Damaged seal	Seal needs to be replaced. Send to distributor for service repair

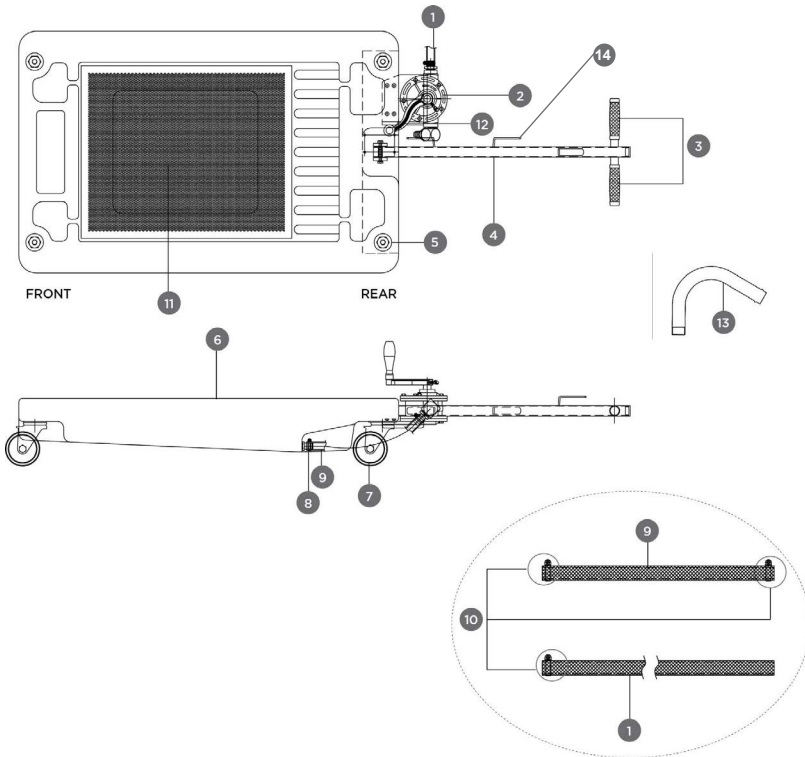
PARTS ILLUSTRATION

For Repair Parts, call 1-800-323-0620
24 hours a day – 365 days a year

Please provide following information:

- Model number
- Serial number (if any)
- Part description and number as shown in parts list

GETTING STARTED



PARTS LIST

Parts Description	48UJ80	48UJ81	QTY.
1 Discharge Hose	✓	✓	1
2 Rotary Pump Assembly	X	✓	1
3 Rubber Grip	✓	✓	2
4 Steel Handle	✓	✓	1
5 Base Plate	✓	✓	1
6 Drain Tank	✓	✓	1
7 Castor	✓	✓	4
8 Tank Outlet	✓	✓	1
9 Feeder Hose	X	✓	2
10 Hose Clamps	✓	✓	2/4
11 Anti Splash Screen	✓	✓	1
12 Pump Handle	X	✓	1
13 Spout	✓	✓	1
14 Hose Hanger	X	✓	1

SAFETY /
SPECIFICATIONSASSEMBLY /
INSTALLATION

OPERATION

TROUBLESHOOTING

MAINTENANCE /
REPAIR

WESTWARD ONE-YEAR LIMITED WARRANTY

WESTWARD ONE-YEAR LIMITED WARRANTY. All Westward® product models covered in this manual covered by this Limited Warranty are warranted by W.W. Grainger, Inc. ("Grainger") to the original user against defects in workmanship or materials under normal use for one year after date of purchase. If the Product is part of a set, only the portion that is defective is subject to this warranty. Any Product or part which is determined to be defective in material or workmanship and returned to an authorized service location, as Grainger or Grainger's designee designates, shipping costs prepaid, will be, as the exclusive remedy, repaired or replaced with a new or reconditioned product or part of equal utility or a full refund given, at Grainger's or Grainger's designee's option, at no charge. For limited warranty claim procedures, see "Warranty Service" below.

COVERED PRODUCTS. This Limited Warranty covers the product model(s) identified in this manual. This Limited Warranty does not cover normal wear and tear of Products or portions of them, or products or portions of them which are consumable in normal use. This warranty is void if there is evidence of misuse, mis-repair, mis-installation, abuse or alteration.

WARRANTY DISCLAIMERS AND LIMITATIONS OF LIABILITY RELATING TO ALL CUSTOMERS FOR ALL PRODUCTS

LIMITATION OF LIABILITY. TO THE EXTENT ALLOWABLE UNDER APPLICABLE LAW, GRAINGER'S LIABILITY FOR CONSEQUENTIAL AND INCIDENTAL DAMAGES IS EXPRESSLY DISCLAIMED. GRAINGER'S LIABILITY IN ALL EVENTS IS LIMITED TO AND SHALL NOT EXCEED THE PURCHASE PRICE PAID.

WARRANTY DISCLAIMER. A DILIGENT EFFORT HAS BEEN MADE TO PROVIDE PRODUCT INFORMATION AND ILLUSTRATE THE PRODUCTS IN THIS LITERATURE ACCURATELY; HOWEVER, SUCH INFORMATION AND ILLUSTRATIONS ARE FOR THE SOLE PURPOSE OF IDENTIFICATION, AND DO NOT EXPRESS OR IMPLY A WARRANTY THAT THE PRODUCTS ARE MERCHANTABILITY, OR FIT FOR A PARTICULAR PURPOSE, OR THAT THE PRODUCTS WILL NECESSARILY CONFORM TO THE ILLUSTRATIONS OR DESCRIPTIONS. EXCEPT AS PROVIDED BELOW, NO WARRANTY OR AFFIRMATION OF FACT, EXPRESSED OR IMPLIED, OTHER THAN AS STATED IN THE "LIMITED WARRANTY" ABOVE IS MADE OR AUTHORIZED BY GRAINGER.

PRODUCT SUITABILITY. MANY JURISDICTIONS HAVE CODES AND REGULATIONS GOVERNING SALES, CONSTRUCTION, INSTALLATION, AND/OR USE OF PRODUCTS FOR CERTAIN PURPOSES, WHICH MAY VARY FROM THOSE IN NEIGHBORING AREAS. WHILE ATTEMPTS ARE MADE TO ASSURE THAT PRODUCTS COMPLY WITH SUCH CODES, GRAINGER CANNOT GUARANTEE COMPLIANCE, AND CANNOT BE RESPONSIBLE FOR HOW THE PRODUCT IS INSTALLED OR USED. BEFORE PURCHASE AND USE OF A PRODUCT, REVIEW THE SAFETY/SPECIFICATIONS, AND ALL APPLICABLE NATIONAL AND LOCAL CODES AND REGULATIONS, AND BE SURE THAT THE PRODUCT, INSTALLATION, AND USE WILL COMPLY WITH THEM.

CONSUMERS ONLY. CERTAIN ASPECTS OF DISCLAIMERS ARE NOT APPLICABLE TO CONSUMER PRODUCTS SOLD TO CONSUMERS; (A) SOME JURISDICTIONS DO NOT ALLOW THE EXCLUSION OR LIMITATION OF INCIDENTAL OR CONSEQUENTIAL DAMAGES, SO THE ABOVE LIMITATION OR EXCLUSION MAY NOT APPLY TO YOU; (B) ALSO, SOME JURISDICTIONS DO NOT ALLOW A LIMITATION ON HOW LONG AN IMPLIED WARRANTY LASTS, SO THE ABOVE LIMITATION MAY NOT APPLY TO YOU; AND (C) BY LAW, DURING THE PERIOD OF THIS LIMITED WARRANTY, ANY IMPLIED WARRANTIES OF MERCHANTABILITY OR FITNESS FOR A PARTICULAR PURPOSE APPLICABLE TO CONSUMER PRODUCTS PURCHASED BY CONSUMERS, MAY NOT BE EXCLUDED OR OTHERWISE DISCLAIMED.

THIS LIMITED WARRANTY GIVES YOU SPECIFIC LEGAL RIGHTS, AND YOU MAY ALSO HAVE OTHER RIGHTS WHICH VARY FROM STATE TO STATE. THIS LIMITED WARRANTY ONLY APPLIES TO PRODUCTS PURCHASED BY UNITED STATES PURCHASERS FOR DELIVERY IN THE UNITED STATES.

WARRANTY SERVICE

To obtain warranty service if you purchased the covered product directly from Grainger, (i) write or call or visit the local Grainger branch from which the product was purchased or another Grainger branch near you (see www.grainger.com for a listing of Grainger branches); or (ii) contact Grainger by going to www.grainger.com and clicking on the "Contact Us" link at the top of the page, then clicking on the "Email us" link; or (iii) call Customer Care (toll free) at 1-888-361-8649. To obtain warranty service if you purchased the covered product from another distributor or retailer, (i) go to www.grainger.com for Warranty Service; (ii) write or call or visit a Grainger branch near you; or (iii) call Customer Care (toll free) at 1-888-361-8649. In any case, you will need to provide, to the extent available, the purchase date, the original invoice number, the stock number, a description of the defect and anything else specified in this Westward One-Year Limited Warranty. You may be required to send the product in for inspection at your cost. You can follow up on the progress of inspections and corrections in the same ways. Title and risk of loss pass to buyer on delivery to common carrier, so if product was damaged in transit to you, file claim with carrier, not the retailer or Grainger. For warranty information for purchasers and/or delivery outside the United States, please contact:

Canada: www.westwardtools.ca

Mexico: Grainger.com.mx

Location not listed, contact: +1-888-361-8649 (or 1-800-GRAINGER)