

Rip-Tie CinchStrap-EG

Instructions

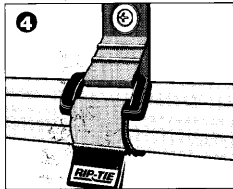
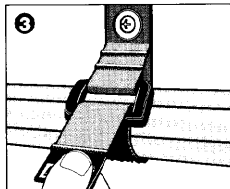
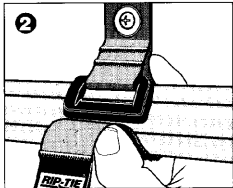
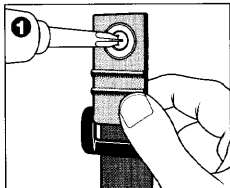

ENGLISH:

- 1 Insert screw through grommet and attach to surface with buckle hanging down.
- 2 Insert bundle between buckle and fabric.
- 3 Pull tab through from behind buckle and pull tab tight.
- 4 Press down on fabric to lock bundle in place.

ESPAÑOL:

- 1 Inserte el tornillo a través de la rondana y sujételo a la superficie con la hebilla colgando hacia abajo.
- 2 Inserte el bulto de cables entre la hebilla y el tejido.
- 3 Pase la etiqueta a través de la hebilla y apriete el bulto.
- 4 Presione sobre el tejido para asegurar el bulto.

Rip-Tie, Inc.

PO Box 549, San Leandro, CA 94577

© 2004 Rip-Tie, Inc. Specifications are subject to change without notice.
Made in U.S.A.