

INSTALLATION INSTRUCTIONS for MFA127 on H-503012 or H-503024 HEATER

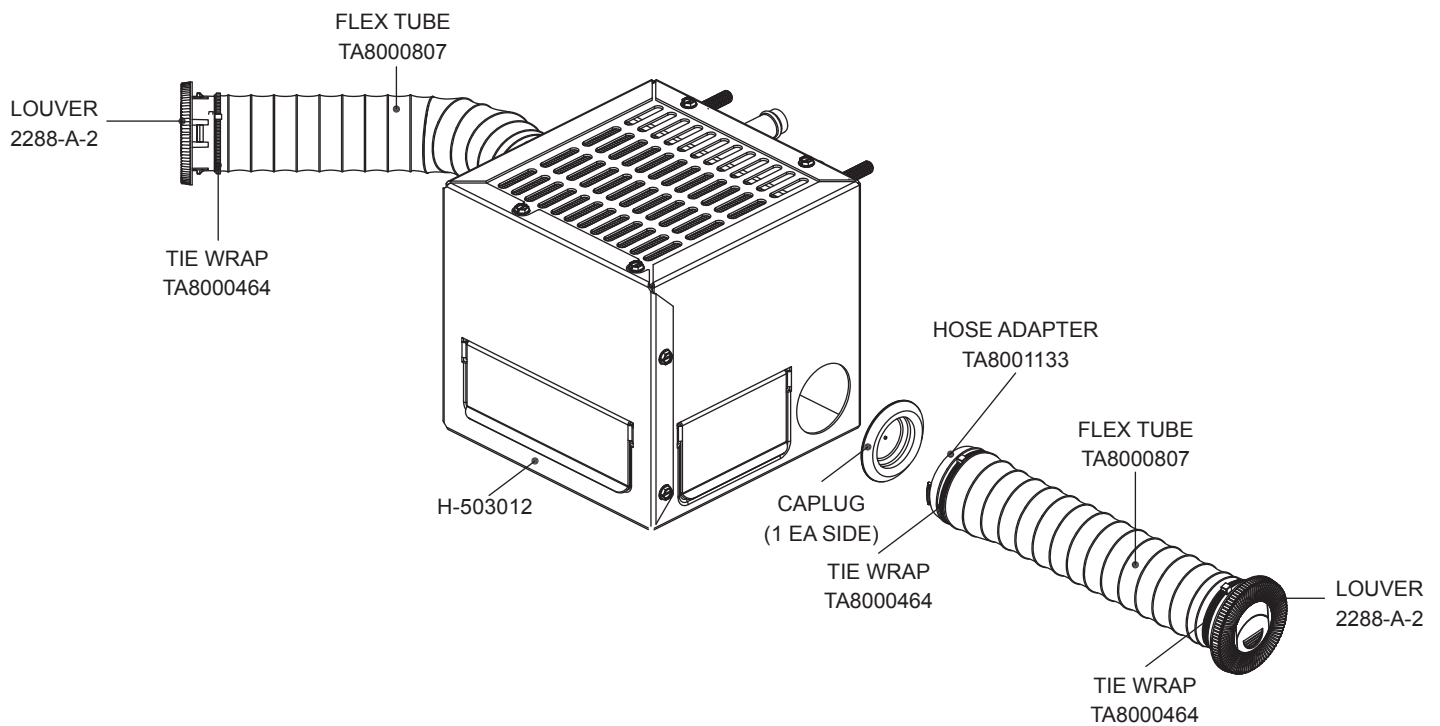

INSTALLATION PROCEDURE:

1. Assemble Flex Tube (TA8000807) over neck of Louver (2288-A-2) and secure in place with Tie Wrap (TA8000464). Assemble other end of Flex Tube over Adapter (TA8001133) and secure with Tie Wrap.
2. Repeat step 1 for opposite side. Use extra Tie Wraps (TA8000464) to secure Hose to vehicle where needed.
3. Remove Caplug from each side of Heater Housing.
4. Snap Adapter into Housing.