

# PORTABLE CANTILEVER CART - CANT-3048

APPROX WEIGHT: 176.85 lbs.  
DOES NOT INCLUDE WEIGHT OF POWER OR PACKAGING!!!

\*\*\* ANY ADDITIONS, DELETIONS, OR OMISSIONS MUST BE CORRECTED ON THIS DRAWING AS THIS DRAWING WILL BE CONSIDERED ALL INCLUSIVE \*\*\*

ALL GRAPHICS PROVIDED ARE FOR REFERENCE ONLY. IF CERTAIN DIMENSIONS ARE CRITICAL PLEASE VERIFY THOSE DIMENSIONS WITH YOUR SALESPERSON

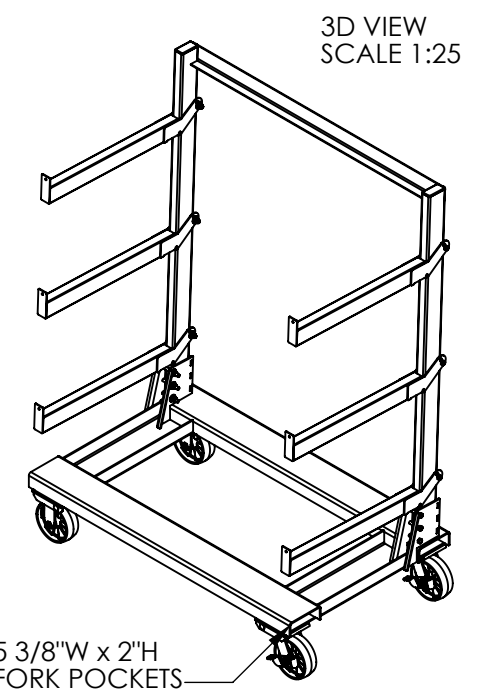
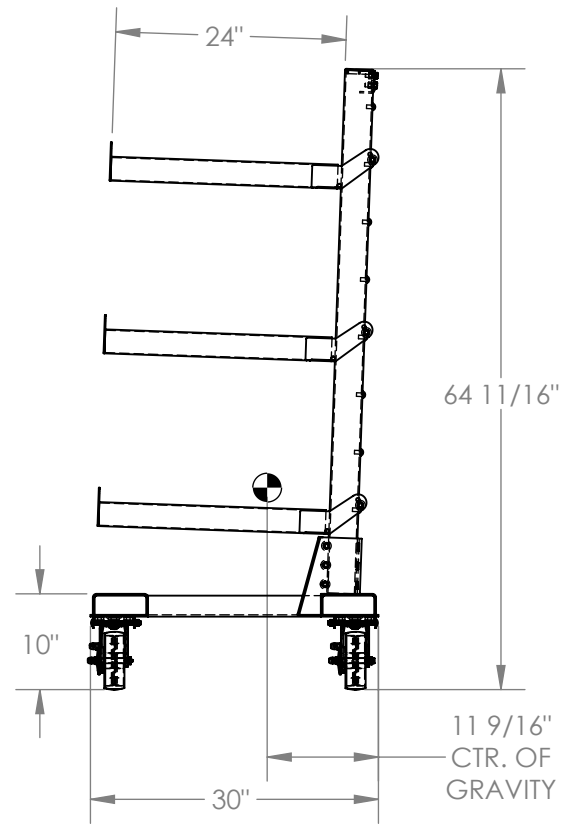
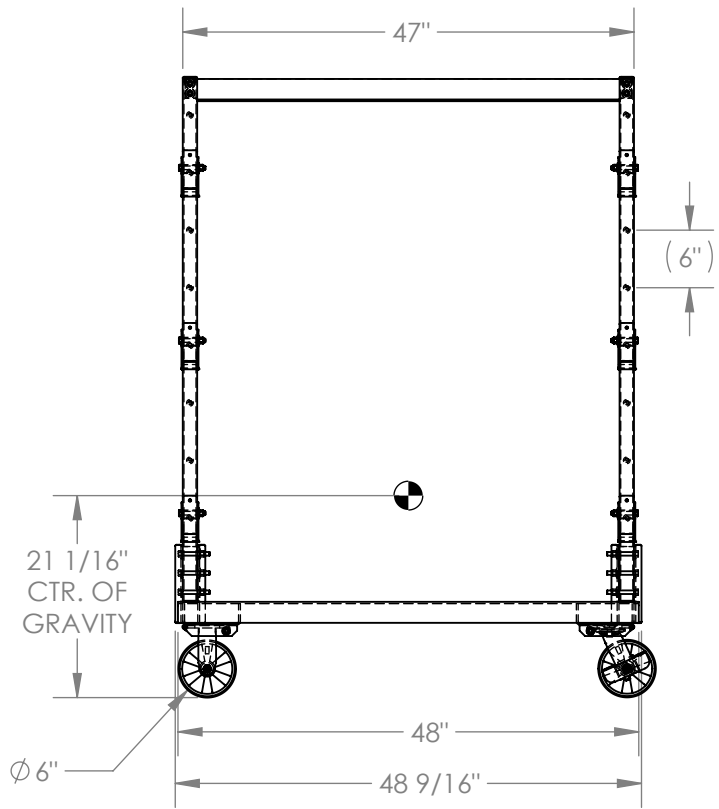

## STANDARD FEATURES

- MODEL NUMBER IS CANT-3048
- OVERALL WIDTH IS: 30"
- OVERALL LENGTH IS: 48 9/16"
- DECK LENGTH IS: 48"
- OVERALL HEIGHT IS: 64 11/16"
- USABLE ARM LENGTH IS: 24"
- MIN. SPACING BETWEEN ARMS IS: 3 1/2"
- MAXIMUM CAPACITY IS: 2,000 LBS.
- MAXIMUM CAPACITY PER PAIR OF ARMS IS: 400 LBS.
- COMES STANDARD WITH 3 PAIRS OF ARMS
- ADJUSTABLE ARM PLACEMENT IN 6" INCREMENTS
- 2-POSITION ARMS CAN BE MOUNTED AS SHOWN, OR INCLINED
- 5 3/8"W x 2"H USABLE FORK POCKETS
- INCLUDES (2) RIGID AND (2) SWIVEL W/BRAKE
- Ø6" x 2" GLASS FILLED NYLON CASTERS
- TOUGH BAKED IN POWDER COATED BLUE FINISH

## SPECIAL FEATURES

NONE

FOR INTERNAL USE ONLY  
PROJECT SIGN OFF

SALES	
ENG.	
FAB.	
POWER	

DIMENSION TOLERANCE ± 1/4"

**APPROVAL**

I, THE UNDERSIGNED, AGREE THAT THE PRODUCT AS REPRESENTED SATISFIES DESIGN AND DIMENSION REQUIREMENTS. I ALSO ACKNOWLEDGE MY DUTY TO CONFIRM PRODUCT AND INSTALLATION COMPLIANCE WITH ALL APPLICABLE FEDERAL, STATE AND LOCAL REGULATIONS AND STANDARDS.

**ANY MODIFIED UNITS ARE NON-RETURNABLE**

As drawn       As marked

Signed: \_\_\_\_\_ Date: \_\_\_\_\_

Printed Name: \_\_\_\_\_

*LEAD TIME WILL START UPON RECEIPT OF SIGNED APPROVAL DRAWING*

DISTRIBUTOR'S NAME:		P.O.#	
VESTIL MANUFACTURING		X	
DRAWN BY: TJM	DATE: 08/21/13	W.O.#	X
REFERENCE: X	SCALE: 1:20	SALES:	X
QUOTED LEAD TIME: X	QUOTE #	FILE NAME:	16-007-374
	X		

**\*\*EXTRA PAIRS OF ARMS ARE AVAILABLE FOR AN ADDITIONAL COST\*\***