

Dayton Grinder Pumps

PUMPS technical data sheet



Submersible Grinder pumps are designed to remove raw sewage wastewater from residential or commercial applications. Grinder pumps macerate solids contained in normal sewage or waste into fine slurry that can be pumped through small diameter piping to a sewage collection / treatment system for final processing. Grinder pumps can lift sewage to high elevations for pressure sewer applications.



3BB97 2 HP, Cast Iron Submersible Grinder Pump

HP	2
Voltage	240V
Phase	Single
Frequency	60 Hz
Run Amps	15A
Start Amps	53.8A
RPM	3450
Motor Type	NEMA L – Single-Phase CS / CR – Oil Filled
Overload Protection	Internal Thermal Overload
Motor Shaft Material	Stainless Steel
Motor Housing Material	Cast Iron

Motor Duty	Intermittent
Motor End Bearing	Single Row Ball
Pump End Bearing	Single Row Ball
Lubrication	Oil Lubricated
Discharge	1-1/4 Inch FNPT, Flanged, Vertical
Volute Material	Cast Iron
Base Material	Cast Iron
Impeller Type	Open Vortex
Impeller Material	Cast Iron
Hardware Material	Stainless Steel
Cutter and Ring	Hardened Rockwell C-55440 Stainless Steel
O-rings	Buna-N
Seal Type	Single Mechanical
Seal Materials	Silicon Carbide/Silicon Carbide/Buna N
Operation	Automatic / Tethered Switch
Power Cord	14/3 SOOW, 20' (6.1m), NEMA 6-15P 240V Plug
Max. Water Temperature	77°F (25°C)
Designed Fluid Environment	Water / Sewage Wastewater
Switch Type	Tethered
Switch Cord	16/2 SJOW 20' (6.1m)
Switch Plug	NEMA 6-15P Piggyback Plug
Switch Max. Run Amps	15A
Switch Max. Start Amps	85A
Switch Pumping Range	Variable – Discharge Pipe Mounted

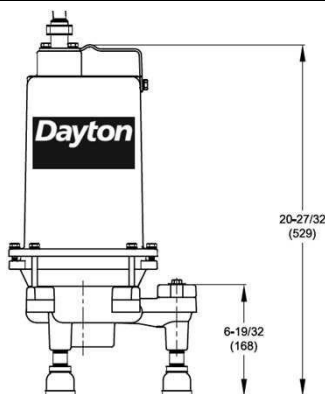

Outline Dimensions

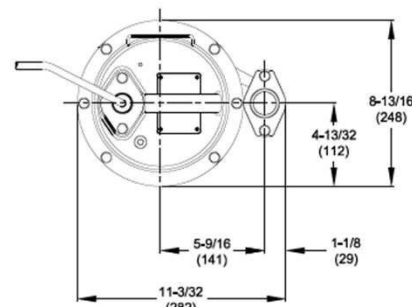

Performance Data

Head	Feet	10	20	30	40	50	60	70	80	90	100
	Meters	3.1	6.1	9.1	12.2	15.2	18.3	21.3	24.4	27.4	30.5
Flow Rate	GPM	58	58	57	57	56.5	55	48	40	28	2
	LPM	220	220	216	216	214	208	182	151	106	8

Performance Chart

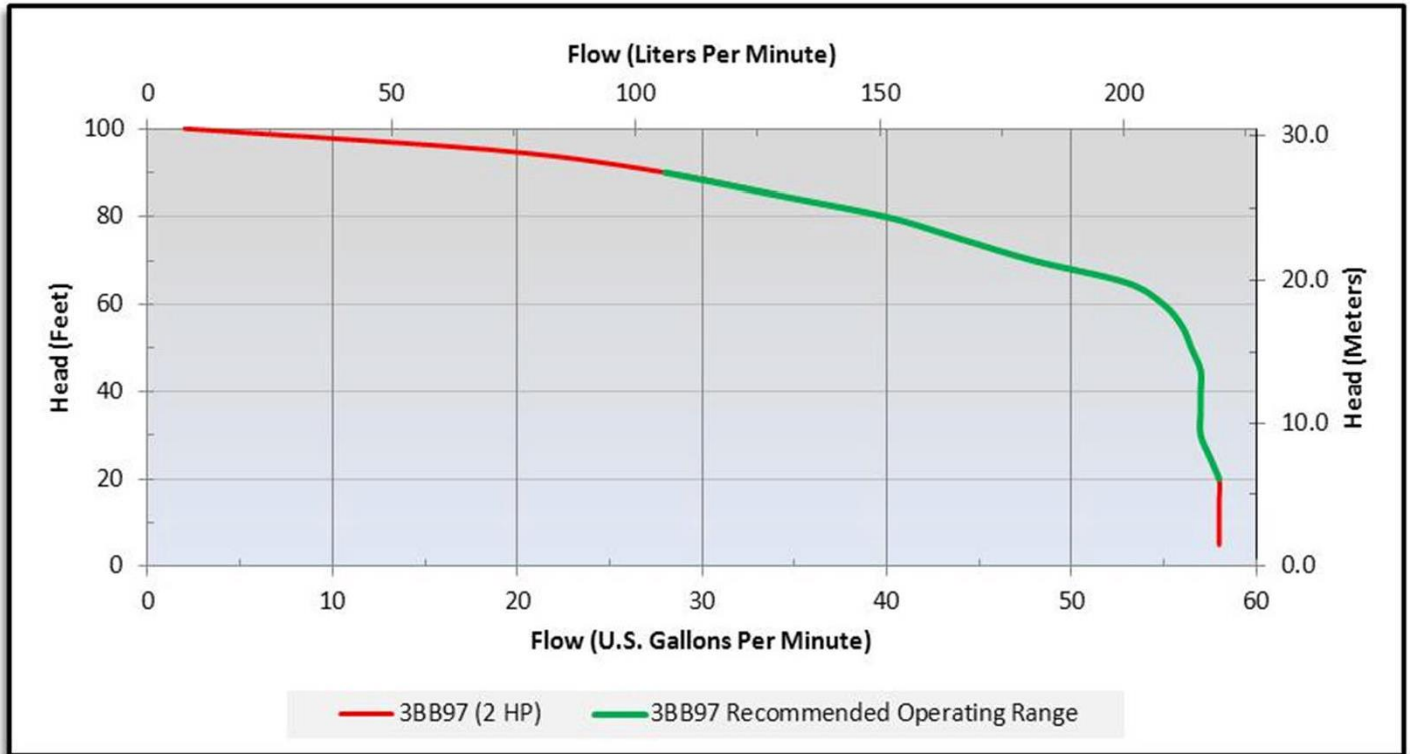

WARNING: Use only with nonflammable liquids compatible with pump component materials and in nonflammable/nonexplosive atmospheres.

Call or visit your local branch or go to www.grainger.com/daytonpumps for complete product line information



Exclusively from Grainger.