

Operating Instructions

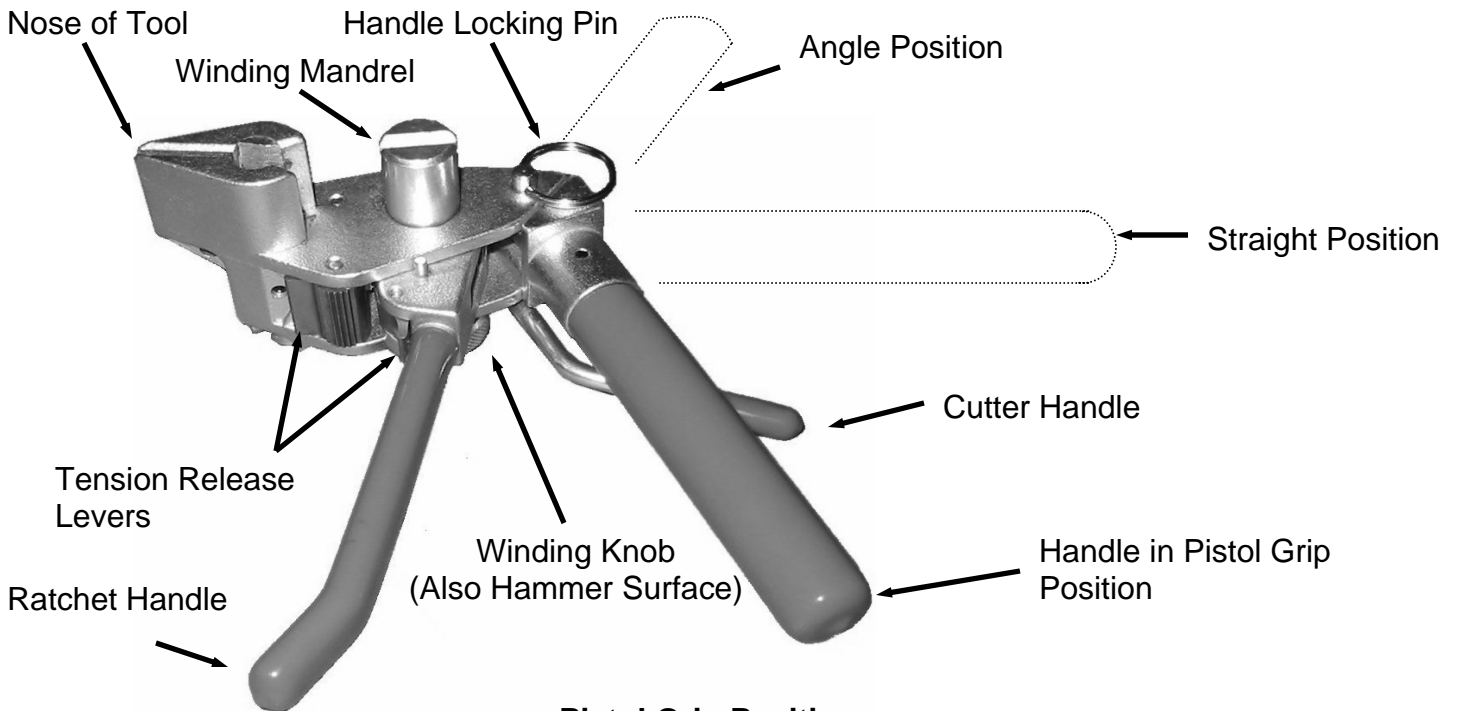

GRC075 Bantam Hand Tool



Pistol Grip Position:



1. With the Bantam Tool in the Pistol Grip Position, Place the band in the tool with sufficient band in the winding mandrel.



2. With ratcheting action, tension the band until clamp is tight. If necessary, band may be repositioned by releasing tension with levers.



3. Roll tool over as far as tool will go, and push forward cutter handle. Remove tool and tap down ears of clip to complete clamp. Remove excess material from winding mandrel.

Straight or Angle Position:



1. With the Bantam Tool in the Pistol Grip Position, Place the band in the tool with sufficient band in the winding mandrel.



2. With ratcheting action, tension the band until clamp is tight.



3. Roll tool over as far as tool will go, and push forward cutter handle. Remove tool and tap down ears of clip to complete clamp.

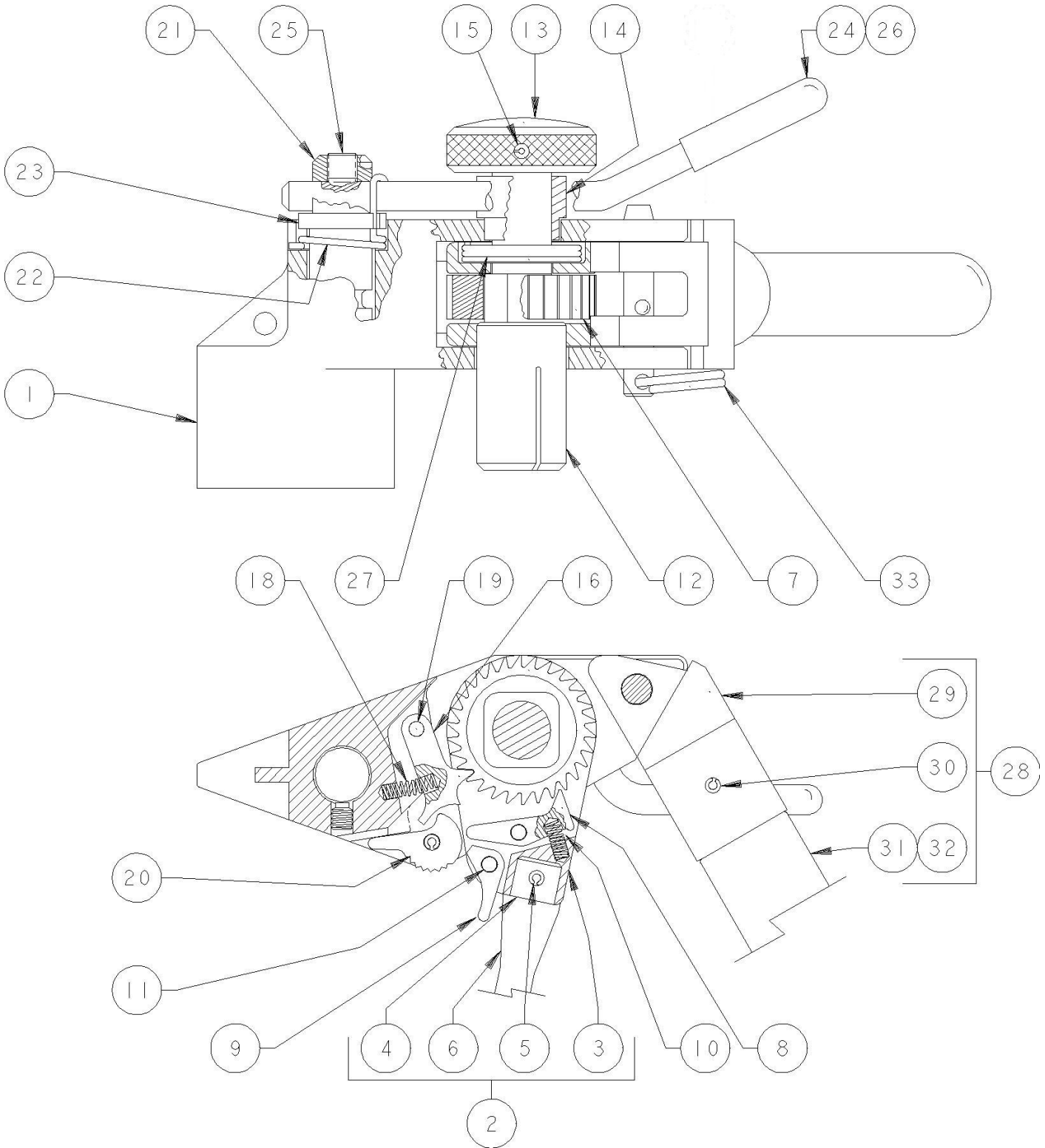

Repair Parts



GRC075 Bantam Hand Tool

| 33 | C10787 | 1 | PIN, HANDLE, LOCKING |
|------|-------------|------|---------------------------------------|
| 32 | C09887 | 1 | ...GRIP, HANDLE |
| 31 | C08187 | 1 | ...HANDLE |
| 30 | C09787 | 1 | ...PIN, SPRING, 1/8 DIA X 7/8 LONG |
| 29 | C08287 | 1 | ...ADAPTER, HANDLE |
| 28 | C11087 | 1 | HANDLE/ ADAPTER ASSEMBLY, COMBINATION |
| 27 | C09087 | 1 | SPRING, RATCHET |
| 26 | C10087 | 1 | CAP, CUTTER HANDLE |
| 25 | C72388 | 1 | SCREW, SET, 1/4-28 X 3/16 LONG |
| 24 | C08887 | 1 | HANDLE, CUTTER, STRAP, FINISHED |
| 23 | C09187 | 1 | COVER, CUTTER SPRING, FINISHED |
| 22 | C09287 | 1 | SPRING, CUTTER |
| 21 | C08787 | 1 | BLADE, CUTTER, FINISHED |
| 20 | C07187 | 1 | CAM, HOLDING PAWL |
| 19 | C09487 | 2 | PIN, GROOVED, 1/8 DIA X 1 LONG |
| 18 | C09587 | 2 | SPRING, HOLDING PAWL |
| 17 | ----- | - | ----- |
| 16 | C07387 | 2 | PAWL, HOLDING, RIGHT |
| 15 | C11287 | 2 | PIN, SPRING, 1/8 DIA X 1.25 LONG |
| 14 | C08387 | 1 | SPACER, FINISHED |
| 13 | C08487 | 1 | KNOB, WINDING, FINISHED |
| 12 | C08687 | 1 | MANDREL, WINDING, FINISHED |
| 11 | C09387 | 1 | PIN, GROOVED, 1/8 DIA X .75 LONG |
| 10 | C09687 | 1 | SPRING, TENSION PAWL |
| 9 | C07687 | 1 | CAM, TENSION PAWL |
| 8 | C07487 | 1 | PAWL, TENSION |
| 7 | C07887 | 1 | WHEEL, RATCHET |
| 6 | C09987 | 1 | ...GRIP, RATCHET |
| 5 | J02887 | 1 | ...PIN, SPRING, 1/8 DIA X 3/4 LONG |
| 4 | C07987 | 1 | ...HANDLE, RATCHET, COMBINATION |
| 3 | C07787 | 1 | ...HOUSING, RATCHET |
| 2 | C10887 | 1 | HANDLE/HOUSING ASSEMBLY, COMBINATION |
| 1 | C06987 | 1 | BODY, FINISHED |
| ITEM | PART NUMBER | QTY. | DESCRIPTION |

Warranty



GRC075
Bantam Hand Tool

Refer to website for warranty information: <http://www.band-it-idex.com/warranty.html>

COVERED UNDER PATENT # 4.570,340