

Please read and save these instructions. Read through this owner's manual carefully before using product. Protect yourself and others by observing all safety information, warnings, and cautions. Failure to comply with instructions could result in personal injury and/or damage to product or property. Please retain instructions for future reference.



1/4" Enclosed Industrial Hose Reel

Description

SPEEDAIRE Enclosed Industrial Hose Reels have an internal spring for automatic hose rewind and a locking ratchet to maintain desired hose position while in use. These general industrial, low pressure, auto retractable hose reels have multiple mounting positions for various applications. These hose reels are protected by a coated steel housing that helps extend the life of the reel, hose and internal mechanism.



Unpacking

After unpacking the unit, inspect components for damage that may have occurred during transit.

Specifications and Dimensions

Model	Maximum Operating Pressure (PSI)	Hose Dimensions		Hose Reel Dimensions			Weight (Pounds)	Hose Outlet Connection NPT Male (Inch)	Reel Inlet Connection NPT Female (Inch)	Maximum Operating Temperatures (Fahrenheit)
		I.D (Inch)	Length (Feet)	Length (Inch)	Width (Inch)	Height (Inch)				
2CUD6	200	1/4	20	8.66	2.36	7.87	3.1	1/4	1/4	165

General Safety Information

1. Make sure incoming line pressure does not exceed maximum rated operating pressure for your hose reel model.
2. Use proper eye protection when assembling and using the hose reel.
3. Keep children away from the work area, a recoiling hose has surprising force.
4. Never let the hose retract without holding on to it.

Read the following precautions and instructions before you begin assembly or using. Failure to comply with these instructions could result in personal injury or property damage.

Keep these instructions in a convenient location for future reference.

▲ CAUTION -Do not open the housing because the rewind spring can unwind with great force and cause injury.

▲ WARNING - Do not use if the pressure exceeds 200PSI



1/4" Enclosed Industrial Hose Reel

Installation

Refer to the exploded view diagram on page 4 for assistance in component identification during installation.

Reel Installation

- 1) After selecting your mounting position, check to see if the assembly frame (#4) is in the correct position or if it needs repositioning. There are three raised nubs that can engage the assembly frame to allow the hose to be pulled out easier. See Figure 1 below.
- 2) If necessary, remove the screw from the assembly frame and reposition it. Then tighten the screw.

FIGURE 1 Reel Mounting Positions

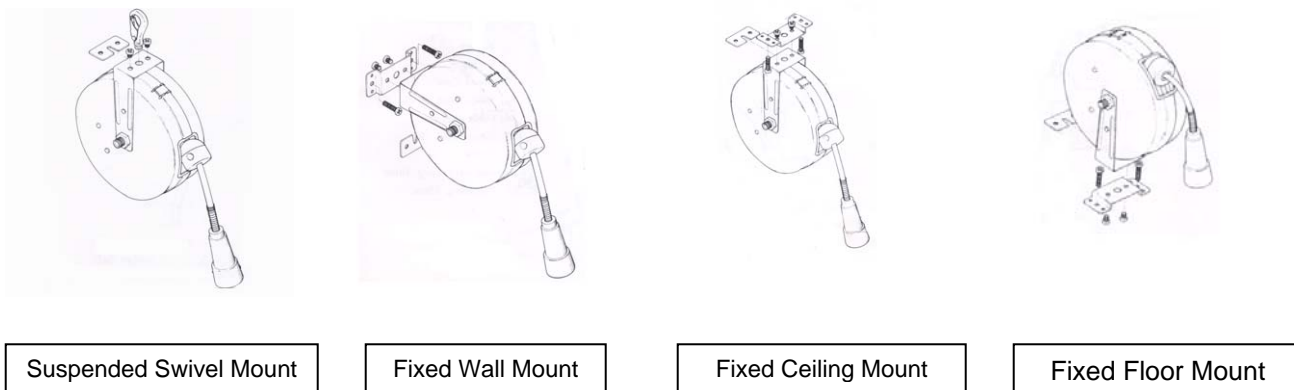

Suspended Swivel Mounting

- 1) Slip the sling hook (#1) into the assembly frame (#4).
- 2) Slide the locking plate (#2) under the hanging frame and around the sling hook.
- 3) Use the two machine screws and nuts to fasten the hanging frame and the locking plate together.
- 4) The reel is ready to be suspended by the hook.

Fixed Direction Mounting

Screws for mounting this reel to wooden beams have been provided. Mounting reel to other surfaces requires customer supplied application specific mounting hardware.

- 1) Mount the assembly piece (#3) using the 4 wood screws provided. Orient the assembly piece so the raised center is not touching the mounting surface.
- 2) Use the two machine screws and nuts to connect the assembly frame to the assembly piece.



1/4" Enclosed Industrial Hose Reel

Reel Assembly and Connection

1) Apply pipe sealant to threads on the reel supply line, attach line to reel inlet and tighten.

▲ WARNING Use a section of flexible hose only to connect reel inlet. Do not use rigid plumbing.

2) Apply pipe sealant to outlet fitting of hose, then attach to desired tool, nozzle, or quick connect fitting.

3) Use soapy water to check connection for leakage, also check that hose reel will stay extended and will retract.

4) If hose stopper adjustment is required, pull hose from reel and latch at desired "retracted" length. Loosen stopper bolts and slide stopper to a position near the hose guide roller bracket. Tighten stopper bolts, and unlatch the reel.

LIMITED ONE YEAR WARRANTY

Should a Speedaire Hose Reel fail to perform satisfactorily due to defect or poor workmanship within one year of purchase, return it to your place of purchase and it will be replaced or repaired free of charge. Incidental or consequential damages are excluded from this warranty.



1/4" Enclosed Industrial Hose Reel

Note: This diagram and components list is a reference for product installation only.

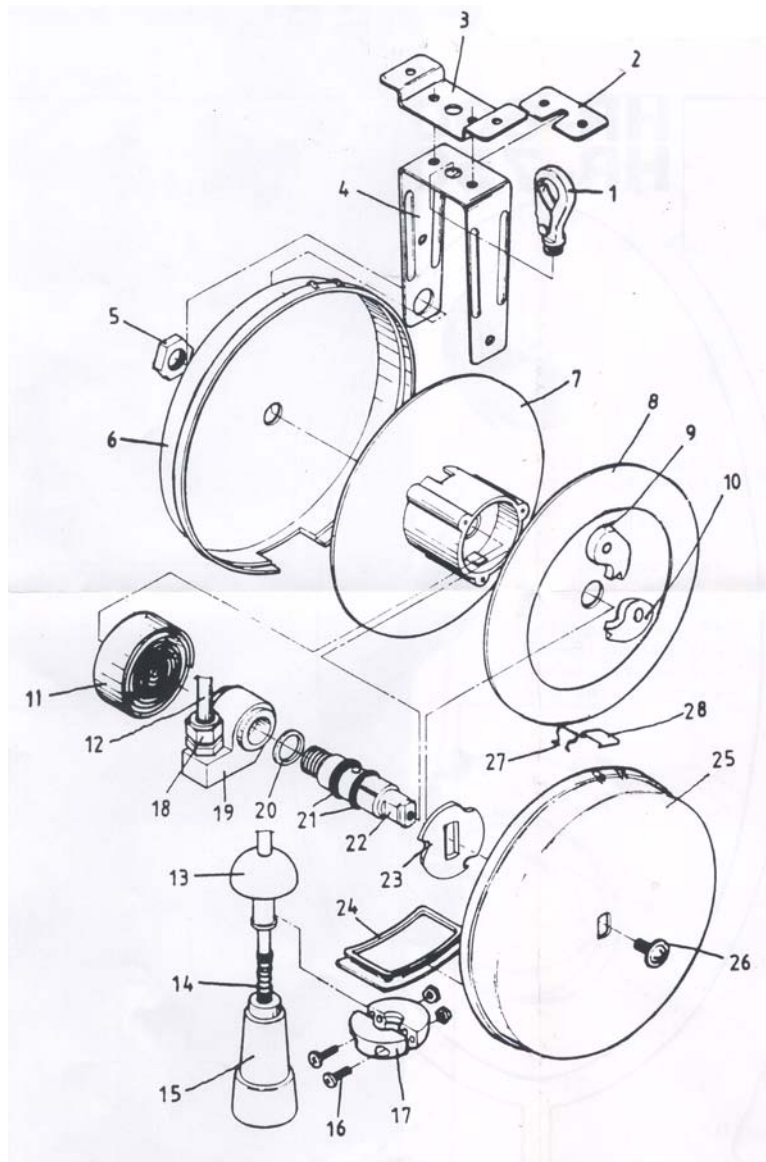

- | | |
|----|-----------------------|
| 1 | Sling Hook |
| 2 | Locking Piece |
| 3 | Assembly Piece |
| 4 | Assembly Frame |
| 5 | Hexagonal Screw |
| 6 | Outer Shell |
| 7 | Wheel Disc seat |
| 8 | Wheel Disc Cove |
| 9 | Snap Tooth |
| 10 | Snap Tooth |
| 11 | Spring Sheet |
| 12 | Air Tube |
| 13 | Fixing Rubber Ball |
| 14 | Spring Sheet |
| 15 | Protective Casing |
| 16 | Screw |
| 17 | Fixing Clamp Piece |
| 18 | Air Intake Screw |
| 19 | Calve Seat |
| 20 | Washer |
| 21 | O-ring |
| 22 | Wheel Core |
| 23 | Snap Tooth Block |
| 24 | Guide Piece |
| 25 | Outer Shell |
| 26 | Screw |
| 27 | Auxiliary Sling Valve |
| 28 | Fastening Piece |

Manufactured for Grainger International, Inc.
100 Grainger Parkway., Lake Forest, IL 60045 USA

