

EXP-110SS

REVISION: A
ECO NO.: 2944
BY: J. KUSBEL
DATE: 7/18/2012

COXREELS

1125 SS CRANK SERIES

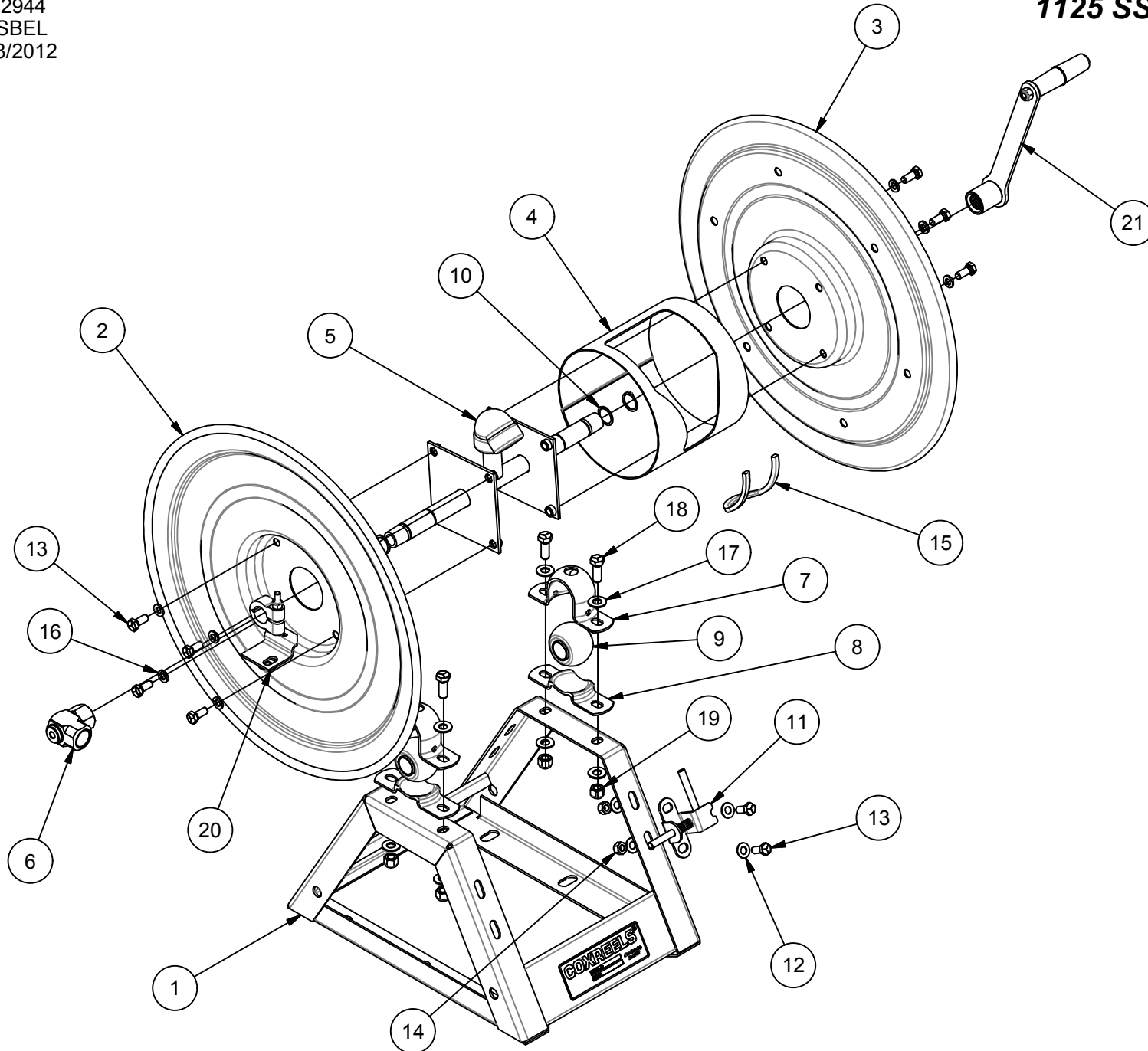

EXP-110SS

COMMON PARTS TO ALL 1125 SS CRANK SERIES REELS

ITEM NO.	PART NO.	DESCRIPTION	QTY REQ'D
7	20064-T	PILLOW BLOCK, MTG, TOP	2
8	20064-B	PILLOW BLOCK, MTG, BOTTOM	2
11	20843-SS	ASSY, LOCK PIN	1
12	20171-SS	WASHER, FLAT, 5/16"	4
13	312-SS	BOLT, 5/16-18 X 3/4" LG.	10
14	111-SS	NUT, LOCKING, 5/16"	2
16	112-SS	WASHER, LOCK, 5/16"	8
17	157-SS	WASHER, FLAT, 3/8"	8
18	20016-SS	BOLT, 3/8-16 X 1" LG.	4
19	435-SS	NUT, LOCKING, 3/8"	4

ITEM NUMBER

MODEL NO.	1	2	3	4	5	6	9	10	15	20	21
	FRAME	DISC SWIVEL SIDE	DISC CRANK SIDE	CENTER DRUM	AXLE ASSY	SWIVEL	BEARING QTY (2)	RETAINING RING (4)	TRIM	DRAG BRAKE ASSY	HAND CRANK
1125-4-100-SP	7455-6-SS-U	7415-SS-U	7416-SS-U	7414-6-SS-U	7408-6-SS	434-SS	20649	153-SS	7460-10	7429-4-SS	7419-1-SS
1125-4-100-SS	7455-6-SS	7415-SS	7416-SS	7414-6-SS	7408-6-SS	434-SS	20649	153-SS	7460-10	7429-4-SS	7419-1-SS
1125-4-200-SP	7455-12-SS-U	7415-SS-U	7416-SS-U	7414-12-SS-U	7408-12-SS	434-SS	20649	153-SS	7460-10	7429-4-SS	7419-1-SS
1125-4-200-SS	7455-12-SS	7415-SS	7416-SS	7414-12-SS	7408-12-SS	434-SS	20649	153-SS	7460-10	7429-4-SS	7419-1-SS
1125-5-100-SP	7455-12-SS-U	7415-SS-U	7416-SS-U	7414-12-SS-U	7413-12-SS	426-SS	15515	15015-SS	7460-10	7429-5-SS	7421-1-SS
1125-5-100-SS	7455-12-SS	7415-SS	7416-SS	7414-12-SS	7413-12-SS	426-SS	15515	15015-SS	7460-10	7429-5-SS	7421-1-SS
1125-5-200-SP	7455-24-SS-U	7415-SS-U	7416-SS-U	7414-24-SS-U	7413-24-SS	426-SS	15515	15015-SS	7460-10	7429-5-SS	7421-1-SS
1125-5-200-SS	7455-24-SS	7415-SS	7416-SS	7414-24-SS	7413-24-SS	426-SS	15515	15015-SS	7460-10	7429-5-SS	7421-1-SS

NOTE: MODEL NUMBERS WITH AN "SS" SUFFIX WILL HAVE AN ELECTRO-POLISHED FINISH ON THE FRAME, DISCS, AND CENTER DRUM.
 MODEL NUMBERS WITH AN "SP" SUFFIX WILL HAVE UNFINISHED STAINLESS STEEL ON THE FRAME, DISCS, AND CENTER DRUM.