

M-6164 2

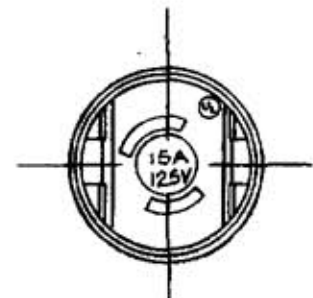
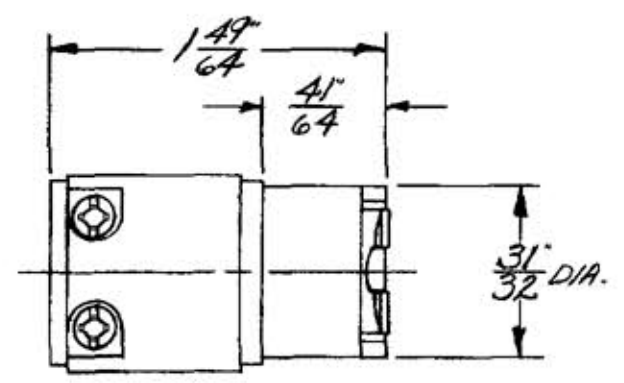
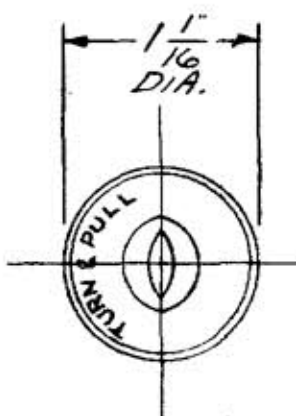
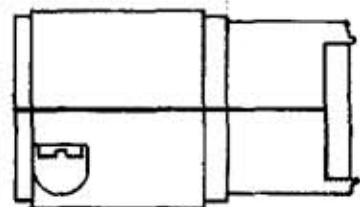

LIST OF PARTS

DESCRIPTION	MATERIAL	FINISH
HOUSING	NYLON	BLACK
CONTACT SPRINGS	BRASS	1-WHITE
WIRE CLAMP	STEEL	NICKEL PL.
BINDING HD. SCREWS	STEEL	1-WHITE
PAN HD. SCREWS	STEEL	BLACK OX.

DIMENSION SHEET FOR CAT. NO. 7464-Y

REPAIRABLE NON-REPAIRABLE

SYM	REVISIONS	APP	DATE
2	REVISED SCREW TO TRIDRIVE DCN 7978 RCM	DR	11/16/00
1	REMOVE TOLE FROM CAT. NO. 504 DCN 1258	CJC	6-19-92 JVL

B M-6164 2

TITLE
15A. 125V. AC. OR D.C. 2 WIRE
MIDGET TWIST-LOCK
VALISE CONNECTOR BODY

TOLERANCES UNLESS OTHERWISE SPECIFIED
FRACTIONS ± 1/64
DECIMALS ± .005
ANGLES ± 2°

HARVEY HUBBELL, INC.
BRIDGEPORT, CONN.
DR. BY MTK APP. BY _____
TR. BY _____ SCALE 1:1
CHK'D. BY _____ DATE 2-22-79

CODE 74545