

M-5960

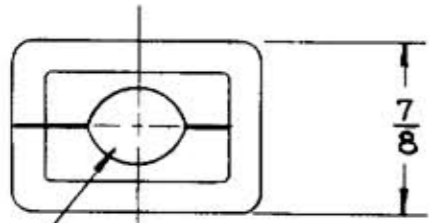

CORD CLAMPS TAKE CORDS
FROM $13/64$ TO $13/32$ DIA.

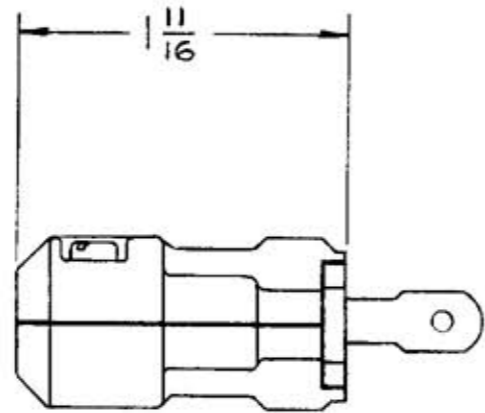
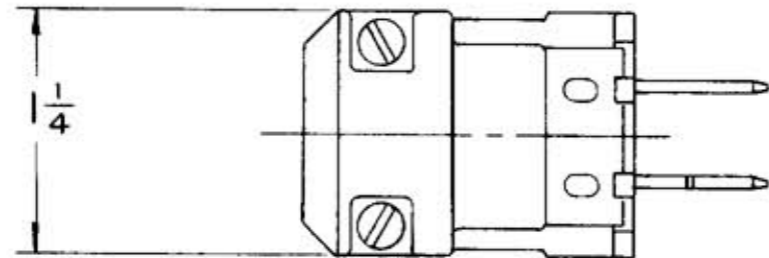
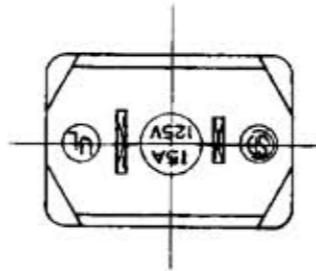

LIST OF PARTS

DESCRIPTION	MATERIAL	FINISH
HOUSING	NYLON	YELLOW
CONTACT BLADES	BRASS	I-WHITE
WIRE CLAMPING NUT	STEEL	NICKEL PL.
BINDING HD. SCREWS	STEEL	I-WHITE
CORD CLAMP SCREWS	STEEL	YELL. CHRO.

DIMENSION SHEET FOR CAT. NO. 5866-Y
 REPAIRABLE NON-REPAIRABLE
 B
M-5960

SYM	REVISIONS	APP	DATE

TITLE
15 A. 125 V. 2 WIRE DEAD FRONT
VALISE PLUG POLARIZED

TOLERANCES UNLESS OTHERWISE SPECIFIED		HARVEY HUBBELL, INC.	
FRACTIONS ± 1/64		BRIDGEPORT, CONN.	
DECIMALS ± .005		DR. BY <u>ASM</u>	APP. BY
ANGLES ± 2°		TR. BY	SCALE <u>F.I.L.</u>
		CHK'D. BY	DATE <u>5-5-77</u>