



- Industry's First Keystone VGA Connection
- Screw Termination Reduces Installation Time
- High Quality SVGA Style Video Signal
- Customize Point to Point Runs on Site

FEATURES

- Locate a VGA connection by snapping a front loading, high-density DB15 VGA style connection into a keystone opening
- Connector supports signal transmission over 20-28 AWG, 5 mini-coaxial cable
- An easy way to run a VGA style application when depth and capacity are an issue

SPECIFICATIONS

- Connector: 15-pin, VGA style, female connector, gold plated 2μ"
- Screw terminal: phosphor bronze with tin plating over nickel under plating
- Material: high impact thermoplastic

PERFORMANCE

- Electrical:

Distance limitations:	100 Feet = 800 x 600
Hubbell approved cable	75 Feet = 1224 x 768
	50 Feet = 1280 x 1024
- Cable type:
 - RGBVH, 75 Ohm 20-28 AWG-5 mini coax.
 - computer/monitor cable, 75 Ohm 20-28 AWG-3 mini coax with at least two twisted pairs
- Mechanical: nose contact: 250 insertions

STANDARDS

- UL Listed 1863
- RoHS Compliant

HUBBELL iSTATION Keystone VGA Screw Terminal Connector

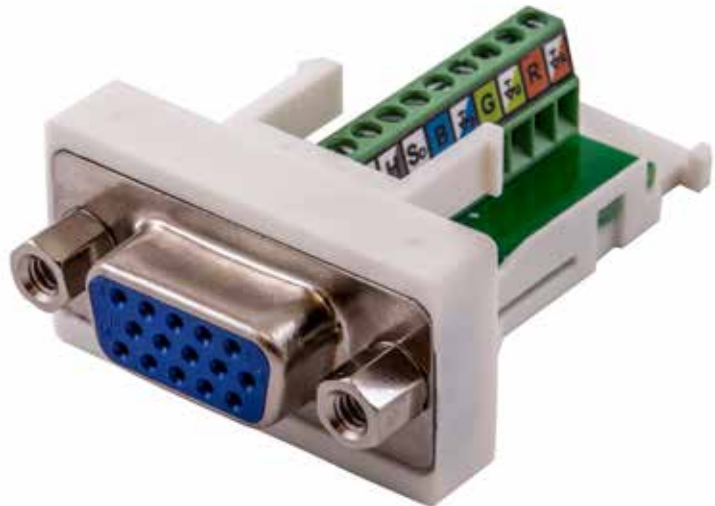

This front loading, high-density DB15 VGA style connection, integrated into a Hubbell iSTATION snap fit format is an Industry first. Providing flexibility and ease-of-use for VGA applications, the VGA front loading, screw terminal, snap fit is designed to interface with standard Hubbell keystone face plates.

The Hubbell iSTATION snap fit features a simple screw terminal field termination, eliminating the need for crimping and soldering, providing a simplistic means for running a VGA style application when depth and capacity are an issue. The high performance, high quality video connection is designed for minimal signal loss, delivering a transparent video stream to the viewing device, over 5 mini-coaxial cable.

Create a customized multimedia workstation outlet by adding a high-density DB15 screw termination connector with a product from Hubbell's extensive line of AV connectors, iSTATION modules and jacks.

GENERAL INFORMATION

- Important: Always allow for clearance behind connection location to ensure for proper bend radius.

APPLICATIONS

- VGA, SVGA, XGA, SXGA
- Computer, Projector, Monitor, Flat Panel TV, Smart-Board



ORDERING INFORMATION

Hubbell iSTATION VGA Screw Terminal Connector

Description	Color	Catalog Number
Front loading, 15-pin, female keystone connector	White	SF15ST



DIMENSIONS

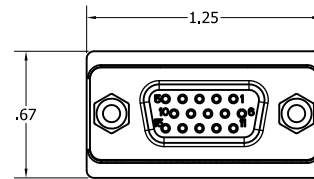
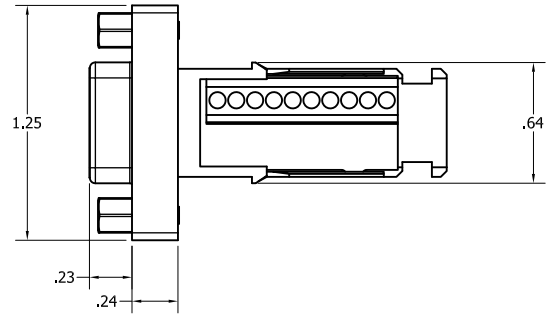

3.5mm Stereo Jacks

Unit of Measure	3.5mm to Solder	3.5mm to Screw Terminal	3.5mm Pass-Thru, F/F Coupler	3.5mm Pass-Thru, Gold, F/F Coupler	3.5mm to 110 Termination
1 per bag	SF35SJxx	SF35STxx	SF35FFxx	SF35GFFxx	SF35110BK

xx = Color: **AL** (Almond), **BK** (Black), **EI** (Electric Ivory), **GY** (Gray), **OW** (Office White), and **W** (White)

ACCESSORIES

IFP Faceplates, Single Gang

Unit of Measure	1-Port	2-Port
1 per bag	IFP11xx	IFP12xx



xx = Color: **AL** (Almond), **BK** (Black), **EI** (Electric Ivory), **GY** (Gray), **OW** (Office White), and **W** (White)

Hubbell iSTATION Modular Face Plate Frames

	1-Gang	2-Gang
Office White	IMF1xx	IMF2xx



xx = Color: **AL** (Almond), **BK** (Black), **EI** (Electric Ivory), **GY** (Gray), **OW** (Office White), and **W** (White)

HDMI 110 Extender Modules

Description	Catalog Number
110 UTP 2-unit HDMI extender (pair)	IMH110ST2xx



xx = Color: **BK** (Black), **EI** (Electric Ivory), **GY** (Gray), **OW** (Office White), and **W** (White)

Hubbell iSTATION Keystone Modules

Description	Catalog Number
Keystone, 2-port, flat, 1-unit	IM2K1xx



xx = Color: **AL** (Almond), **BK** (Black), **EI** (Electric Ivory), **GY** (Gray), **OW** (Office White), and **W** (White)

