

# INCANDESCENT



## Floodlight Series *Lifetime Guarantee Against Rust and Corrosion. 150 Watts Maximum*

Designed specifically to withstand the corrosive atmosphere of coastal areas, these directional floodlights can weather the most severe environments. **Rustproof.** These versatile luminaires are constructed of virtually unbreakable, nonconductive **polycarbonate** and provided with stainless steel hardware. Perfectly suited for landscape, flood, and spot lighting. Surface Mount Wiring Box accessory eliminates the need for a recessed junction box in wall and ceiling installations.

### Specifications

<b>Socket Housing/Cover:</b>	Injection molded of UV-stabilized <b>polycarbonate</b> . Lampholders on Model 201 rotate independently. Threaded pivot of Model 150 is .50" NPT.
<b>Socket:</b>	High-temperature phenolic with medium base nickel-plated copper screw shell. Rated 250V, 660W, with wire leads insulated to 105°C.
<b>Gasket:</b>	Silicone rubber washer (.125" thick) is permanently secured within lampholder to seal socket and wireway from moisture with insertion of lamp. Fiber washers provide watertight seal between pivot joints.
<b>Hardware:</b>	Stainless steel phillips truss head screw and wing nut allow angular adjustment to all lampholders. Crossbar and stainless steel mounting screw included with Models 101 and 201. NPT nylon locknut (.50") included with Model 150.
<b>Lamp:</b>	Provided by others. Uses brass-skirted Par 38 lamp. 150 watts maximum. Recommended lamp: 90 watt Halogen 130 volt for greater efficiency and longer lamp life.
<b>Hood: (optional)</b>	One piece, injection molded UV-stabilized <b>polycarbonate</b> . Snap-fit mounting requires no tools or hardware. Helps with light control. Adds an aesthetic value to any application. (Recommended for Lamp-up applications.)
<b>Surface Mount Wiring Box: (optional)</b>	For Models 101 and 201 only. One piece injection molded of UV-stabilized <b>polycarbonate</b> . Measures .625" deep. Includes .125" thick closed-cell neoprene rubber gasket to seal against moisture and contaminants. Easily attaches with screws or nails.

### ETL-US Listed For Wet Locations.

All polycarbonate components meet Underwriters Laboratories 746C tests for polymeric material and carry a flammability rating of 94-5V.

Luminaire Type \_\_\_\_\_  
 Catalog Number \_\_\_\_\_  
 Job Name \_\_\_\_\_  
 Approval \_\_\_\_\_

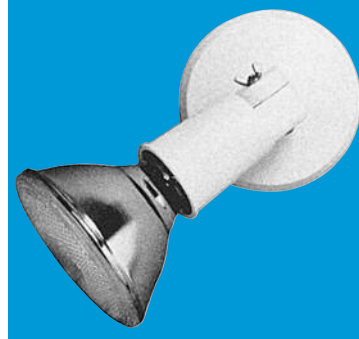

101-W Shown in White



150-W Shown in White

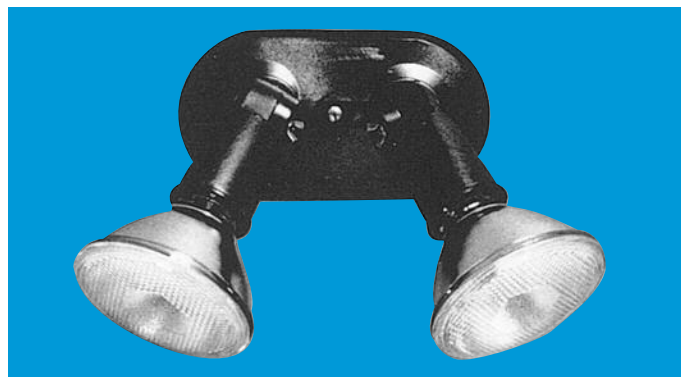

201-BK Shown in Black

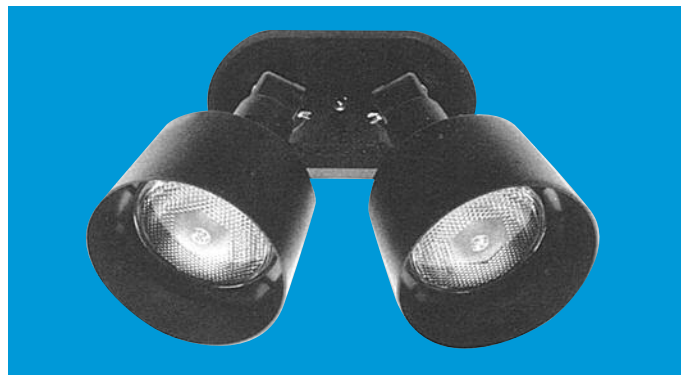

201-BK with Two 400-BK Hoods (Black)



1BW Surface Mount Wiring Box (White)



2BW Surface Mount Wiring Box (White)

**WF Harris Lighting**

Innovative Lighting Designs Since 1970

Form 1535 12/15

*"A Live Operator Company Standing Ready to Serve Your Lighting Needs"*

# INCANDESCENT

## Ordering Information (Fill In Blanks For Complete Catalog Number)

Model Model	Color	Options Color	Option	Accessories (Order separately)
101 Single Floodlight 150 Threaded Floodlight 201 Double Floodlight		<b>BK</b> -Black <b>W</b> -White <b>BZ</b> -Bronze	<b>PC</b> -Photo Control (Model 201 Only) <b>MD</b> -Motion Detector for (White Floodlights only)	<b>HOOD</b> (Model 201 Requires Two) <b>400BK</b> -Black <b>400W</b> -White <b>400BZ</b> -Bronze <b>SURFACE MOUNT WIRING BOX FOR MODEL 101</b> <b>1BK</b> -Black <b>1BW</b> -White <b>1BZ</b> -Bronze <b>SURFACE MOUNT WIRING BOX FOR MODEL 201</b> <b>2BK</b> -Black <b>2BW</b> -White <b>2BZ</b> -Bronze



Model 201 Shown  
With Photo Control



Model 101 Shown With  
Surface Mount Wiring Box



Model 201 Shown With  
Surface Mount Wiring Box

## Dimensions

Model 201

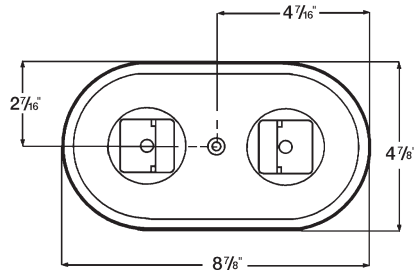

Surface Mount Wiring  
Box For Model 201

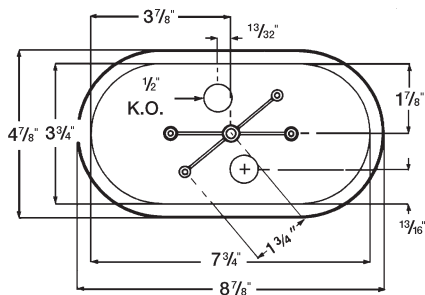

Model 101

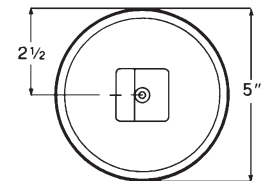

Surface Mount Wiring  
Box For Model 101

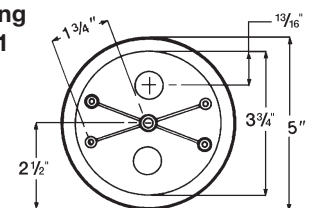

Specifications Subject to Change Without Notice

Luminaire is Warranted to be Free of Defects in Materials and Workmanship for One Year From Invoice Date.

**HOUSING / HOOD CARRY A LIFETIME WARRANTY.**



Printed in USA

Form 1535

12/15

## WF Harris Lighting

**Innovative Lighting Designs Since 1970**

P.O. Box 5023, Monroe, NC 28111-5023, USA  
(704) 283-7477 (OPERATOR ASSIST) • (704) 283-6880 (FAX)  
(800) 842-9345 (TOLL FREE)

e-mail: [customerservice@wfharris.com](mailto:customerservice@wfharris.com)  
[www.wfharrislighting.com](http://www.wfharrislighting.com)

*"W. F. Harris Lighting Will Not Sacrifice Quality for the Sake of Price."*