

# Wooden Box Heater

- 1500 Watts with Two Heat Settings
- Automatic Thermostat
- Tip-Over Switch
- Overheat Thermal Cut-Off Protection
- Room Temperature LED Display
- Precision Temperature Control
- Easy Push-Button Controls
- Remote Control



**Model No.: 12H976**

Owner's Manual  
PLEASE READ AND  
SAVE THESE INSTRUCTIONS



## CONGRATULATIONS!

The heater you have just purchased is a safe and powerful heater, designed to heat a room after a few minutes of operation. The far-infrared Quartz-PTC heating system is an excellent system for safely heating whole rooms, while saving on heating bills.

Additionally, this heater includes an overheat protection system, and an inlet air overheat protection system designed to ensure your safety.

This heater does not reduce humidity or oxygen in your home or office giving you and your family better health!

Before using your heater, please take a few minutes to read these instructions and review the product limited warranty.

Thank you!

**WARNING!** To reduce the risk of fire, electric shock, or personal injury, read all the instructions before using this heater. This appliance is intended for household or personal use only as described in this manual. Any other use including but not limited to commercial, agricultural, or outdoor use, is not recommended by the manufacturer and may cause fire, electric shock, injury and/or damages.

**CAUTION-** High temperature, keep electrical cords, drapery, and other furnishings at least 3 feet (0.9m) from the front and rear of the heater outlet.

## IMPORTANT INSTRUCTIONS

When using this appliance, basic precautions should always be followed to reduce the risk of fire, electric shock and injury to persons.

1. Read all the instructions before using this heater. Use this heater only as described in this manual. Any other use not recommended by the manufacturer may cause fire, electric shock, or injury to persons.
2. The outlet of this heater is hot when in use. To avoid burns, do not let bare skin touch hot outlet. Keep combustible materials, such as furniture, pillows, bedding, papers, clothes, and curtains at least 3 feet (0.9m) from the front and rear of the heater outlet and keep them away from the sides.
3. Extreme caution is necessary when any heater is used by or near children or persons with physical challenges and whenever the heater is left operating and unattended.
4. Do not operate the heater with a damaged cord or plug, or after the heater malfunctions, has been dropped, or damaged in any manner.
5. Do not use outdoors.
6. This heater is not intended for use

in bathrooms, laundry areas, or similar indoor locations. Never locate the heater where it may fall into a bathtub or other water container.

7. Do not run the cord under carpeting and do not cover the cord with throw rugs, runners or the like. Arrange the cord away from traffic areas and where it will not be tripped over.
8. To disconnect heater, turn controls to OFF, then remove plug from outlet.
9. Do not insert or allow foreign objects to enter any ventilation or exhaust opening as this may cause an electric shock, fire, or damage to the heater.
10. Connect to properly grounded outlets only.
11. To prevent a possible fire, do not block air intakes or exhaust openings in any manner. Do not use on soft surfaces, like a bed, where openings may become blocked. Use the heater on flat, dry surfaces only.
12. A heater has hot and arcing or sparking parts inside. Do not use heater in areas where gasoline, paint or flammable liquids are used or stored.
13. Never clean this heater while it is plugged in. Do not immerse in water.
14. This heater includes an overheating protection system that shuts off the heater when parts of the heater are getting excessively hot. If the heater shuts off,

immediately turn the heater OFF and inspect for any objects, on or adjacent to the heater, which may cause high temperatures. DO NOT OPERATE THE HEATER UNTIL IT IS RESET. To reset the heater, turn it OFF, unplug it from the electrical outlet, and wait five to ten minutes for the unit to cool down before plugging it back in and turning the heater on.

15. Always unplug heater when not in use.

16. Always plug heater directly into a wall outlet/receptacle. Never use with an extension cord or relocatable power tap (outlet/power strip).

17. It is normal for the heater's plug and cord to feel warm to the touch. A plug or cord which becomes hot to the touch or becomes distorted in shape may be a result of a worn electrical outlet. Worn outlets or receptacles should be replaced prior to further use of the heater. Plugging this heater into a worn outlet may result in overheating of the power cord or fire.

18. Make sure the plug is fully inserted into an appropriate receptacle. Be mindful that receptacles also deteriorate due to aging and continuous use. Check periodically for signs of overheating or deformations of the plug. If any overheating or deformation occurs, immediately discontinue using the heater

- 19. CHECK YOUR HEATER CORD AND PLUG CONNECTIONS.**  
Faulty wall outlet connections or loose plugs can cause the outlets or plug to overheat. During use, please check frequently to determine if your plug outlet or faceplate is HOT! If so, discontinue using the heater and/or have a qualified electrician to check and replace the faulty outlet(s).

**CAUTION:** This appliance is not intended for use by persons (including children) with reduced physical, sensory or mental capabilities, or lack of experience and knowledge, unless they have been given supervision or instruction concerning use of the appliance by a person responsible for their safety

## SAVE THESE INSTRUCTIONS

### Operating Instructions

1. Plug the power supply cord into a grounded wall outlet. (110/120VAC, 60Hz)..

**Important:** This heater comes with a grounded (3 prong) plug. The grounded plug must be used with a grounded outlet. Do not use an adapter in a 2-slot wall outlet unless the ground plug of the adapter properly connects to a building ground. Using heater without properly grounded outlet or adapter could result in an electric shock hazard.



- 2. TURNING THE HEATER ON:**  
To turn the heater ON, press the power button, the power LED light will turn on. Pressing the MODE button will allow you to set the heat settings: press once to set to AUTO, press twice to set to HIGH, press three times to set to LOW and press a fourth time to turn the heater OFF.

- 3. TURNING THE HEATER TO STANDBY:** To turn the heater to STANDBY, press the STANDBY button. The heater will shut off but the fan will continue to run until all the heat has been expelled. The heater will turn off automatically and is set to standby mode. If you are not going to use the heater for a long time. Press Power button to fully shut down the heater. The power LED will turn off.

- 4. SETTING THE THERMOSTAT**  
Press the MODE button, set to AUTO mode to engage the automatic thermostat.

- 5. SETTING THE TEMPERATURE**  
To set the desired temperature:

Press the  button once until the numeric temperature starts flashing.

Press the  button again to increase the temperature or the  button to decrease the temperature.

The desired temperature will set and execute after the LED display stops flashing and displays the room temperature again. This is your ideal setting. The heater will keep LOW heating output when room

temperature is 1 degree lower and 2 degrees higher than the set temperature in order to keep the space warm enough. The heater will turn OFF when the room temperature is 3 degrees higher than the set temperature, and will start automatically when the room temperature drops below 2 degrees than the set temperature.

For example: If your ideal setting is 72°F, the heater will keep LOW heating output in 71F to 74°F, and will turn OFF at 75°F.

The default temperature setting is preset from the factory at 70 degrees Fahrenheit.

6. For more efficient heating, please try placing the heater a few feet above the floor in rooms with large area. Make sure the heater is secure and won't fall.

### **Remote Controller**

#### **HOW TO INSERT BATTERIES**

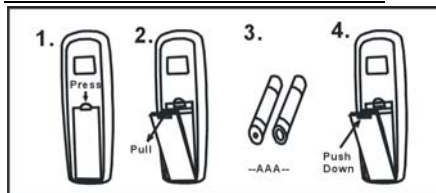

**NOTE:** Remove the batteries if the remote control is not to be used for a month or more. Batteries left in the unit may leak and cause damage.

“ DO NOT MIX OLD AND NEW BATTERIES”

“ DO NOT MIX ALKALINE, STANDARD (CARBON-ZINC) OR RECHARGEABLE (NICKEL-CADMIUM) BATTERIES.

### **Instructions for use of IR**

#### **Remote Control:**

The buttons of the remote control will

function in the same manner as the buttons on the control panel in front of the heater, you can set the timer by using the remote control:

To set the timer

1. Press the TIMER button until the Set Time starts flashing. The default value is 3 hours.
2. Press the “+” button to increase the set time or the “-“ button to decrease the set time.  
The timer can be set from 1 hour to 12 hours. The timer will set and execute after the LED display stops flashing. The heater will shut OFF automatically when the set time is reached.
3. To turn the timer OFF, follow step 1 and press the “-“ button to set the time to 0. The timer feature will turn off when the LED stops flashing

### **Maintenance**

1. Always turn OFF the heater and disconnect the cord from the electrical outlet before cleaning your heater.
2. Light accumulated dust may be removed from the heater with a soft cloth or vacuum cleaner.
3. Wipe the exterior surfaces of the heater occasionally with a damp cloth (not dripping wet), using a solution of mild detergent and water. Dry the case thoroughly before operating the heater.

Caution: Do not allow water to run into the interior of the heater as this could create a fire or electric shock hazard.

4. The fan motor is factory lubricated for life and will require no further lubrication.
5. Store heater in a clean dry place when not in use.

**Warning:** Any other servicing needed must be performed by an authorized service representative. Do not attempt to service the unit yourself.

### **Cleaning the electrostatic filter:**

The heater has an electrostatic filter located in the rear of the heater. The cleaning of the filter should be performed once per month or as needed (when dust is visible on the filter) to ensure efficient operations of the heater.

1. Power the heater off by pressing the "POWER" button located on the left side of the Control Panel.
2. Unplug the heater's power cord.
3. Release the filter by pushing filter up from below. ( Figure 1)
4. Remove the filter by pulling down and out. (Figure 2)
5. Clean filter by vacuuming filter clean.
6. Replace the filter by sliding the top upwards into the spring loaded slot on the back of the heater. (Figure2). Then gently push bottom of filter into place.(Figure 1).

### **Product Specifications**

**Model#:** 12H976

**Voltage:** 120V, 60Hz

**Current:** Maximum continuous draw: 13 amps;

**Output:** 5200 BTUs

**Power:** 1500 Watts

**Turbo Fan:** Multi blade; Low Noise



Figure 1



Figure 2

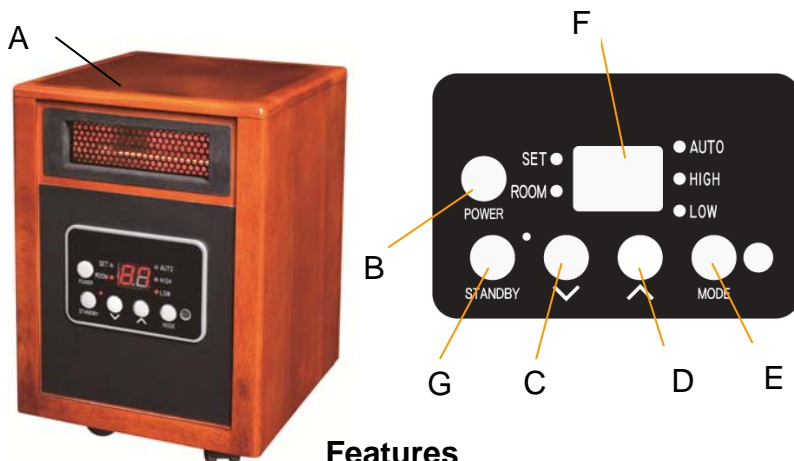

### Features

- |                                       |                                   |
|---------------------------------------|-----------------------------------|
| <b>A.</b> “Cool-Touch” cabinet        | <b>E. Mode</b> Buttons            |
| <b>B.</b> Power Button                | <b>F.</b> LED Temperature Display |
| <b>C.</b> Decrease temperature button | <b>G.</b> Standby ON/OFF button   |
| <b>D.</b> Increase temperature button |                                   |

### Special Features

- LED Display – When the unit is plugged in, the LED display will show the room temperature. At Auto mode it will display the set value 2 minutes after you set the desired temperature.
- Overheat Shut-Off Protection System -This heater includes a protection system that shuts off the heater if it overheats for any reason.
- Inlet Air Overheat Protection System – This heater will automatically shut off if the inlet air duct gets obstructed and causes the unit to overheat.
- Safety Tip-Over Switch – This Heater is designed to automatically shut-off when tipped in any direction. Place the heater on a flat, smooth and stable surface to prevent the heater from tipping over. When returned to normal upright position, heater is ready for use again. This is a safety feature to avoid the possibility of fire should the unit be accidentally tipped over.

Note: There may be a trace of smoke or odor when the unit is first operated. Do not be alarmed. This is a drop of oil that fell on the interior coils during the manufacturing process. It will quickly evaporate and should not re-occur.