

# EXP-80

REVISION: U  
ECO NO.: 2420  
BY: G. REEDER  
DATE: 5/23/07

# COXREELS SERIES SD

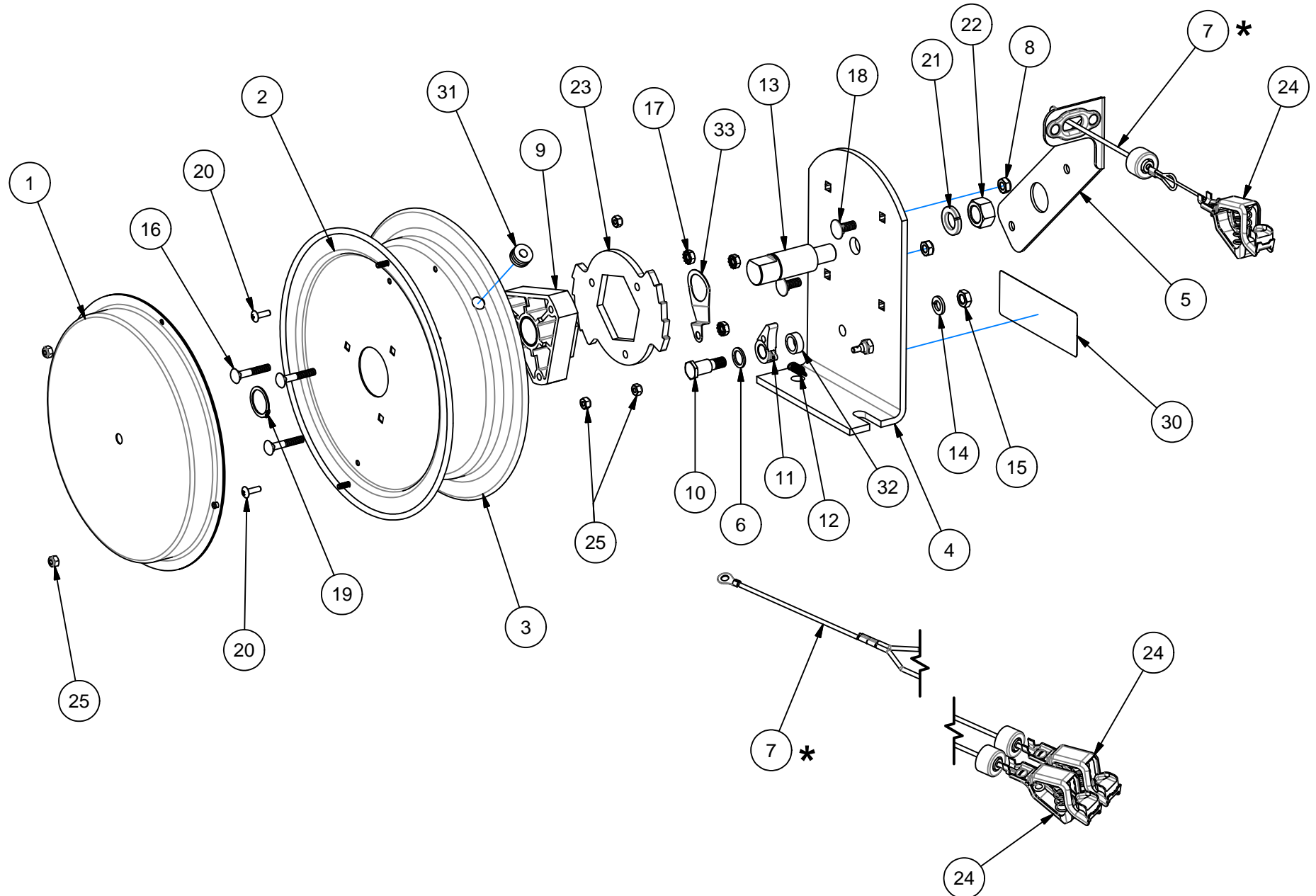

**COMMON PARTS TO ALL STATIC DISCHARGE REELS SD MODELS**

| ITEM NO. | PART     | DESCRIPTION                    | QTY |
|----------|----------|--------------------------------|-----|
| 6        | 6441-1   | WASHER, SPACER (050)           | 1   |
| 8        | 111-1    | NUT, NYLON INSERT, 5/16-18     | 2   |
| 9        | 1776-3   | ASSY., HUB BEARING             | 1   |
| 10       | 1620     | BOLT, 1/2" X 11/16"            | 1   |
| 11       | 640-1-BR | CAM, LOCKING, BRASS            | 1   |
| 12       | 274-1-SS | SPRING, DOG                    | 1   |
| 14       | 437      | WASHER, LOCK, 3/8"             | 1   |
| 15       | 184      | NUT, JAM, 3/8-16               | 1   |
| 16       | 1953     | CARRIAGE BOLT, 1/4-20 x 1-1/2  | 3   |
| 17       | 125      | NUT, KEPS, 1/4-20              | 3   |
| 18       | 10220-75 | BOLT, CARRIAGE, 5/16-18 X 3/4" | 2   |
| 19       | 206      | RETAINING RING (5100-100)      | 1   |
| 20       | 6341     | BOLT, 10-32 X 5/8"             | 2   |
| 21       | 438      | WASHER, LOCK, 5/8"             | 1   |
| 22       | 3584     | NUT, 5/8-11                    | 1   |
| 23       | 1924     | LOCKING RING                   | 1   |
| 25       | 7050     | NUT, LOCK, NYLON, 10-32        | 5   |
| 30       | 10925-5  | LABEL                          | 1   |
| 31       | 3879     | GROMMET                        | 1   |
| 32       | 6440-SS  | WASHER, SPACER (286)           | 1   |
| 33       | 1797-SS  | CONDUCTOR, GROUNDING           | 1   |

**ITEM NUMBER**

| MODEL       | 1       | 2    | 3    | 4      | 5      | 7              | 13     | 24       |
|-------------|---------|------|------|--------|--------|----------------|--------|----------|
|             | SPRING  | DISK | DISK | BASE   | ARM    | CABLE ASSY. *  | AXLE   | CLAMP    |
| SDL-35      | 7265-1  | 2201 | 2165 | 2130-2 | 8656   | -              | 2139   | -        |
| SDL-50      | 7265    | 2201 | 2165 | 2130-2 | 8656   | -              | 2139   | -        |
| SDL-75      | 7264-55 | 7230 | 7227 | 2130-1 | 8656-1 | -              | 2139-2 | -        |
| SDL-100     | 7264-55 | 7230 | 7227 | 2130-1 | 8656-1 | -              | 2139-2 | -        |
| SD-35       | 7265-1  | 2201 | 2165 | 2130-2 | 8656   | 2182-G-35      | 2139   | 2184     |
| SD-50       | 7265    | 2201 | 2165 | 2130-2 | 8656   | 2182-G-50      | 2139   | 2184     |
| SD-75       | 7264-55 | 7230 | 7227 | 2130-1 | 8656-1 | 2182-G-75      | 2139-2 | 2184     |
| SD-100      | 7264-55 | 7230 | 7227 | 2130-1 | 8656-1 | 2182-G-100     | 2139-2 | 2184     |
| SD-35-Y10   | 7265-1  | 2201 | 2165 | 2130-2 | 8656   | 2182-G-35-Y    | 2139   | 2184 (2) |
| SD-50-Y15   | 7264-55 | 7230 | 7227 | 2130-1 | 8656-1 | 2182-G-50-Y    | 2139-2 | 2184 (2) |
| SD-50-Y25   | 7264-55 | 7230 | 7227 | 2130-1 | 8656-1 | 2182-G-50-1-Y  | 2139-2 | 2184 (2) |
| SD-75-Y15   | 7264-55 | 7230 | 7227 | 2130-1 | 8656-1 | 2182-G-75-2-Y  | 2139-2 | 2184 (2) |
| SD-75-Y20   | 7264-55 | 7230 | 7227 | 2130-1 | 8656-1 | 2182-G-75-1-Y  | 2139-2 | 2184 (2) |
| SD-75-Y25   | 7264-55 | 7230 | 7227 | 2130-1 | 8656-1 | 2182-G-75-Y    | 2139-2 | 2184 (2) |
| SD-35-1     | 7265-1  | 2201 | 2165 | 2130-2 | 8656   | 2182-SS-35     | 2139   | 2184     |
| SD-50-1     | 7265    | 2201 | 2165 | 2130-2 | 8656   | 2182-SS-50     | 2139   | 2184     |
| SD-75-1     | 7264-55 | 7230 | 7227 | 2130-1 | 8656-1 | 2182-SS-75     | 2139-2 | 2184     |
| SD-100-1    | 7264-55 | 7230 | 7227 | 2130-1 | 8656-1 | 2182-SS-100    | 2139-2 | 2184     |
| SD-35-1-Y10 | 7265-1  | 2201 | 2165 | 2130-2 | 8656   | 2182-SS-35-Y   | 2139   | 2184 (2) |
| SD-50-1-Y15 | 7264-55 | 7230 | 7227 | 2130-1 | 8656-1 | 2182-SS-50-Y   | 2139-2 | 2184 (2) |
| SD-50-1-Y25 | 7264-55 | 7230 | 7227 | 2130-1 | 8656-1 | 2182-SS-50-1-Y | 2139-2 | 2184 (2) |
| SD-75-1-Y15 | 7264-55 | 7230 | 7227 | 2130-1 | 8656-1 | 2182-SS-75-2-Y | 2139-2 | 2184 (2) |
| SD-75-1-Y20 | 7264-55 | 7230 | 7227 | 2130-1 | 8656-1 | 2182-SS-75-1-Y | 2139-2 | 2184 (2) |
| SD-75-1-Y25 | 7264-55 | 7230 | 7227 | 2130-1 | 8656-1 | 2182-SS-75-Y   | 2139-2 | 2184 (2) |

\* CABLE ASSEMBLY SUPPLIED WITH BALL STOP AND COLLAR CLAMP.

REEL ASSEMBLY REPORTS:

- R100 LATCHOUT REMOVAL PROCEDURE
- R101 LOCKING RING PLACEMENT
- R112 TIGHTENING AND TORQUING