

Dayton Grinder Pumps

PUMPS technical data sheet



Submersible Grinder pumps are designed to remove raw sewage wastewater from residential or commercial applications. Grinder pumps macerate solids contained in normal sewage or waste into fine slurry that can be pumped through small diameter piping to a sewage collection / treatment system for final processing. Grinder pumps can lift sewage to high elevations for pressure sewer applications.



**11A342
2 HP, Stainless Steel
Submersible Grinder Pump**

HP	2
Voltage	230V
Phase	Single
Frequency	60 Hz
Run Amps	11A
Start Amps	35A
RPM	3450
Motor Type	Cap Start / Cap Run Oil-filled with Class B insulation

Overload Protection	Internal Thermal Overload
Motor Shaft Material	410 Stainless Steel
Motor Housing Material	Cast Iron and 304 Stainless Steel
Motor Duty	Continuous
Motor End Bearing	Single Row Ball
Pump End Bearing	Single Row Ball
Lubrication	Oil Lubricated
Discharge	1-1/4 Inch FNPT, Flanged, Vertical
Volute Material	Cast Iron
Base Material	Cast Iron
Impeller Type	Open Vortex
Impeller Material	Ductile Iron
Hardware Material	Stainless Steel
Cutter and Ring	HRC 58 Chrome Steel
O-rings	Buna-N
Seal Type	Dual Mechanical
Seal Materials	Carbon Ceramic/ Buna-N Silicon Carbide/Silicon Carbide Buna-N
Operation	Manual
Power Cord	14/3 SJTW, 15' (4.6m), Stripped Leads
Max. Solids Handling	1/8" (0.32cm) spherical
Max. Water Temperature	104°F (40°C)
Designed Fluid Environment	Water / Sewage Wastewater

Outline Dimensions

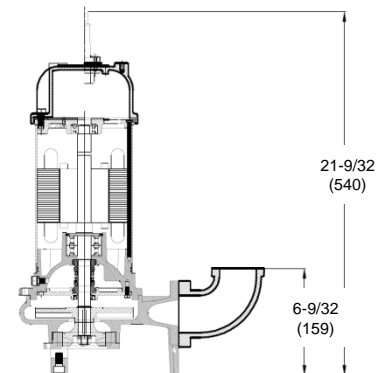
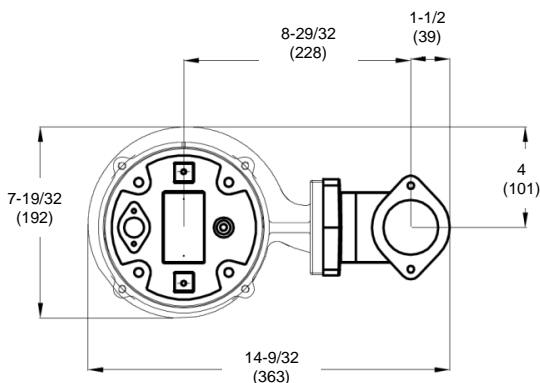

Performance Data

Head	Feet	5	15	25	30	40	50	60	70	82
	Meters	1.5	4.6	7.6	9.1	12.2	15.2	18.3	21.3	25.0
Flow Rate	GPM	50	50	46.5	41	38.3	30	20	10	0
	LPM	189	189	176	155	145	114	76	38	0

Performance Chart

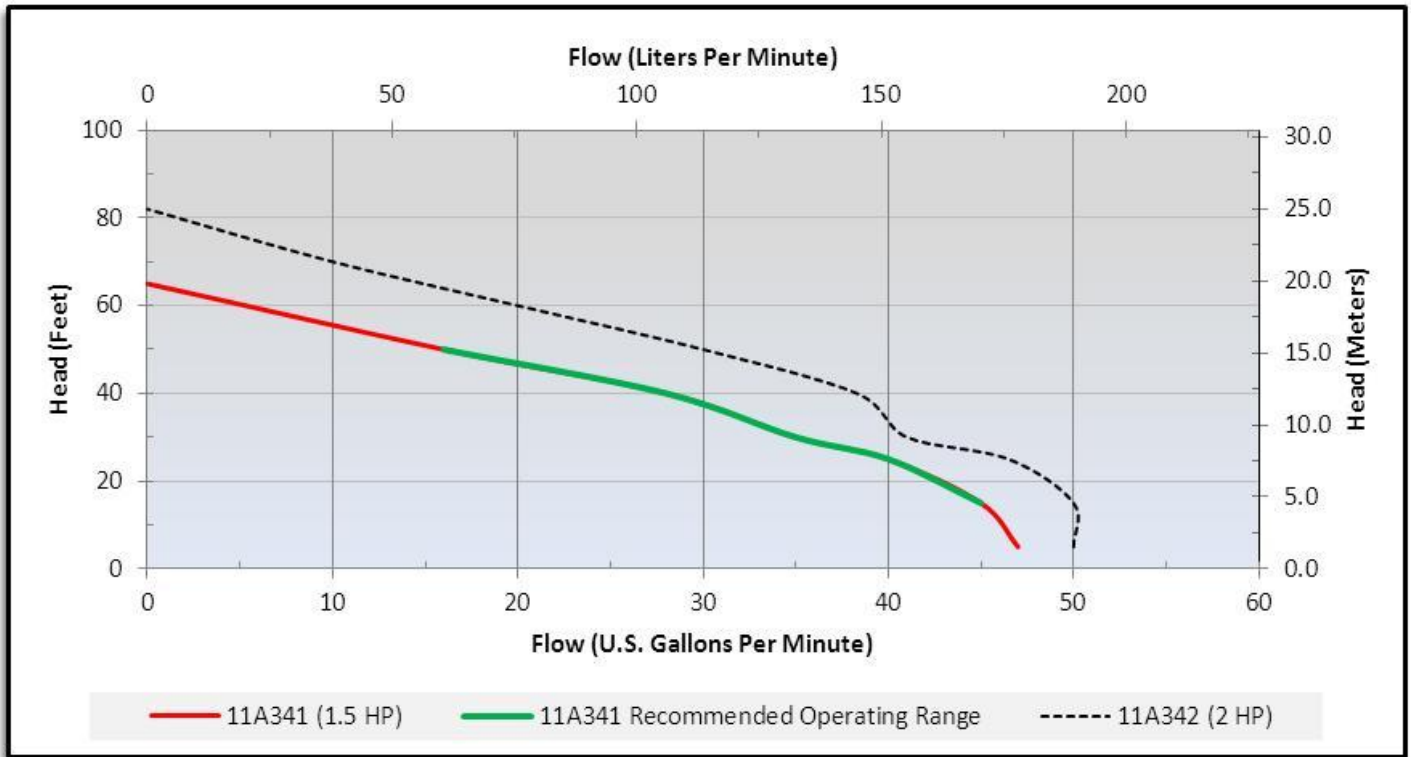

WARNING: Use only with nonflammable liquids compatible with pump component materials and in nonflammable/nonexplosive atmospheres.

Call or visit your local branch or go to grainger.com/dayton for complete product line information

Find it at Grainger.

© 2013 W.W. Grainger, Inc.

